



MILES ESTATE AGENTS

**Cherry Orchard Coach House Trull
Taunton TA3 7LF £475,000**



Originally the Apple Store for the main house, Cherry Orchard Coach House is a delightful and individual 4 bedroom detached property tucked away just off the centre of the sought after Village of Trull. The property offers flexible accommodation with a ground floor bedroom and bathroom, together with 2 reception rooms and a kitchen overlooking a private partly walled garden to the rear. On the first floor there are 3 further bedrooms and a shower room. There is parking for several cars, a garage and a generous side and front garden. Early viewing recommended. Freehold. Council Tax Band D. EPC: C.





Features:

- Pretty individual detached property
- Tucked away in private location
- Dating back to the 1800's
- Flexible accommodation
- 2 reception rooms
- Kitchen
- Ground floor bedroom & bathroom
- 3 first floor bedrooms & shower room
- Partially walled rear garden
- Garage & Ample Parking
- Generous gardens to the front & side
- Village location



GARAGE
15.8 sq.m. (170 sq.ft.) approx.

GROUND FLOOR
71.0 sq.m. (760 sq.ft.) approx.

1ST FLOOR
41.8 sq.m. (450 sq.ft.) approx.

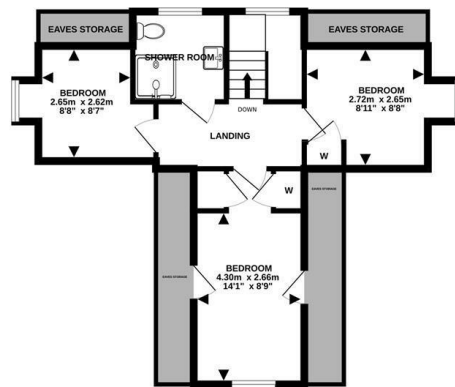
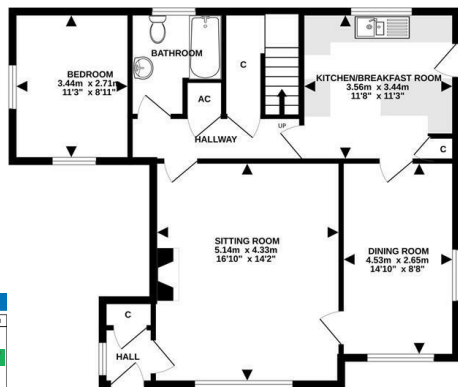
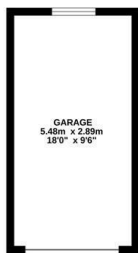

Energy Efficiency Rating		
	Current	Potential
Very energy efficient - lower running costs		
(92 plus) A		87
(81-91) B		
(69-80) C		69
(55-68) D		
(39-54) E		F
(21-38) F		
(1-20) G		G
Not energy efficient - higher running costs		
England & Wales		EU Directive 2002/91/EC

TOTAL FLOOR AREA : 128.7 sq.m. (1385 sq.ft.) approx.
Made with Metropix ©2023



Viewings strictly through the selling agents:

Miles Estate Agents

2 Piffin Lane, Bishops Lydeard, Taunton,
Somerset, TA4 3AS

Tel: 01823 470 500

lydeard@milesestateagents.co.uk

www.milesestateagents.co.uk



rightmove

OnTheMarket.com

MILES ESTATE AGENTS