

Luxury+Prestige

SHOW HOME AT RIVERS EDGE

JULIANS ROAD, WIMBORNE, BH21 1EF

















TAKE A STEP INSIDE



Simply click on the thumbnail above to let one of our team give you a guided tour of the highlights.

If you are longing for a more in-depth explore at your own pace, then head across the page to our fully interactive 3D tour.

vimeo

Can't wait to view in person?

All of our properties feature a professionally produced one minute video, personally introduced by a member of our team as well as a fully interactive 3D tour.

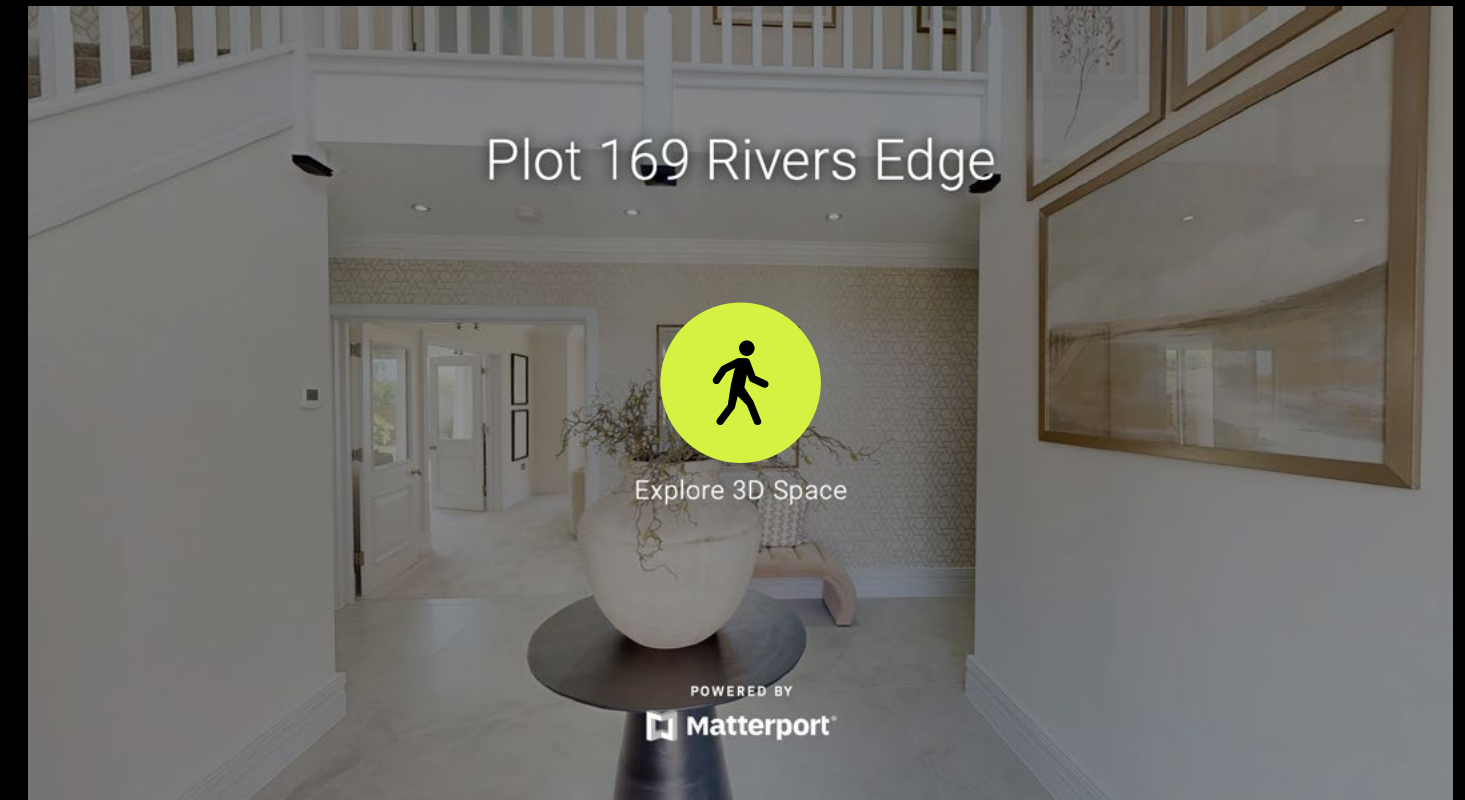

Simply click on the thumbnail above to take a step inside and explore this beautiful home.

This fully immersive experience allows you to 'click and drag' your way through the property at your own pace. It is best viewed on a desktop screen or in landscape mode on your smartphone or tablet.

Matterport

Floorplan

Plot 169

GROSS INTERNAL AREA

House:
Total: 3,074 sq. ft / 286m²

Sizes and dimensions are approximate, actual may vary.

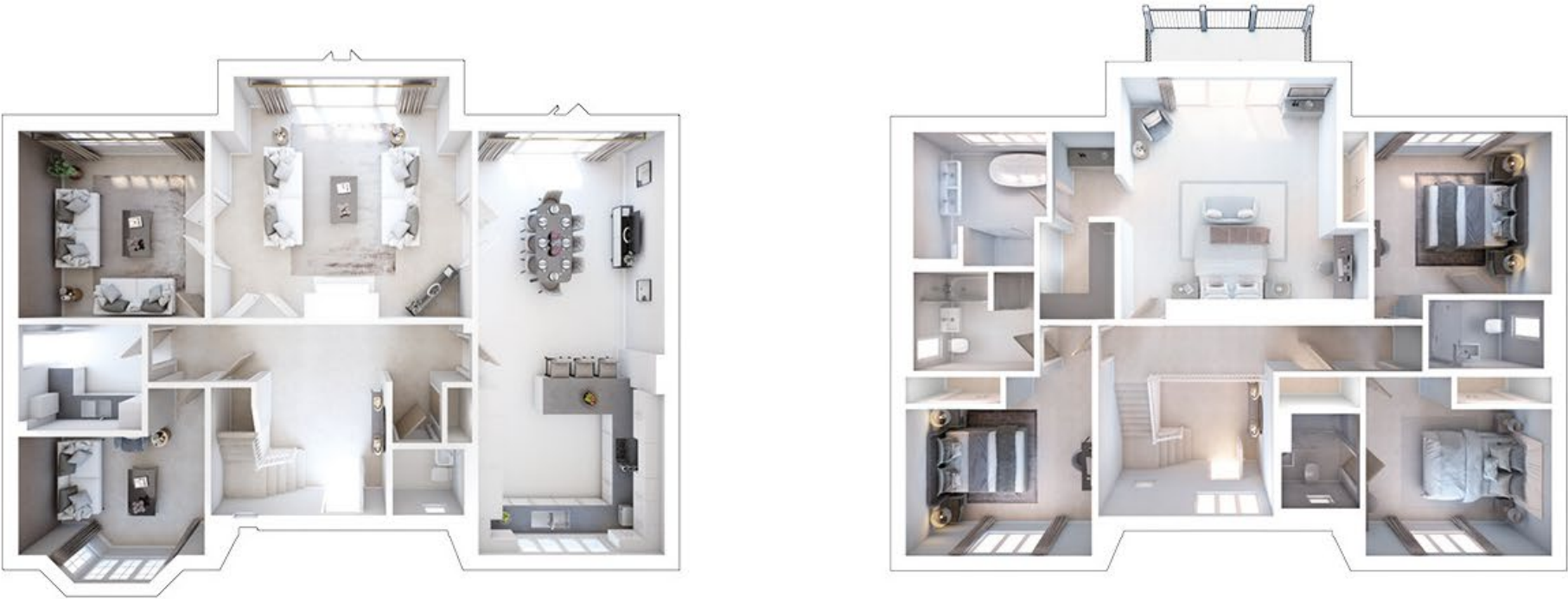

Ground Floor

Kitchen	4.24m x 5.36m	13'11" x 17'7"
Lounge Area	4.24m x 4.25m	13'11" x 13'11"
Dining Room	4.24m x 4.28m	13'11" x 14'1"
Living Room	5.93m x 5.49m	19'5" x 18'0"
Study/Snug	4.24m x 3.32m	13'11" x 10'11"

First Floor

Main Bedroom	5.04m x 4.91m	16'5" x 16'10"
Bedroom 2	4.04m x 3.65m	13'3" x 12'0"
Bedroom 3	4.23m x 4.06m	13'11" x 13'4"
Bedroom 4	4.23m x 4.06m	13'11" x 13'4"

Summary

This stunning brand new show home has an imposing and elegant facade and is part of the final phase of luxury homes at Rivers Edge.

The accommodation is laid out over two floors comprising four bedrooms, four bathrooms, kitchen / dining room and two separate living room, plus a study. Features include an especially luxurious principal bedroom suite with separate dressing and a private sun balcony with views over the river.

This forms part of the final release of this unique and highly regarded development and this exclusive collection of houses feature an especially enhanced specification meaning that the hugely inspiring location and beautiful architecture will be perfectly complemented by highly specified interiors. The kitchens and bathrooms will be supplied by renowned Dream Design. The shaker style kitchens include quartz worktops and integrated appliances by Miele and the bathrooms feature Corian basins, taps by Hansgrohe and sanitaryware by Villeroy & Boch amongst others.

Details

Guide Price:	£1,995,000
Tenure:	Freehold
Lease Length:	N/A
Maintenance:	Refer to developer for more details
Ground Rent:	N/A* * Ground Rents can increase over time and advice should always be sought from your solicitor before exchange of contracts.
Stamp Duty:	Main Home £153,150** Additional Home £252,900** ** based on guide price, correct as at 22.05.25
Local Authority:	Dorset (East)
Council Tax:	Band TBC 2024/2025 £x,xxx.xx pa*** *** Amount shown is for a main home, please seek advice for additional home.
Services:	Mains gas, electricity, water and drainage

Key features

- + **Stunning brand new show homes**
- + **Highly prestigious development**
- + **Extremely high specification**
- + **Beautifully presented throughout**
- + **Short walk to town centre**
- + **Close to the River Stour**
- + **By one of the area's most renowned developers**
- + **Contemporary interior**
- + **Incentives available for an early sale**
- + **Available to view now!**

Our team



Steve Isaacs
Director

07970 878106
steve@luxuryandprestige.com



David Chissell
Director

07795 835647
david@luxuryandprestige.com



Harriet Towning
Head of Sales

07809 908718
harriet@luxuryandprestige.com



Adrianna Ciereszko
Photographer

01202 007373
adrianna@luxuryandprestige.com



Ryan Horan
Land & New Homes

07512 196688
ryan@luxuryandprestige.com



Thomas Powner
Residential Sales

07437 491094
tom@luxuryandprestige.com



Asia Roberston
Social Media Manager

07484 719645
asia@luxuryandprestige.com



Valentina Morana
Residential Sales

01202 007373
valentina@luxuryandprestige.com



Joanne Bound
Search Agent

01202 007373
jbound@luxuryandprestige.com

Get in touch

In person:	28A Haven Road Canford Cliffs Poole BH13 7LP
By phone:	01202 007373
By email:	info@luxuryandprestige.com
Online:	luxuryandprestige.com
Facebook:	facebook.com/luxuryandprestige
Instagram:	@luxuryprestigerealty
Property ref:	0800
Published:	May 2025



Important notice
Luxury and Prestige Realty Ltd, its clients and any joint agents give notice that 1: They are not authorised to make or give any representations or warranties in relation to the property either here or elsewhere, either on their own behalf or on behalf of their client otherwise. They assume no responsibility for any statement that may be made in these particulars. These particulars do not form part of any offer or contract and must not be relied upon as statements or representations of fact. 2: Any areas, measurements or distances are approximate. The text, photographs and plans are for guidance only and are not necessarily comprehensive. It should not be assumed that the property has all necessary planning, building regulation or other consents and Luxury and Prestige have not tested any services, equipment or facilities. Purchasers must satisfy themselves by inspection or otherwise.

Luxury+Prestige

luxuryandprestige.com