



43A ST. MARTINS ROAD

COVENTRY, CV3 6FE

- GENEROUS CORNER PLOT
- PRESTIGIOUS LOCATION
- EXCELLENT LOCAL SCHOOLING
- EASY COMMUTER ACCESS
- 4 DOUBLE BEDROOMS
- REAR KITCHEN/DINER
- LARGE GARAGE
- FURTHER POTENTIAL IF REQUIRED
- EPC RATING E

THE PROPERTY





THE LOCATION

THE FLOORPLAN

Ground Floor

Approx. 104.5 sq. metres (1124.8 sq. feet)



First Floor

Approx. 63.6 sq. metres (684.3 sq. feet)

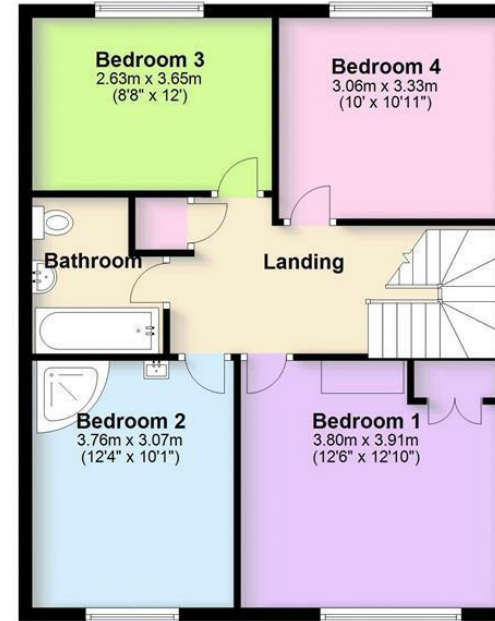

01926 298 298
kenilworth@elizabethdavenport.co.uk

Elizabeth Davenport Estate Agents
99 Warwick Road, Kenilworth, Warwickshire, CV8 1HP

