

# JAMES EDWARD

Comprehensively Cared For



Douro Street

, London, E3 2TS

£2,450 Per Month



# Douro Street



## Description

Charming two bedroom ground floor maisonette, newly refurbished with private garden. Ideally located on a quiet, family orientated residential road.

With vibrant Hackney Wick, Victoria and Mile End Parks and amazing bars and restaurants just a short walk away you'll be spoilt for choice on how to spend your free time.

Getting into town is easy with Bow Road Underground Station and Bow Church DLR just down the road.

Furnishing negotiable.

Available early February

- 10 Minute Walk to Bow Road Station
- Close Proximity to Victoria Park
- Available Early Feb
- Fully Furnished
- Private Garden







Floor Plan

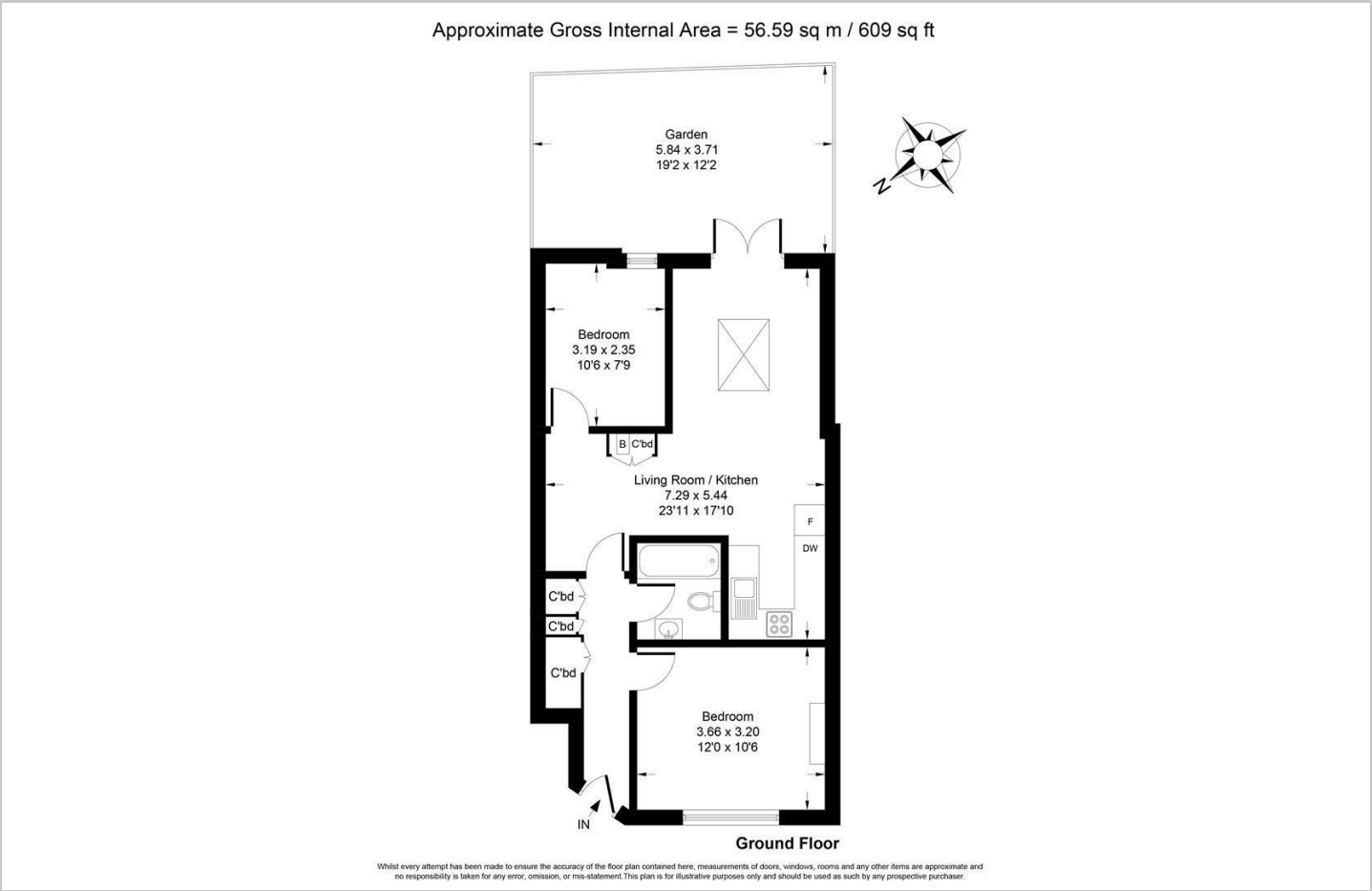

Area Map

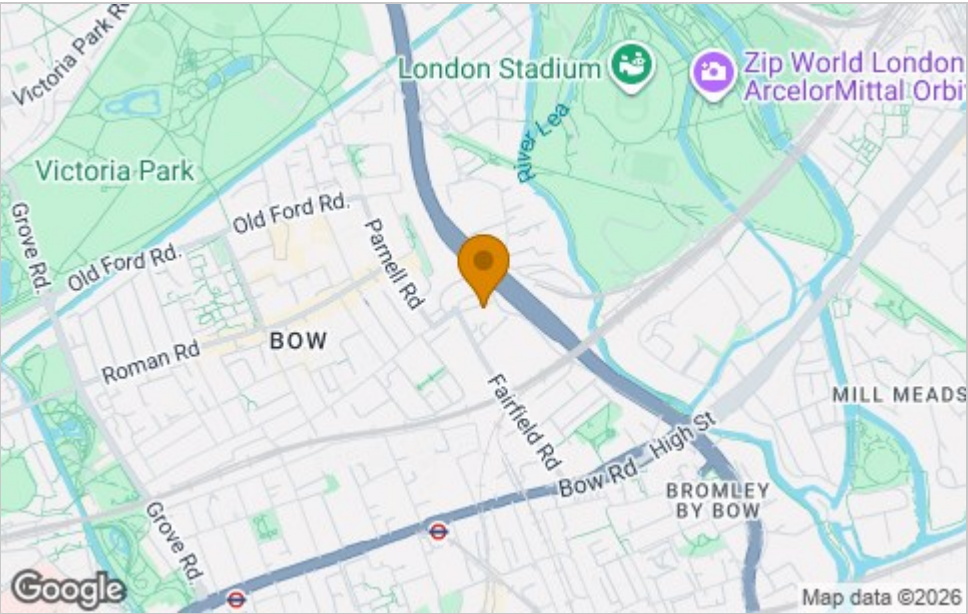

Viewing

Please contact our James Edward Office on 020 7952 5197 if you wish to arrange a viewing appointment for this property or require further information.

Energy Efficiency Graph

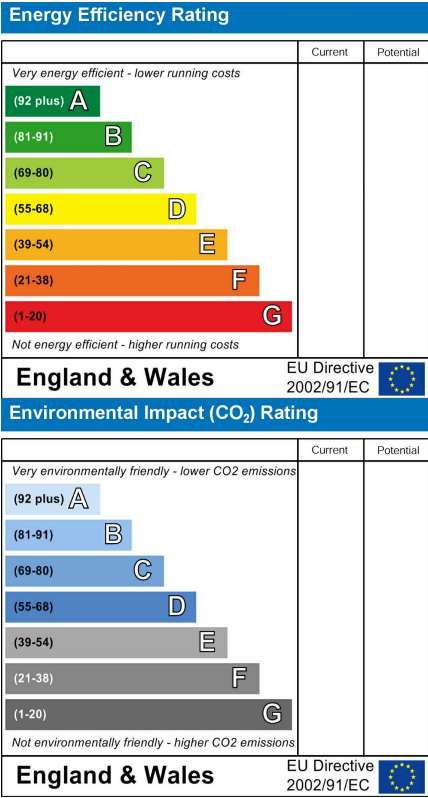

These particulars, whilst believed to be accurate are set out as a general outline only for guidance and do not constitute any part of an offer or contract. Intending purchasers should not rely on them as statements of representation of fact, but must satisfy themselves by inspection or otherwise as to their accuracy. No person in this firms employment has the authority to make or give any representation or warranty in respect of the property.