

JAMES EDWARD

Comprehensively Cared For

Rathcoole Avenue

, London, N8 9LY

Offers In Excess Of £690,000



Rathcoole Avenue



Description

Charming period conversion, offering three bedrooms, private garden and a prime position walking distance to Crouch End Village and Hornsey Station.

- Three Bedrooms
- Private Garden
- Period Conversion
- Short Walk to Crouch End Village
- Chain Free
- Close to Hornsey Station
- 719 sq ft
- Leasehold
- Tranquil Tree Lined Street





Floor Plan

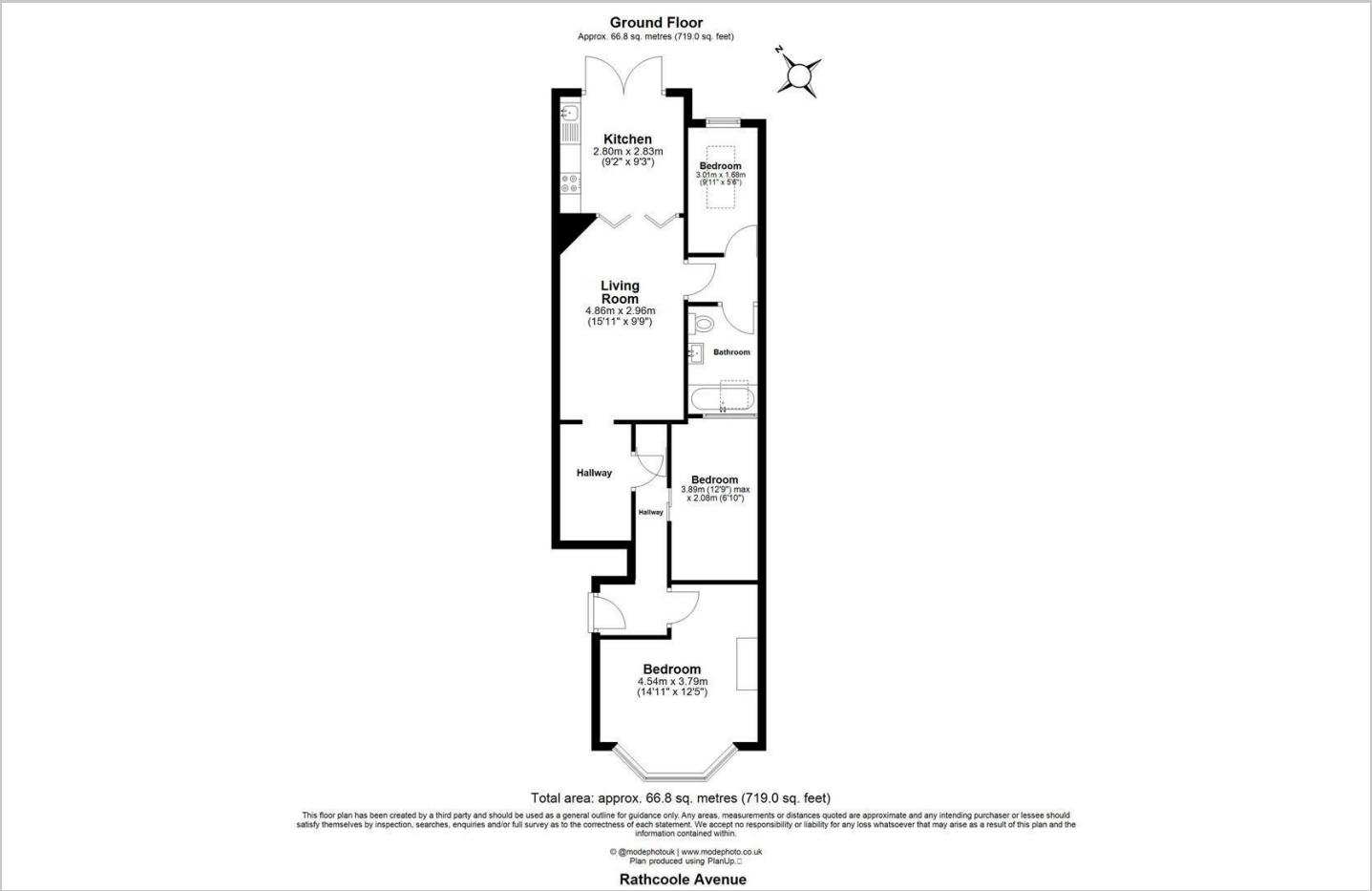

Area Map

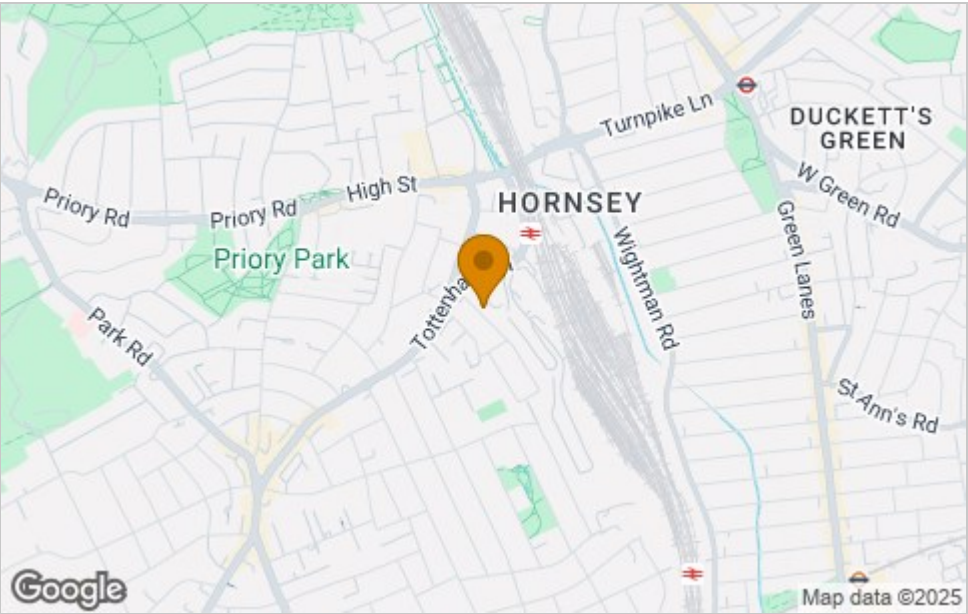

Viewing

Please contact our James Edward Office on 020 7952 5197 if you wish to arrange a viewing appointment for this property or require further information.

Energy Efficiency Graph

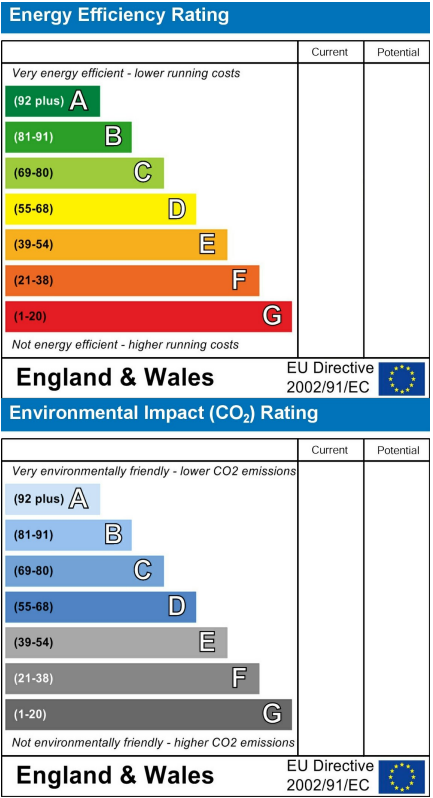

These particulars, whilst believed to be accurate are set out as a general outline only for guidance and do not constitute any part of an offer or contract. Intending purchasers should not rely on them as statements of representation of fact, but must satisfy themselves by inspection or otherwise as to their accuracy. No person in this firms employment has the authority to make or give any representation or warranty in respect of the property.