

JAMES EDWARD

Comprehensively Cared For

Highbury New Park

London, N5 2EU

Guide Price £750,000



2



1



1



C

Highbury New Park



Description

A beautiful light-filled two bedroom first floor flat forming part of this detached Georgian villa backing onto the peaceful and leafy Aberdeen Park conservation area.

- Two Bedrooms
- Beautifully Bright
- Large Reception Room
- Lease Being Extended
- Peaceful Leafy Street
- EPC Rating - C
- Green Views
- Plentiful Storage
- Wonderful Location
- Close to Amenities





Floor Plan

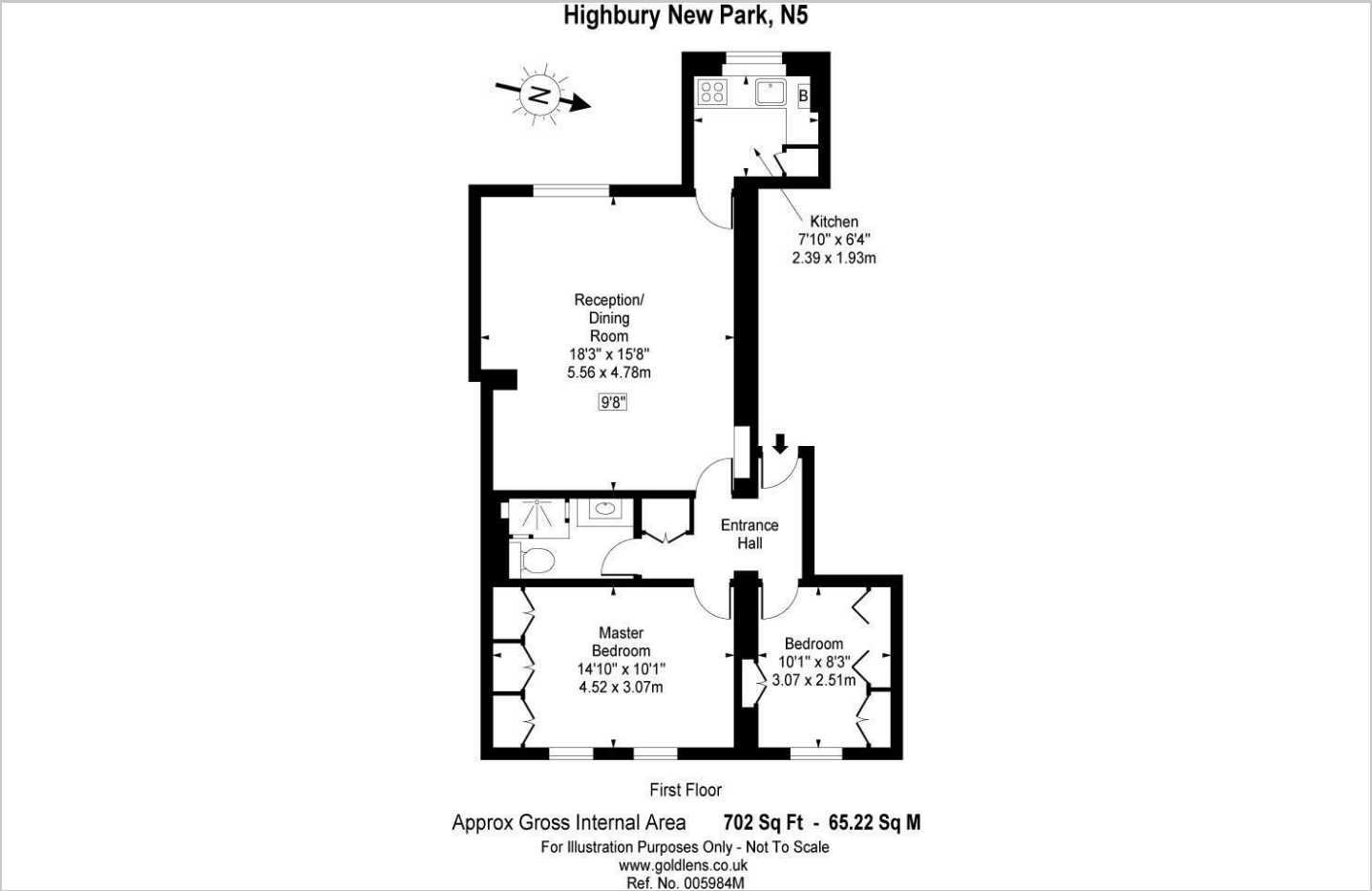

Area Map

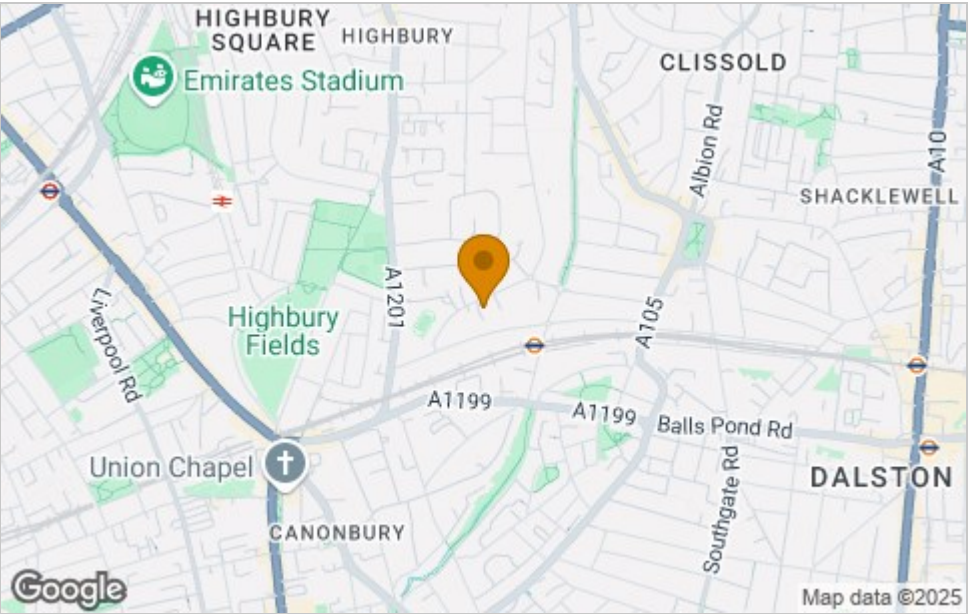

Viewing

Please contact our James Edward Office on 020 7952 5197 if you wish to arrange a viewing appointment for this property or require further information.

Energy Efficiency Graph

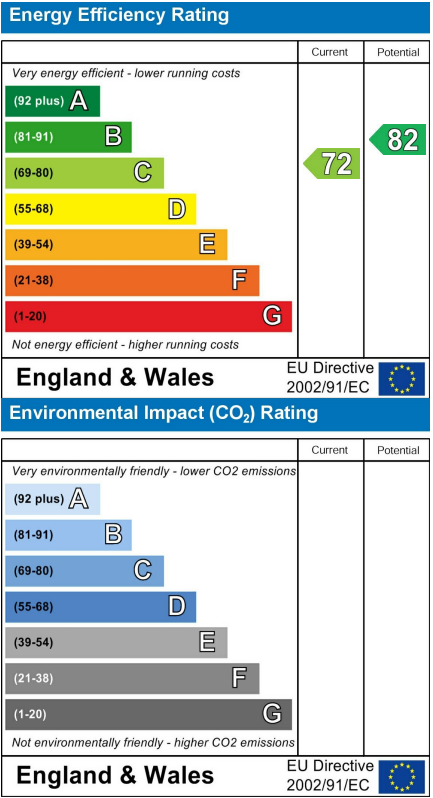

These particulars, whilst believed to be accurate are set out as a general outline only for guidance and do not constitute any part of an offer or contract. Intending purchasers should not rely on them as statements of representation of fact, but must satisfy themselves by inspection or otherwise as to their accuracy. No person in this firms employment has the authority to make or give any representation or warranty in respect of the property.