

# JAMES EDWARD

Comprehensively Cared For



Highbury Park  
, London, N5 1GF

£4,800 Per Month





## Highbury Park

, London, N5 1GF

An impressive and rarely available three double bedroom, two bathroom split level apartment located in prime position within this highly sought-after development located a stone's-throw away from Highbury Barn, excellent transport links, parks and schools.

### Main Description







Floor Plan

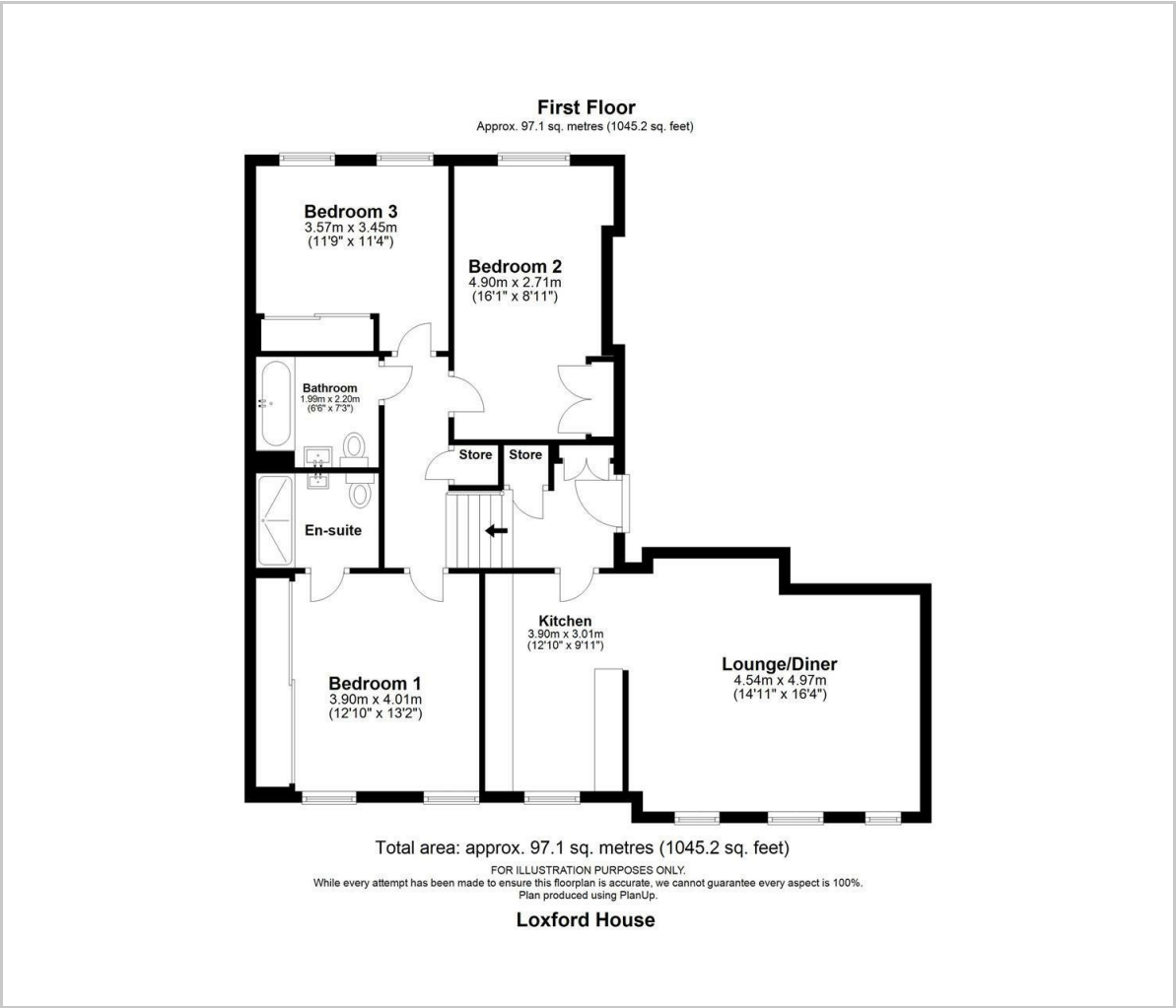

Viewing

Please contact our James Edward Office on 020 7952 5197 if you wish to arrange a viewing appointment for this property or require further information.

Area Map

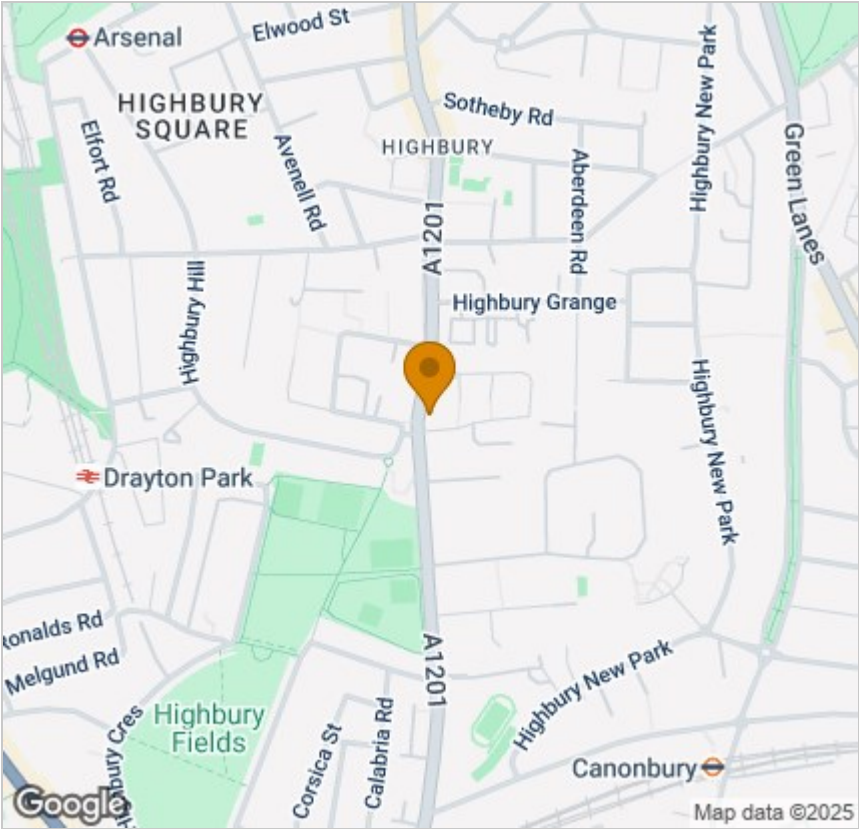

Energy Efficiency Graph

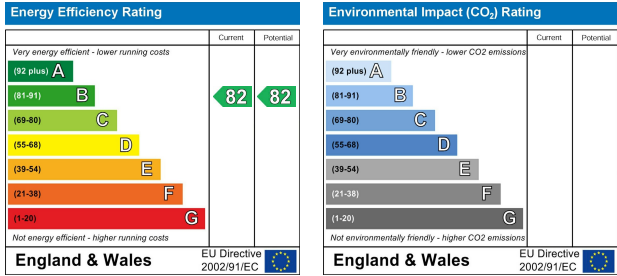

These particulars, whilst believed to be accurate are set out as a general outline only for guidance and do not constitute any part of an offer or contract. Intending purchasers should not rely on them as statements of representation of fact, but must satisfy themselves by inspection or otherwise as to their accuracy. No person in this firms employment has the authority to make or give any representation or warranty in respect of the property.

100 Highbury Park, London, N5 2XE  
Tel: 020 7952 5197 Email: [info@jamesedwardproperties.co.uk](mailto:info@jamesedwardproperties.co.uk) <https://www.jamesedwardproperties.co.uk>