

# JAMES EDWARD

Comprehensively Cared For

Goodwin Street

, London, N4 3HQ

£775,000



2



3



1



B



# Goodwin Street



## Description

A fabulous two double bedroom, two bathroom split-level apartment (1034 sq ft) with wrap-around balconies and cracking views located above one of the most convenient transport hubs in North London.

- Split-Level Apartment 1034 sq ft
- Tireless Views
- Two Bathrooms
- Incredible Transport Links
- Endless Amenities
- Wrap-Around Balcony
- Two Double Bedrooms
- Additional w/c
- Park on the Doorstep
- Communal Sky Gardens







# Floor Plan

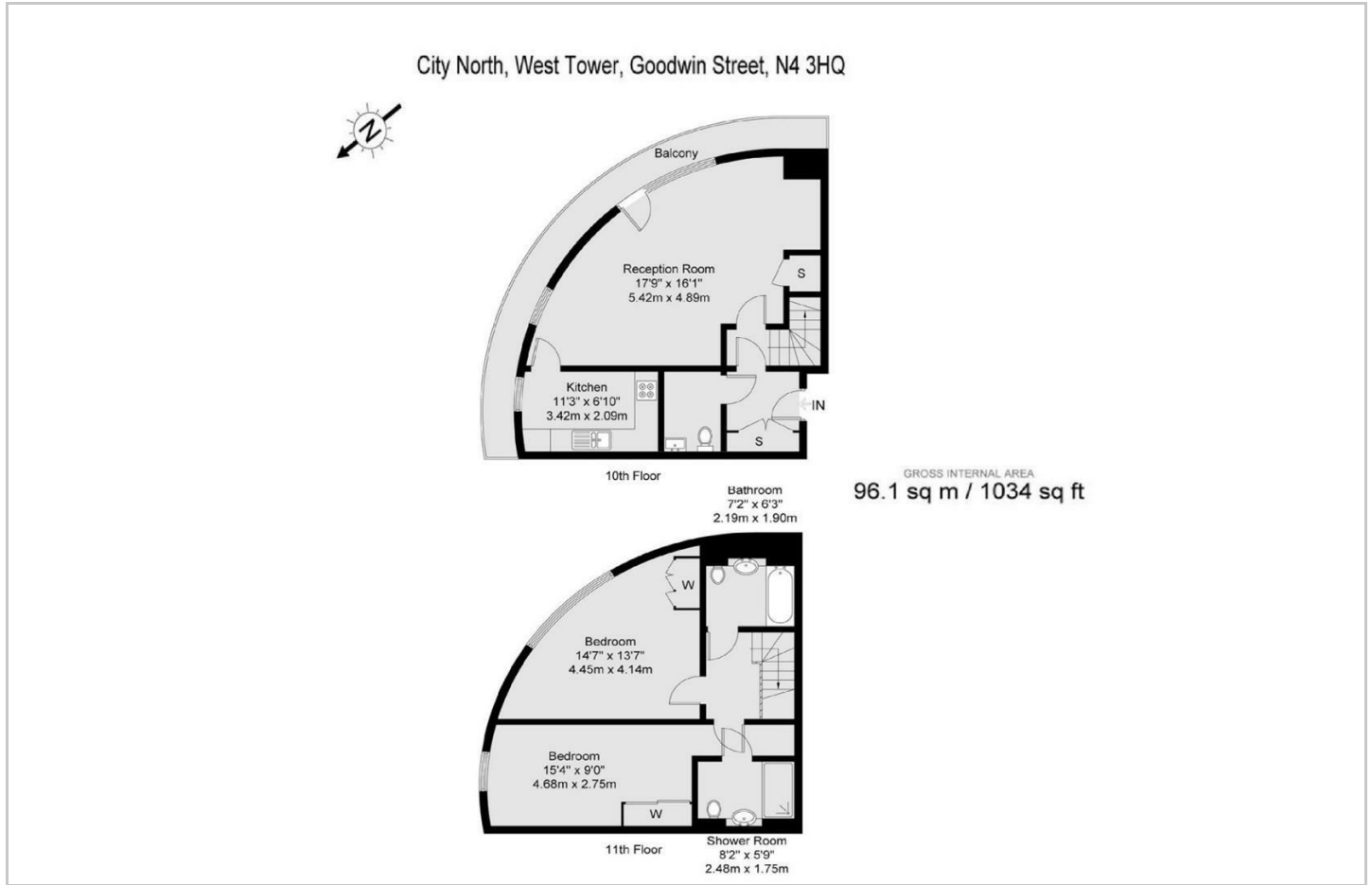

# Area Map

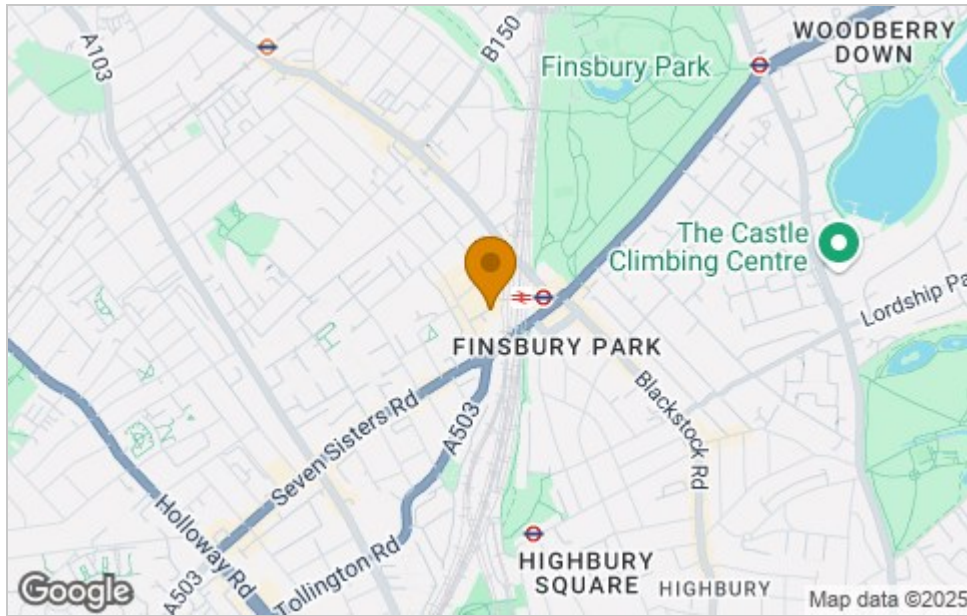

# Viewing

Please contact our James Edward Office on 020 7952 5197 if you wish to arrange a viewing appointment for this property or require further information.

# Energy Efficiency Graph

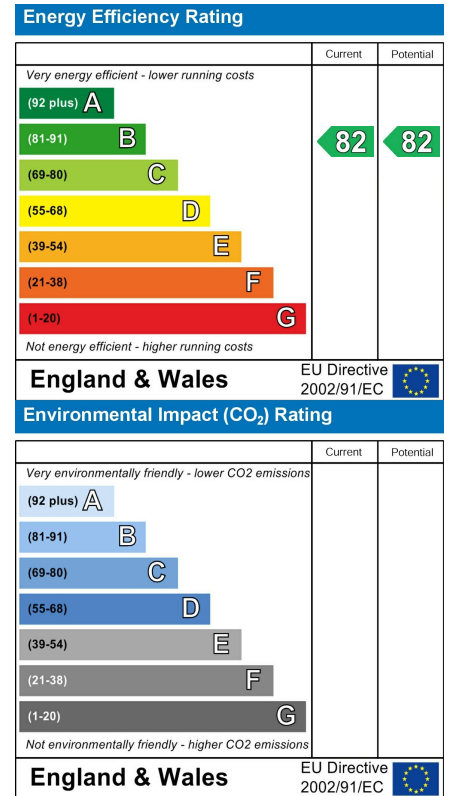

These particulars, whilst believed to be accurate are set out as a general outline only for guidance and do not constitute any part of an offer or contract. Intending purchasers should not rely on them as statements of representation of fact, but must satisfy themselves by inspection or otherwise as to their accuracy. No person in this firm's employment has the authority to make or give any representation or warranty in respect of the property.

100 Highbury Park, London, N5 2XE

Tel: 020 7952 5197 Email: [info@jamesedwardproperties.co.uk](mailto:info@jamesedwardproperties.co.uk) <https://www.jamesedwardproperties.co.uk>