

JAMES EDWARD

Comprehensively Cared For



Stradbroke Road

, London, N5 2PZ

£1,850,000



Stradbroke Road



Description

Impressive five bedroom Victorian House, set in a desirable tree lined residential street in Prime Highbury, just a short stroll from Highbury Barn, Clissold Park and Canonbury Station.

- Victorian House
- Close to Canonbury Station
- Five Bedrooms
- Open Plan Kitchen/Diner
- 1900 sq ft
- Quiet Location
- Close to Clissold Park
- Arranged Over Three Floors
- Close to Highbury Barn





Floor Plan

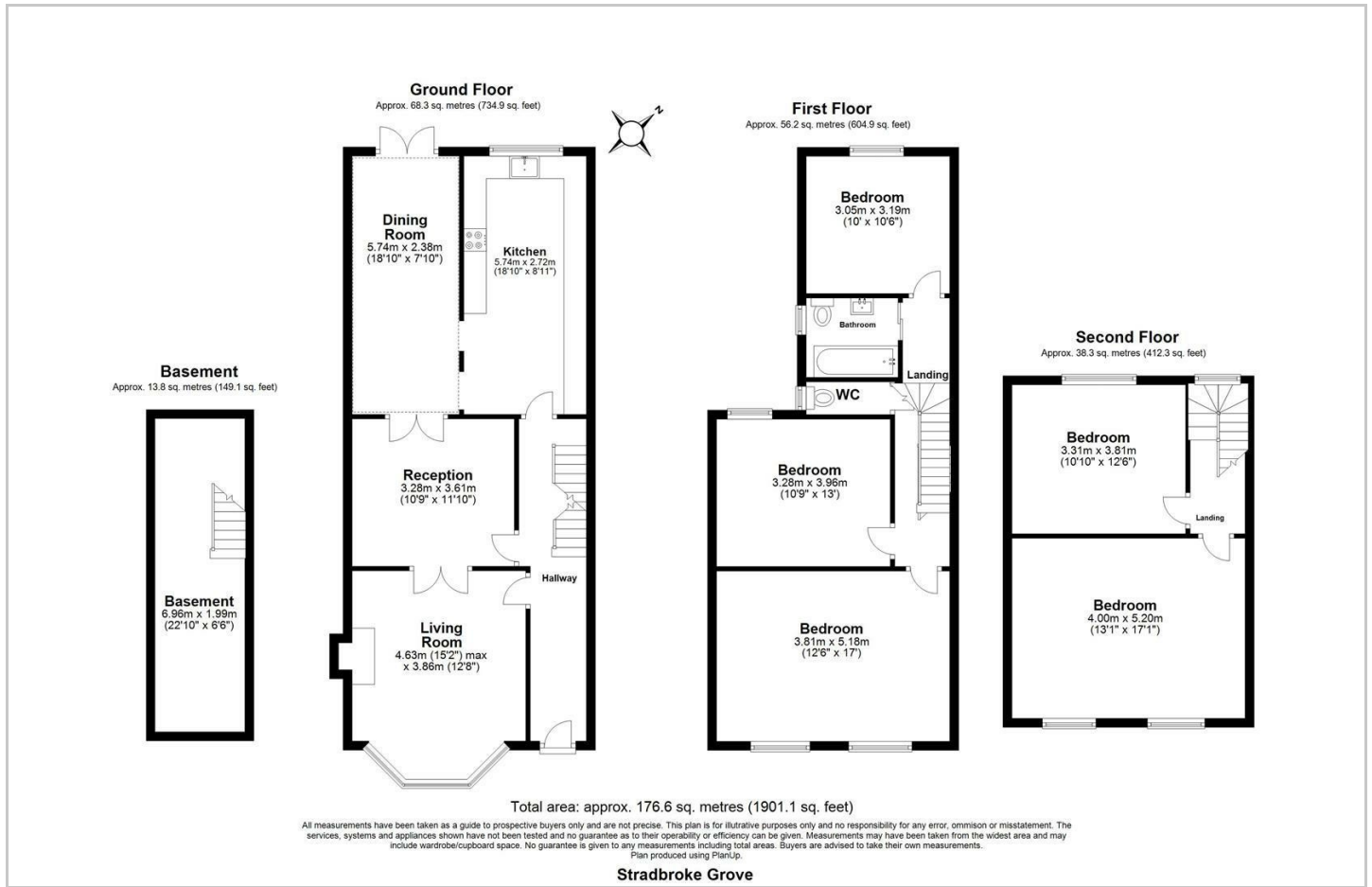

Area Map

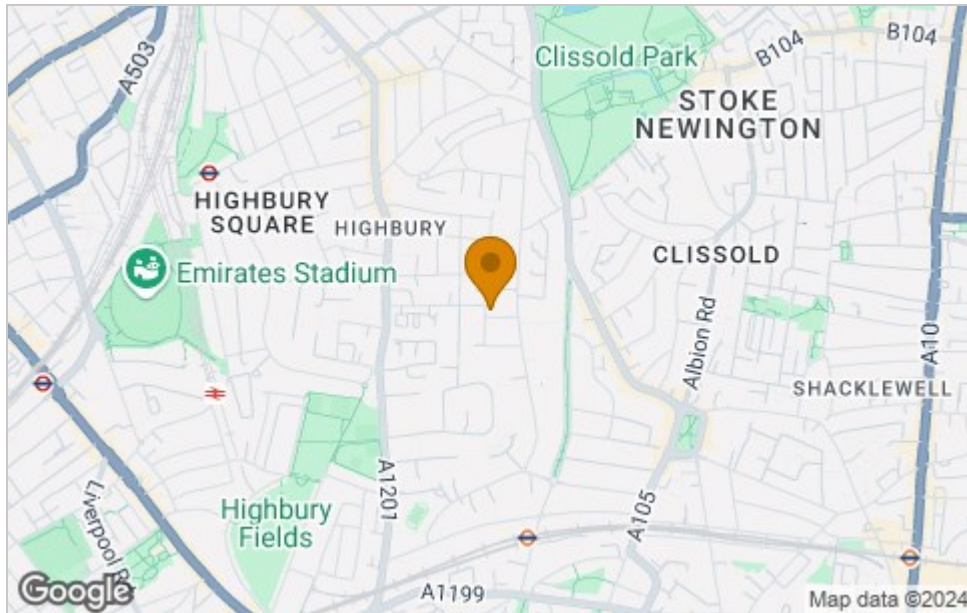

Viewing

Please contact our James Edward Office on 020 7952 5197 if you wish to arrange a viewing appointment for this property or require further information.

Energy Efficiency Graph

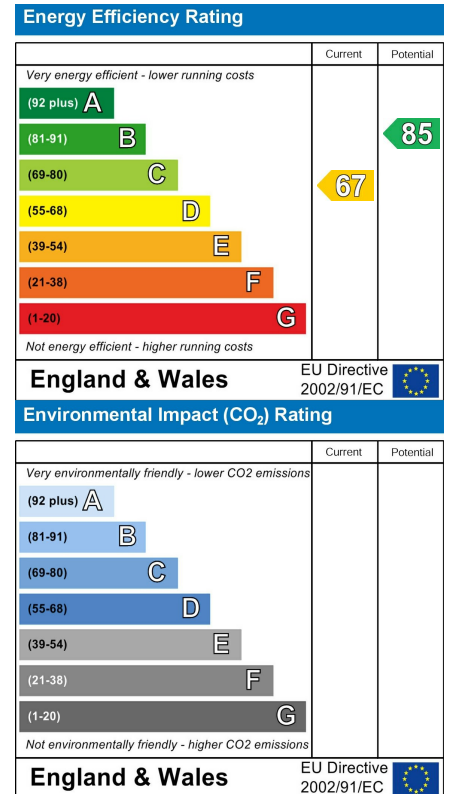

These particulars, whilst believed to be accurate are set out as a general outline only for guidance and do not constitute any part of an offer or contract. Intending purchasers should not rely on them as statements of representation of fact, but must satisfy themselves by inspection or otherwise as to their accuracy. No person in this firm's employment has the authority to make or give any representation or warranty in respect of the property.

100 Highbury Park, London, N5 2XE

Tel: 020 7952 5197 Email: info@jamesedwardproperties.co.uk <https://www.jamesedwardproperties.co.uk>