

JAMES EDWARD

Comprehensively Cared For



Sotheby Road

, London, N5 2UT

£3,500 Per Month

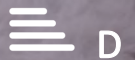

Sotheby Road



Description

A delightful and newly refurbished three double bedroom (with additional office/games room) period conversion arranged over three floors tucked away in this desirable location close to Highbury Barn, popular parks and Highbury & Islington and Arsenal tube stations.

- Close to Clissold Park
- Generously Proportioned
- Newly Re-Decorated Throughout
- Sought After Location
- Three Double Bedrooms
- Flexible Furnishing
- Located Behind Highbury Barn
- Period Conversion
- Suitable For Sharers
- Very High Spec





Floor Plan

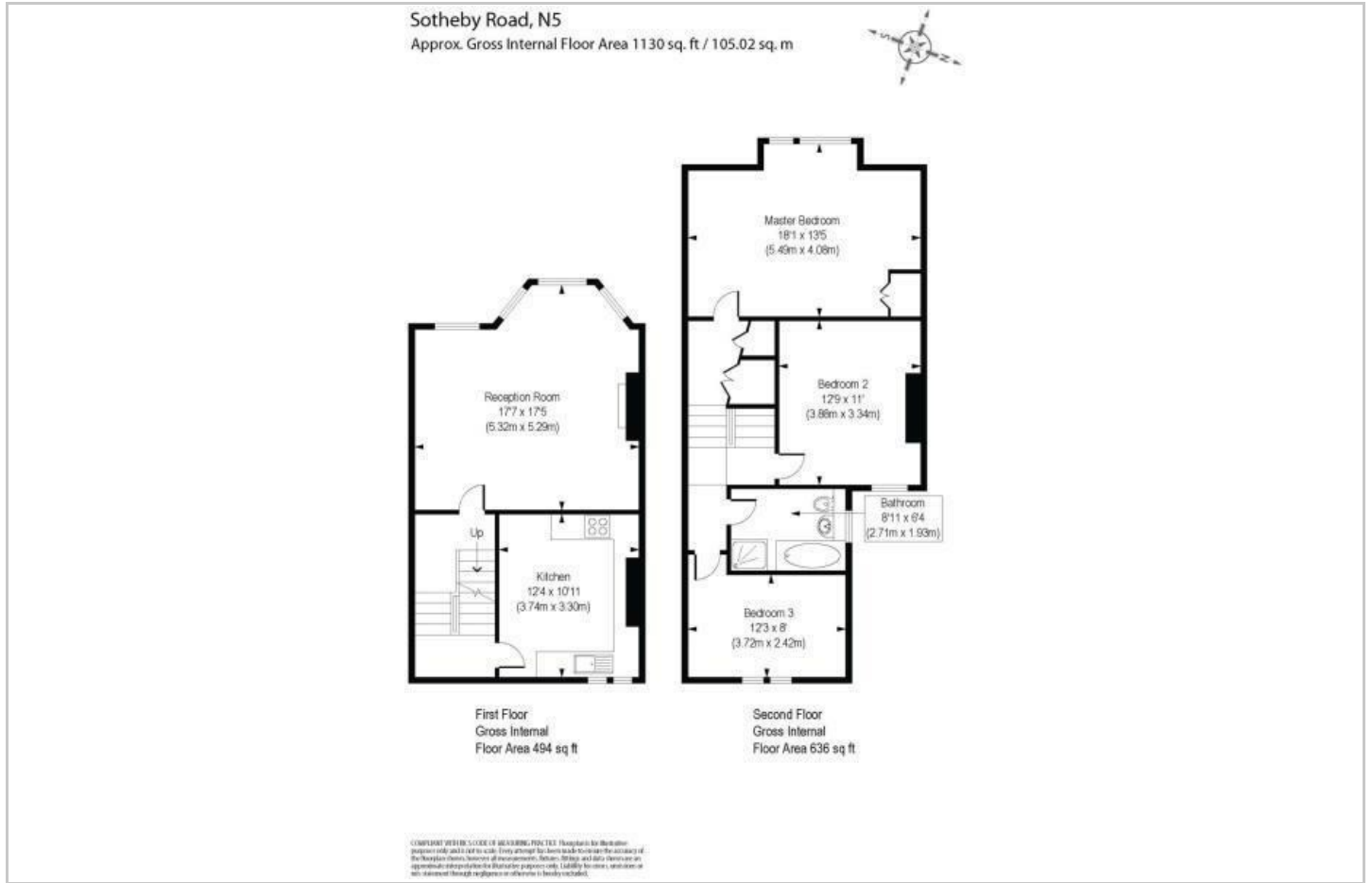

Area Map

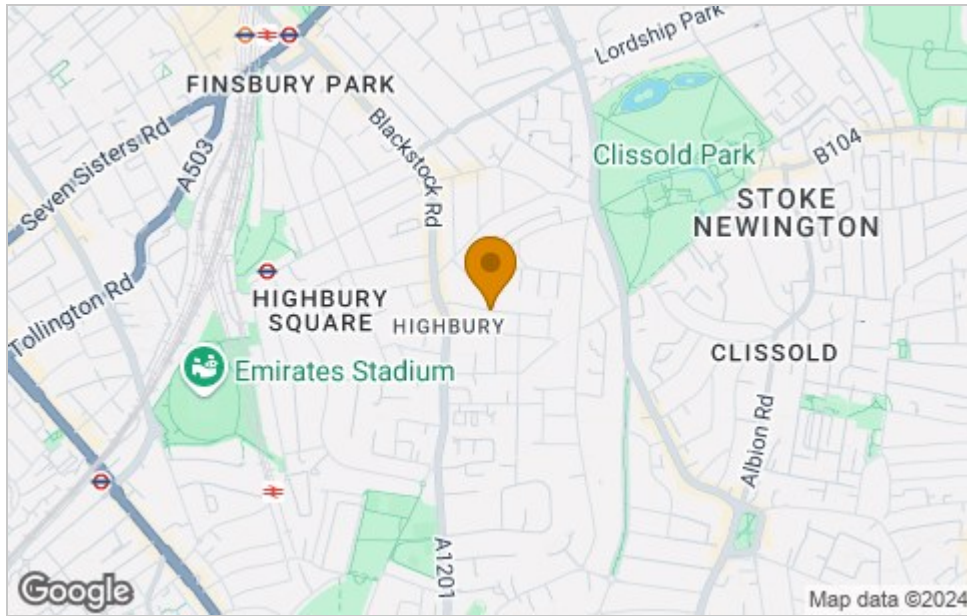

Viewing

Please contact our James Edward Office on 020 7952 5197 if you wish to arrange a viewing appointment for this property or require further information.

Energy Efficiency Graph

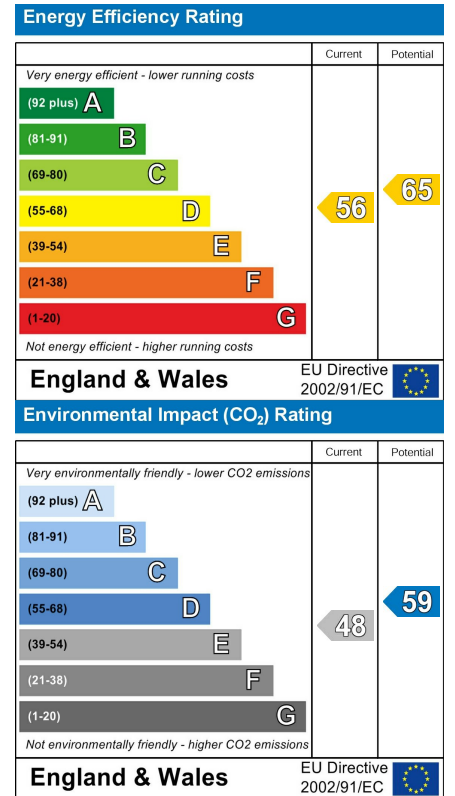

These particulars, whilst believed to be accurate are set out as a general outline only for guidance and do not constitute any part of an offer or contract. Intending purchasers should not rely on them as statements of representation of fact, but must satisfy themselves by inspection or otherwise as to their accuracy. No person in this firm's employment has the authority to make or give any representation or warranty in respect of the property.