

JAMES EDWARD

Comprehensively Cared For



Thane Villas

, London, N7 7PE

£425,000

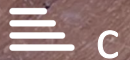

Thane Villas



Description

Well-presented large one bedroom apartment, situated on the raised ground floor of this impressive Edwardian mansion block, just a short walk from Finsbury Park Station. Property also offers access to a lovely communal garden.

- Share of Freehold
- Communal Garden
- 10 Minute Walk to Finsbury Park Station
- Bay Fronted Living Room
- 587 sq ft
- Separate Living Room / Kitchen
- Raised Ground Floor
- Quiet Location





Floor Plan

4 Thane Mansions, Thane Villas, London, N7 7PE

Approx. Gross Internal Area 54.5 sq M (587 sq Ft)

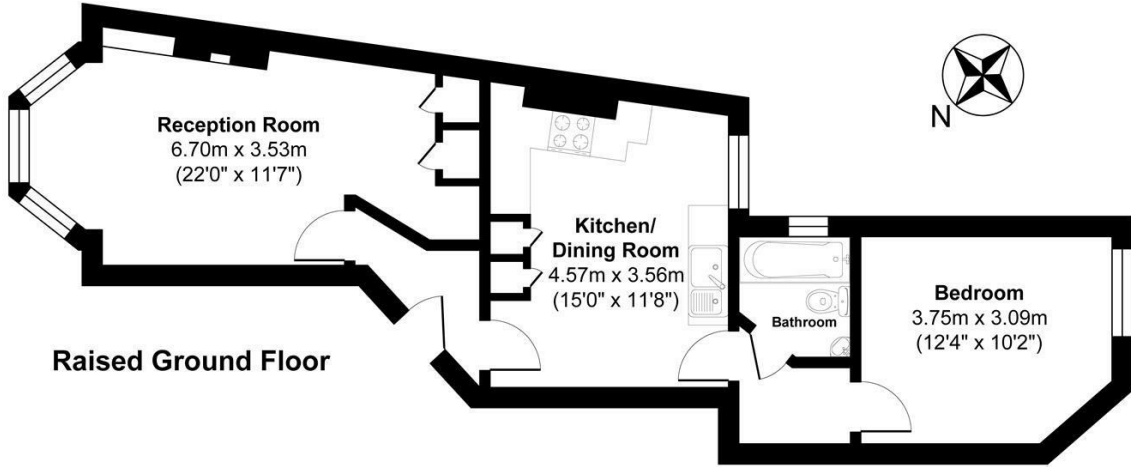

Measurements are approximate and for illustration purposes only, while we do not doubt the accuracy and completeness, we advise you conduct independent assessment of the property to determine monetary value.
© @ modephotouk www.modephoto.co.uk

Area Map

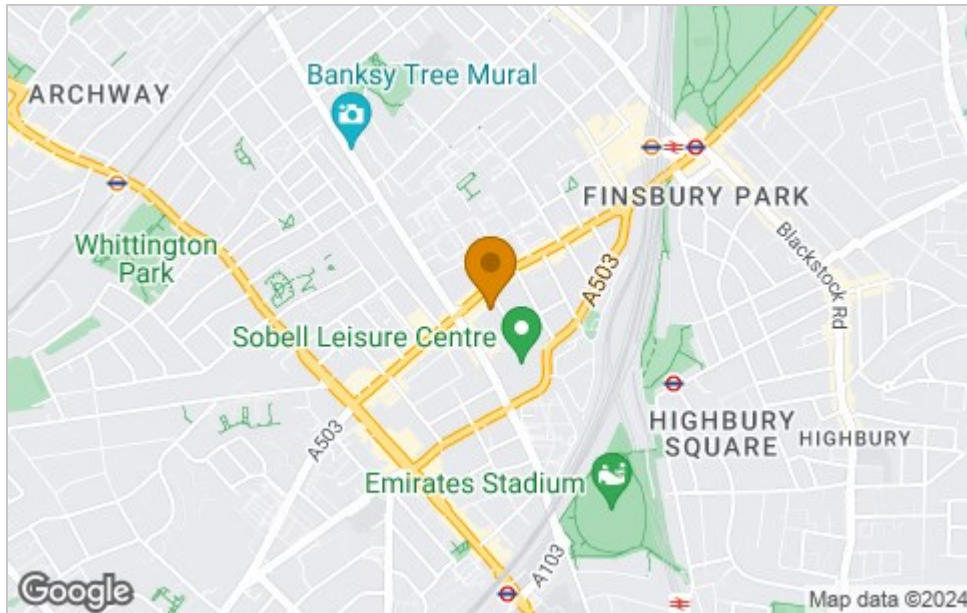

Viewing

Please contact our James Edward Office on 020 7952 5197 if you wish to arrange a viewing appointment for this property or require further information.

Energy Efficiency Graph

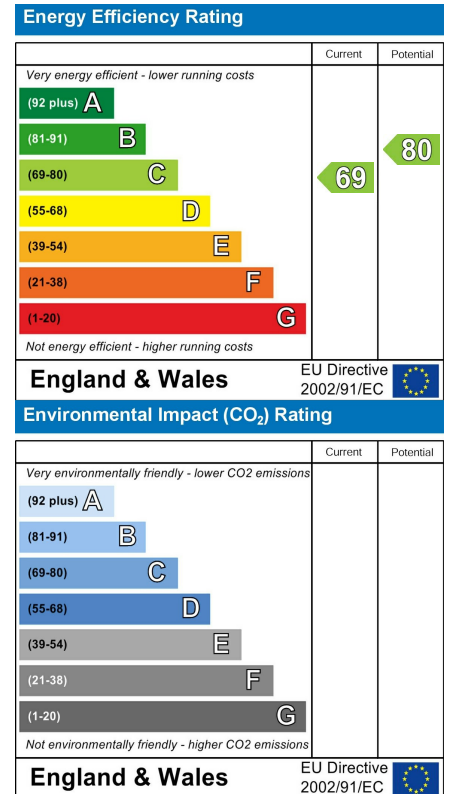

These particulars, whilst believed to be accurate are set out as a general outline only for guidance and do not constitute any part of an offer or contract. Intending purchasers should not rely on them as statements of representation of fact, but must satisfy themselves by inspection or otherwise as to their accuracy. No person in this firm's employment has the authority to make or give any representation or warranty in respect of the property.