

JAMES EDWARD

Comprehensively Cared For



Petherton Road

, London, N5 2QT

£2,250 Per Month



Petherton Road



Description

Well presented one bedroom apartment, situated on the top floor of this impressive period conversion, with private share of garden. Located just an 8 minute walk to Canonbury Station.

- Top Floor Flat
- Furnished
- 8 Minute Walk to Canonbury Station
- Available 1st June
- Private Share of Garden
- Period Conversion
- Close to Clissold Park Station
- Wooden Flooring Throughout





Floor Plan

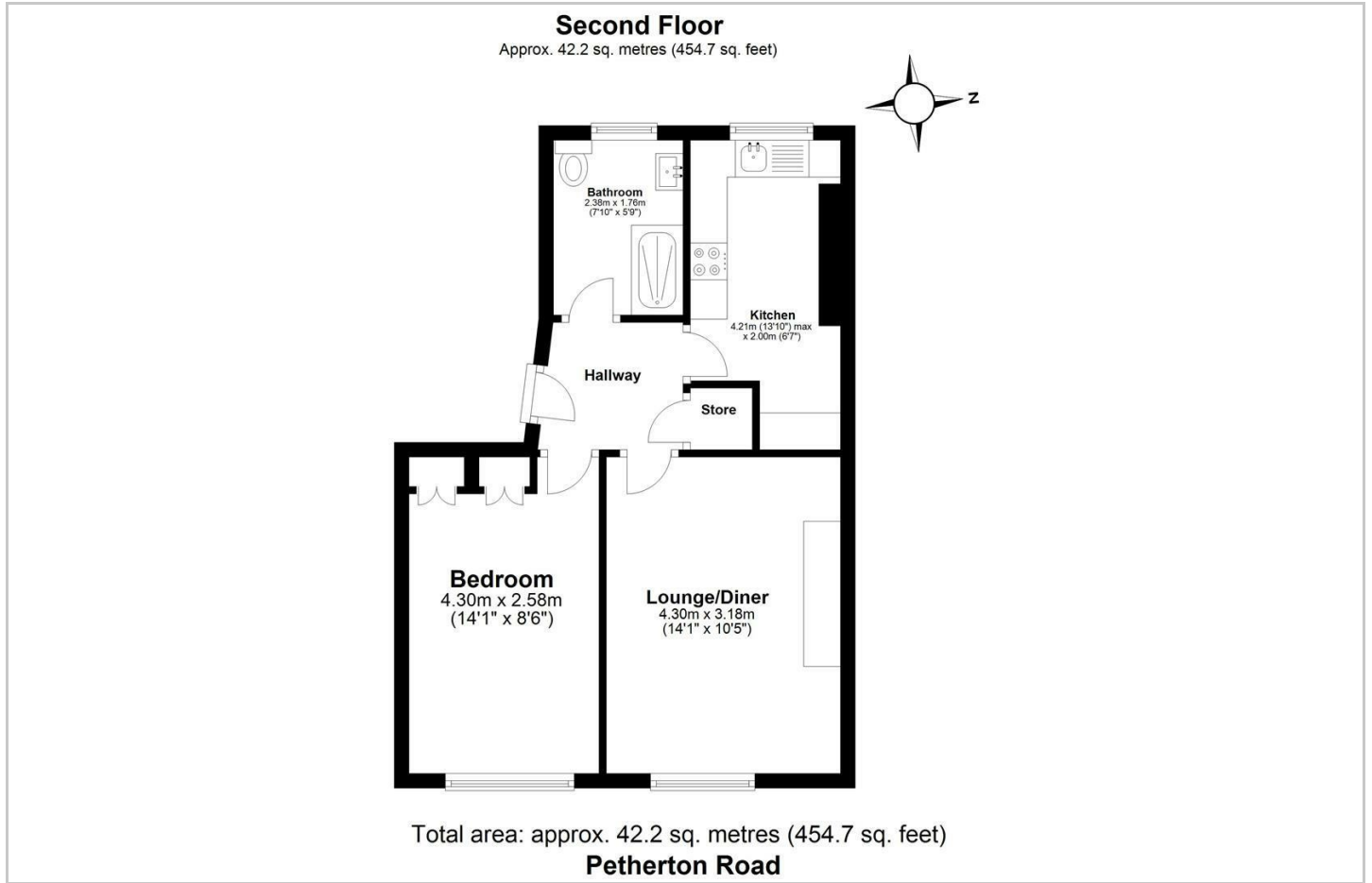

Area Map



Viewing

Please contact our James Edward Office on 020 7952 5197 if you wish to arrange a viewing appointment for this property or require further information.

Energy Efficiency Graph

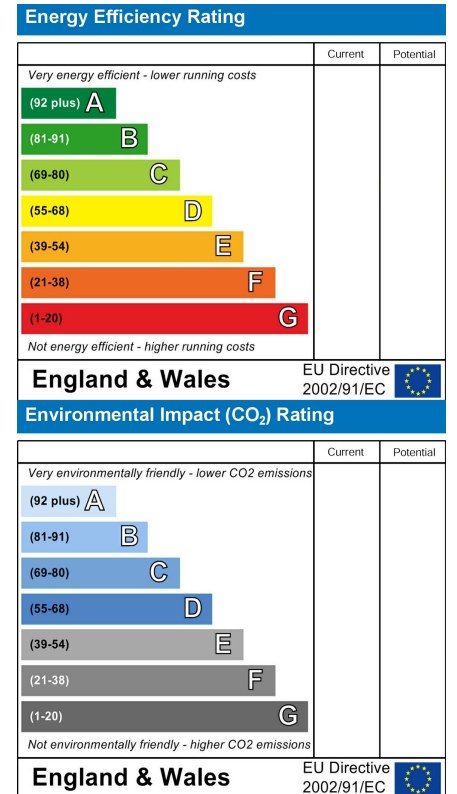

These particulars, whilst believed to be accurate are set out as a general outline only for guidance and do not constitute any part of an offer or contract. Intending purchasers should not rely on them as statements of representation of fact, but must satisfy themselves by inspection or otherwise as to their accuracy. No person in this firm's employment has the authority to make or give any representation or warranty in respect of the property.

100 Highbury Park, London, N5 2XE

Tel: 020 7952 5197 Email: info@jamesedwardproperties.co.uk <https://www.jamesedwardproperties.co.uk>