

JAMES EDWARD

Comprehensively Cared For



Highbury Grange

, London, N5 2PA

£325,000



Highbury Grange



Description

Charming one bedroom apartment, situated on the second floor of this purpose built block. Offering an excellent location in Highbury, with Canonbury Overground, Highbury Fields and Highbury & Islington Station all nearby. ****PLEASE READ FULL DESCRIPTION****

- Characterful Mansion Block
- Large built in storage cupboard
- Minutes' Walk to Highbury Fields
- Second Floor
- Communal Garden
- Minutes' Walk to Highbury Barn
- Quiet Location
- Chain Free





Floor Plan

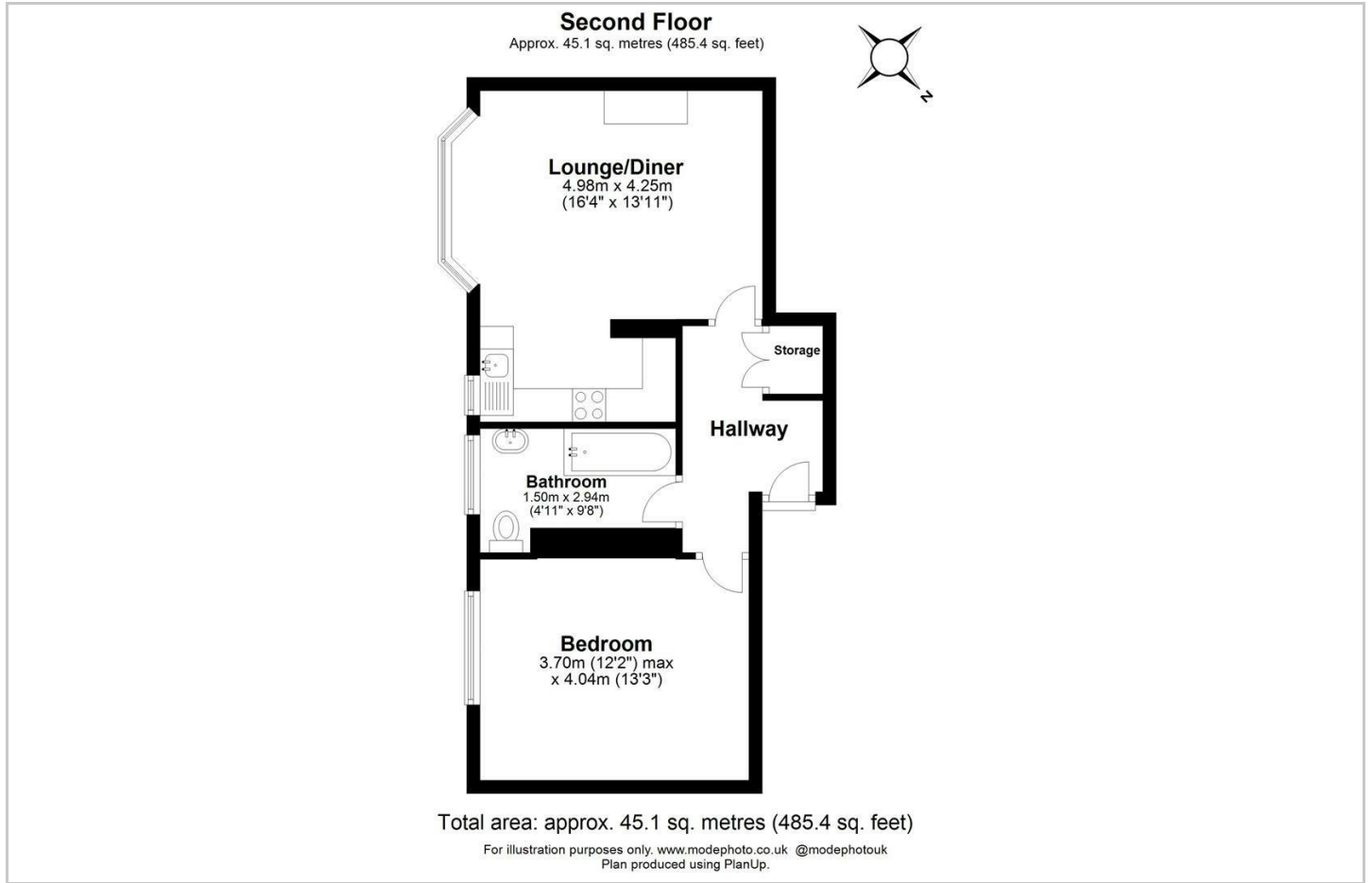

Area Map

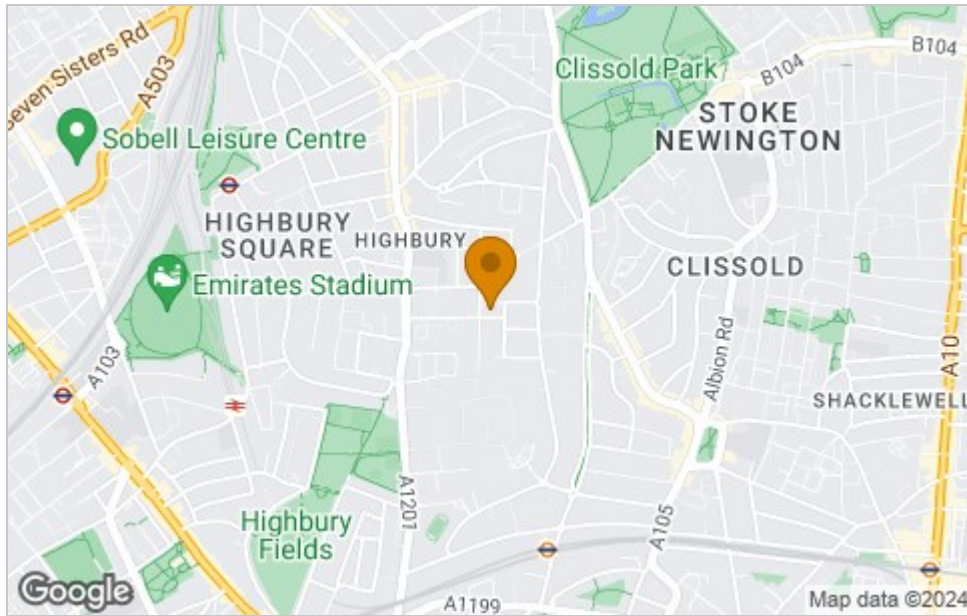

Viewing

Please contact our James Edward Office on 020 7952 5197 if you wish to arrange a viewing appointment for this property or require further information.

Energy Efficiency Graph

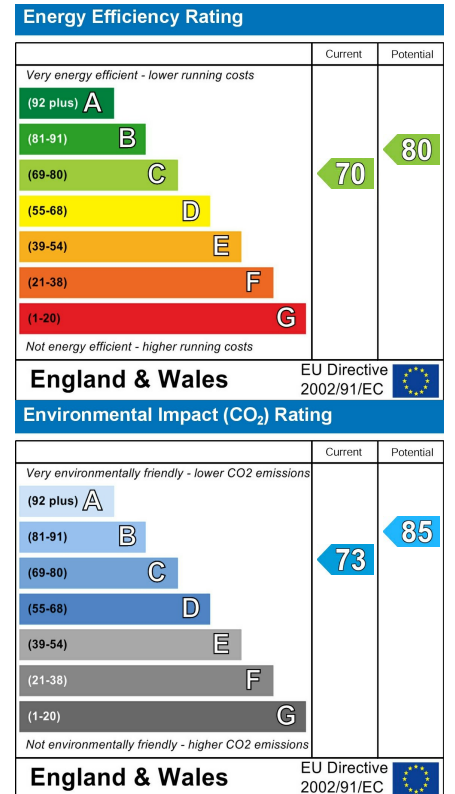

These particulars, whilst believed to be accurate are set out as a general outline only for guidance and do not constitute any part of an offer or contract. Intending purchasers should not rely on them as statements of representation of fact, but must satisfy themselves by inspection or otherwise as to their accuracy. No person in this firm's employment has the authority to make or give any representation or warranty in respect of the property.

100 Highbury Park, London, N5 2XE

Tel: 020 7952 5197 Email: info@jamesedwardproperties.co.uk <https://www.jamesedwardproperties.co.uk>