

JAMES EDWARD

Comprehensively Cared For

Drayton Park

, London, N5 1PB

£4,000 Per Annum



5



3



1



Drayton Park



Description

Spacious and bright first floor office, situated close to Highbury & Islington. Offered on an all inclusive basis, with flexible length contract.





Floor Plan

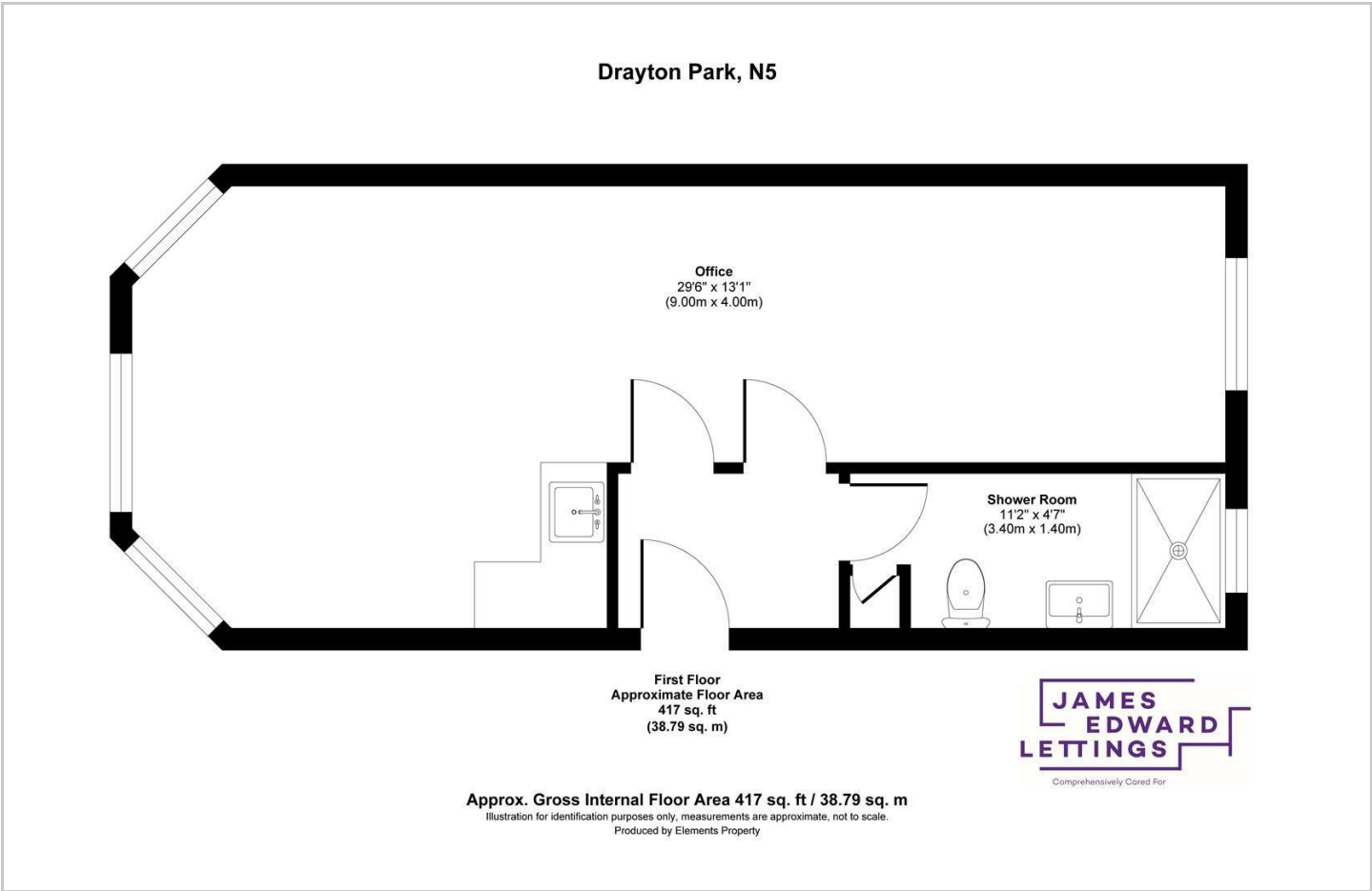

Area Map

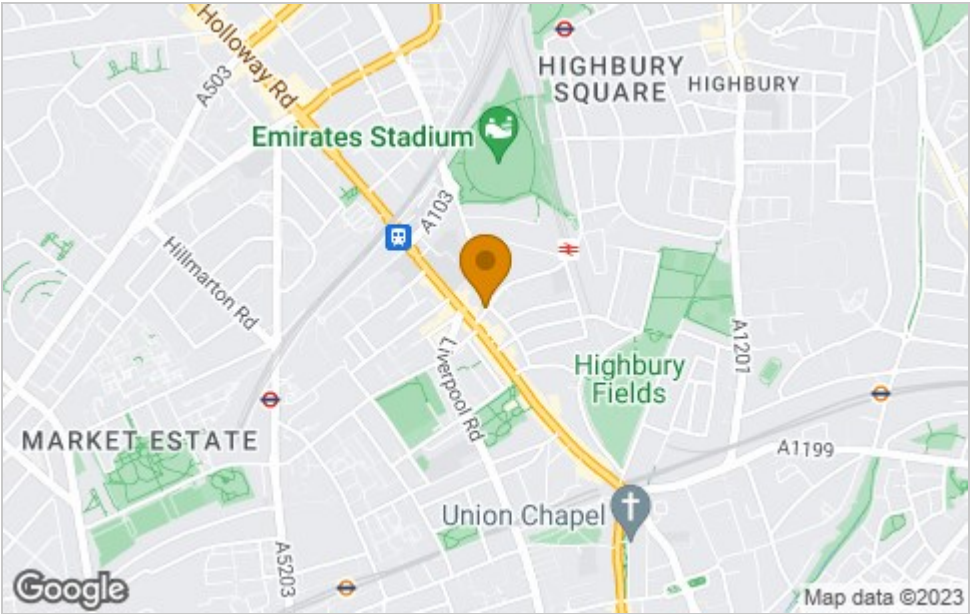

Viewing

Please contact our James Edward Office on 020 7952 5197 if you wish to arrange a viewing appointment for this property or require further information.

Energy Efficiency Graph

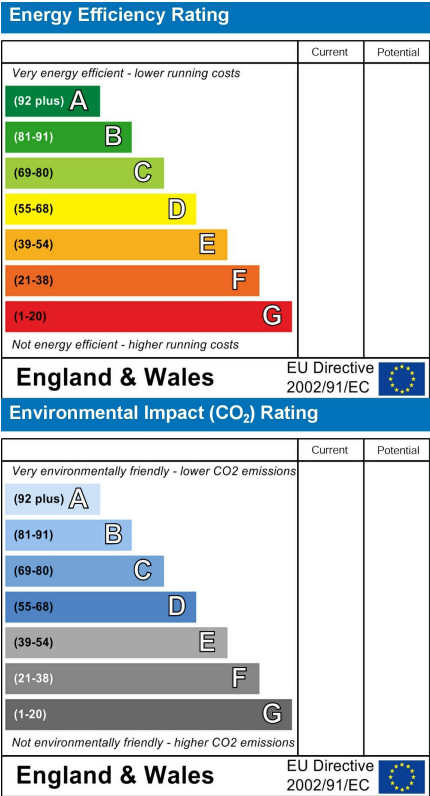

These particulars, whilst believed to be accurate are set out as a general outline only for guidance and do not constitute any part of an offer or contract. Intending purchasers should not rely on them as statements of representation of fact, but must satisfy themselves by inspection or otherwise as to their accuracy. No person in this firms employment has the authority to make or give any representation or warranty in respect of the property.