

# chris hamriding

lettings & estate agents



## 14 Moody Street, Congleton, CW12 4AP

Offers In The Region Of £440,000

WATCH OUR GUIDED VIDEO TOUR OF THIS FABULOUS HOME!

Rare is the opportunity to purchase such a charming and special townhouse offering such a wealth of well presented characterful accommodation!

Located in the historic address of Moody Street sitting perfectly between the vibrant town centre and miles of Cheshire countryside, this property enjoys an array of traditional period features as well as a wealth of extremely generous rooms sure to appeal to those of you looking for a characterful home to house even the busiest of families! The Grade II listed property has been expertly and sympathetically crafted into a gorgeous home and has previously seen use as prestigious offices! You'll surely smile when glancing at the period sash windows, picture rails, coving, stone fireplaces, exposed beams and more whilst also daydreaming at the prospect of adding your own designer touches to this historic building that has proudly served as a happy family home for many years! As well as the six generous bedrooms, two stylish bathrooms, two reception rooms and entertaining kitchen....Outside to the rear sits a most useful patio garden with gated access to the rear where you'll find your very own driveway with EV charging point.

Just a stone's throw away, the bustling town centre of Congleton offers all the amenities you could ask for whilst a minutes walk in the other direction will find you amidst abundant countryside via 'Priestly Fields'.

We could talk all day about this truly wonderful home but we invite you to browse our internal particulars, photos and floorplans....and call us to book a bespoke appointment to view this stunning property!

**Entrance Hall**

**Lounge/ Sitting Room**

**Dining Kitchen**

Please note; Current owner has obtained planning permission to remove the rear door and convert to bifolds to the rear.

**Utility/ Laundry**

**Stairs and Landing**

**Bedroom Three**

**Bedroom Four**

**Bedroom Five**

**Bedroom Six**

**Family Bathroom**

**Stairs and Landing**

**Bedroom One**

**Bedroom Two**

**Shower Room**

**Rear Yard**

**Parking Space**

Floor Plan

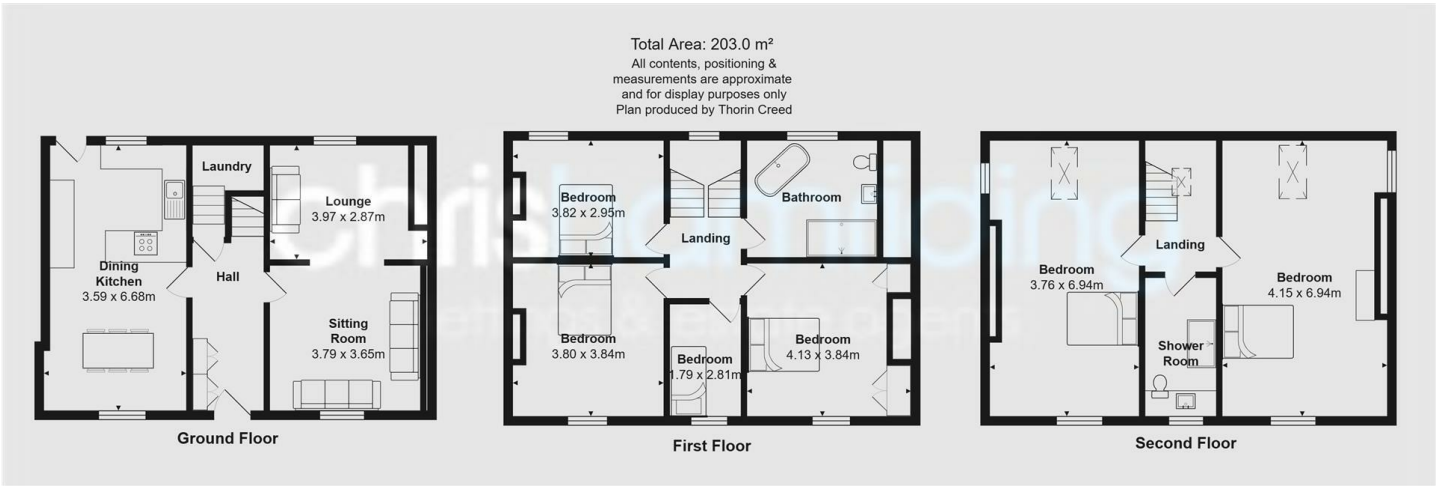

Area Map

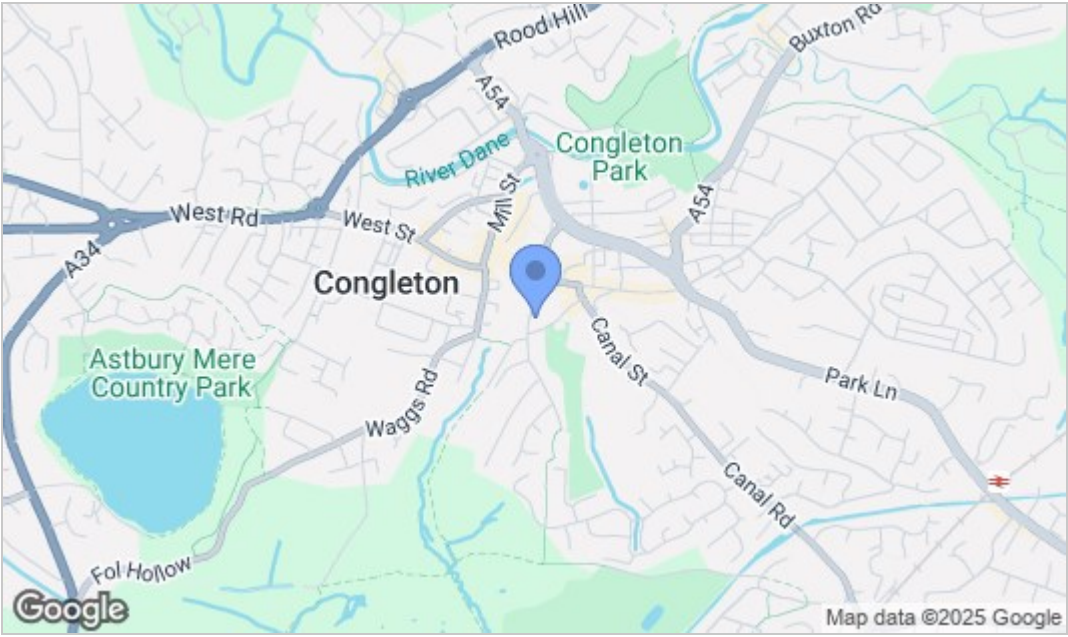

Energy Efficiency Graph

NOTICE Chris Hamriding Lettings & Estate Agents for themselves and for the vendor or lessors of this property whose agents they are given notice that: (i) the particulars are set out as a general outline only for the guidance of intending purchasers or lessees, and do not constitute, nor constitute part of, an offer of contract, (ii), all descriptions, dimensions, references to condition and necessary permissions for use and occupation, and other details are given in good faith and are believed to be correct but any intending purchasers or tenants should not rely on them as statement or representation of fact but must satisfy themselves by inspection or otherwise as to the correctness of each of them, (iii) no person in the employment of Chris Hamriding Lettings & Estate Agents has any authority to make or give any representation or warranty whatever in relation to this property.