



## 43 Ullswater Road, Congleton, CW12 4JE

### Offers In The Region Of £315,000

Located within an ever popular, and very well regarded area of West Heath, this property has been expertly extended and transformed into a wonderful family home that we are just sure you'll love!

An attractive block paved driveway gives the property stunning kerb appeal and as you enter you're sure to just love the fresh, clean accommodation that flows perfectly through entrance hall, lounge and into the show stopping dining kitchen and family room. This hub of the home enjoys views over the garden and is just perfect for entertaining all year round!

Upstairs you'll find excellently proportioned bedrooms and a luxurious family bathroom.

Completing the whole package is the useful garage, which is sure to tick that final box!

Locally, excellent schools at both primary and secondary level are within easy walking distance and local amenities are well catered for at the West Heath shopping precinct just a short stroll away. The delightful Asbury Mere Country Park is also a stone's throw away, a tranquil oasis on the outskirts of the town.

We love this property and we're sure you will to so call us now to book your viewing!

**Entrance porch**

**Entrance Hall**

**Guest W.C.**

**Lounge 15'6" x 11'11" (4.74 x 3.65)**

**Dining kitchen / Family area 27'3" x 11'11" (8.325 x 3.641)**

**Landing**

**Bedroom one 13'8" x 10'10" (4.173 x 3.326)**

**Bedroom two 12'9" x 11'2" (3.902 x 3.411)**

**Bedroom three 15'2" x 7'0" (4.626 x 2.156)**

**Bedroom four 9'3" x 8'5" (2.836 x 2.576)**

**Bathroom 3.152 x 2.271**

**Front**

**Integral garage 19'10" x 7'3" (6.058 x 2.23)**

**Rear**

# Floor Plan

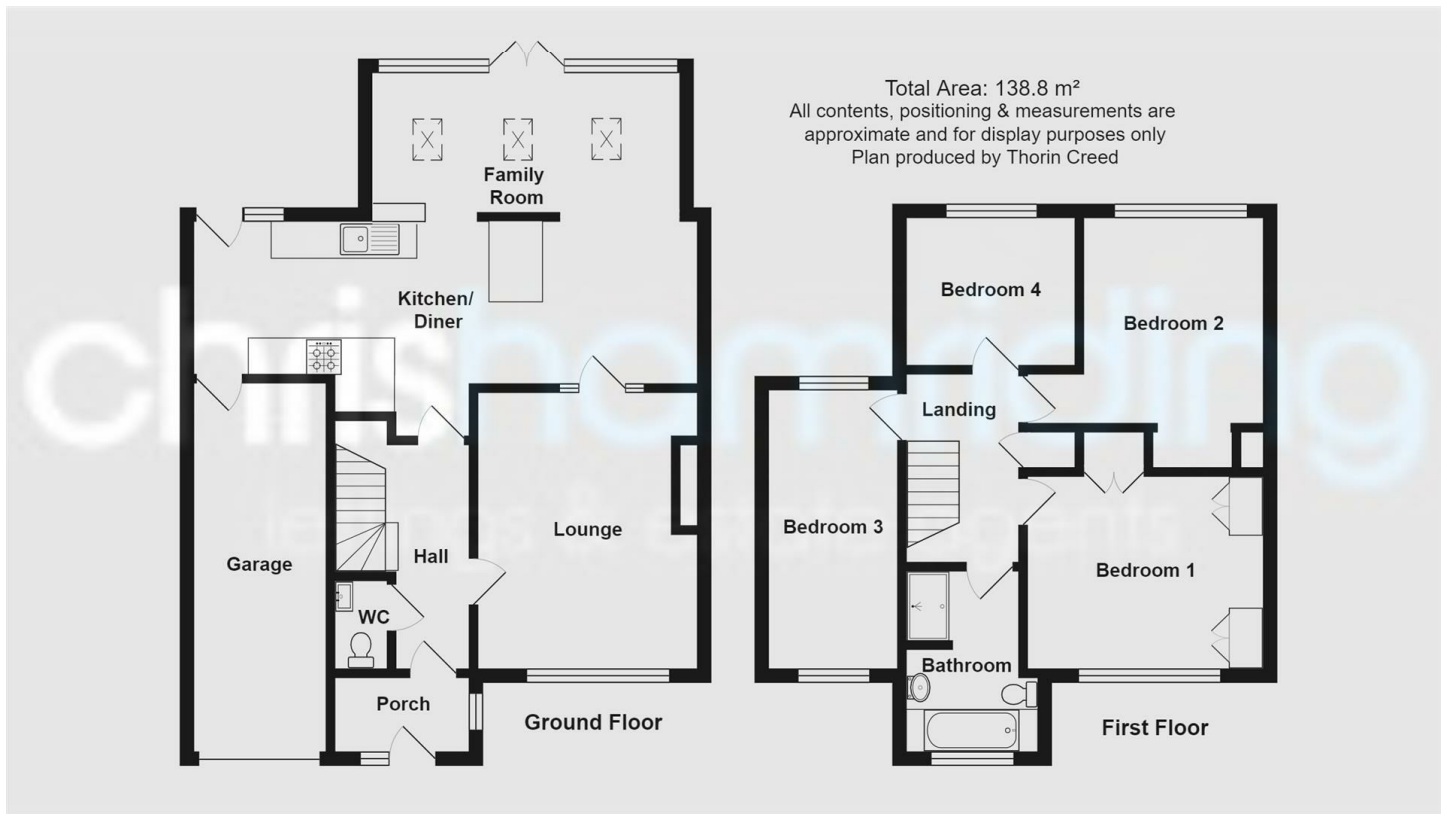

# Area Map

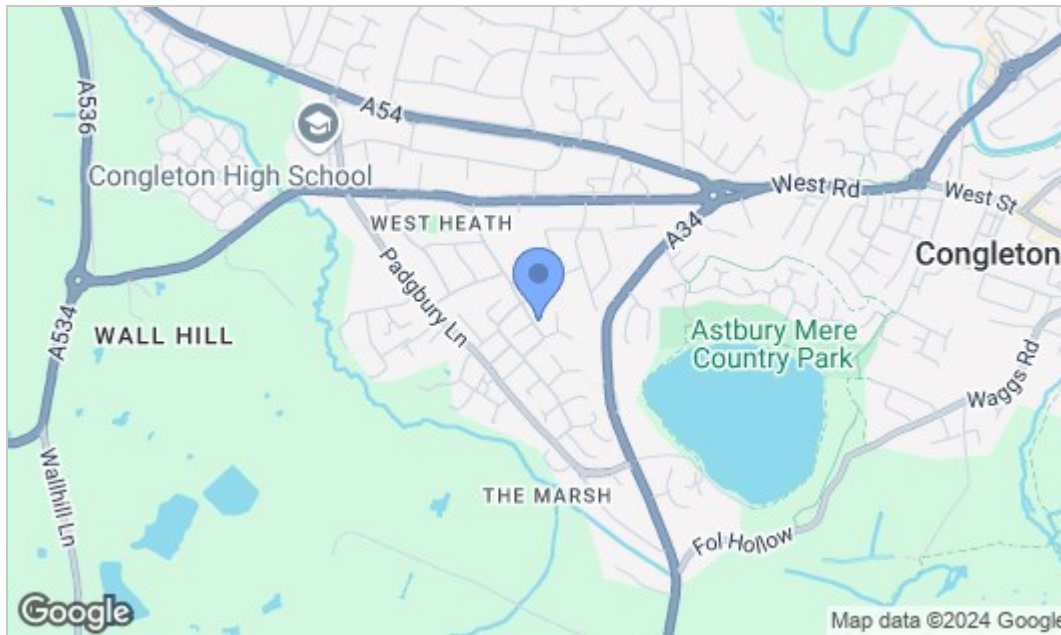

# Energy Efficiency Graph

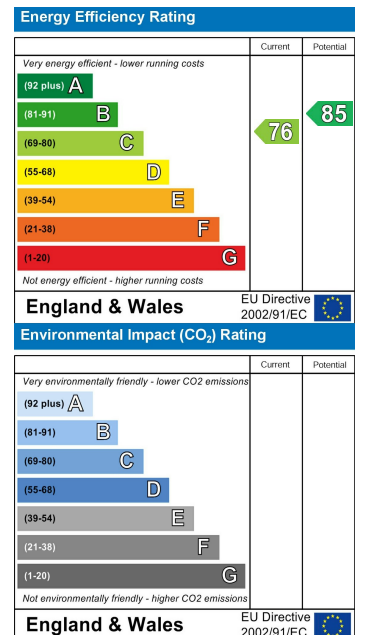

NOTICE Chris Hamriding Lettings & Estate Agents for themselves and for the vendor or lessors of this property whose agents they are given notice that: (i) the particulars are set out as a general outline only for the guidance of intending purchasers or lessees, and do not constitute, nor constitute part of, an offer of contract, (ii), all descriptions, dimensions, references to condition and necessary permissions for use and occupation, and other details are given in good faith and are believed to be correct but any intending purchasers or tenants should not rely on them as statement or representation of fact but must satisfy themselves by inspection or otherwise as to the correctness of each of them, (iii) no person in the employment of Chris Hamriding Lettings & Estate Agents has any authority to make or give any representation or warranty whatever in relation to this property.