

chris hamriding

lettings & estate agents



30 Briarswood, Biddulph, ST8 6BW

£285,000

WATCH OUR GUIDED VIDEO TOUR!

Nestled in a beautiful area this semi-detached house is a true gem waiting to be discovered.

With four generously sized bedrooms and two stylish bathrooms, this property offers ample space for the whole family to relax and rejuvenate. The spacious and comfortable lounge is ideal for cosy evenings in, while the amazing dining kitchen opens up to landscaped private rear gardens, perfect for enjoying a morning coffee or hosting a summer barbecue.

Parking is a breeze with space for plenty of vehicles, along with a driveway and garage for added convenience. The property also boasts a useful utility/store, ensuring that storage is never an issue.

Situated at the head of an exclusive cul de sac, peace and quiet are guaranteed, providing a tranquil retreat from the hustle and bustle of everyday life. Close to the charming towns of Biddulph and Congleton, as well as miles of beautiful countryside, this home offers the perfect blend of convenience and natural beauty.

Read on to find out more, view our video, photos and floor plan then call us here at Chris Hamriding Estate Agents to book yourself that all important viewing!

Hall

WC

Lounge 11'9" x 16'7" (3.59 x 5.07m)

Dining kitchen 15'3" x 12'11" (4.66 x 3.94m)

Utility/ store 8'10" x 6'3" (2.71 x 1.91m)

Garage 8'10" x 7'5" (2.71 x 2.27m)

Stairs and landing

Bedroom one 8'9" x 13'7" (2.68 x 4.16m)

Ensuite

Bedroom two 10'10" x 10'2" (3.31 x 3.12m)

Bedroom three 8'1" x 13'6" (2.48 x 4.12m)

Bedroom four 6'11" x 13'6" (2.12 x 4.12m)

Bathroom

Driveway

Front and rear gardens

Floor Plan

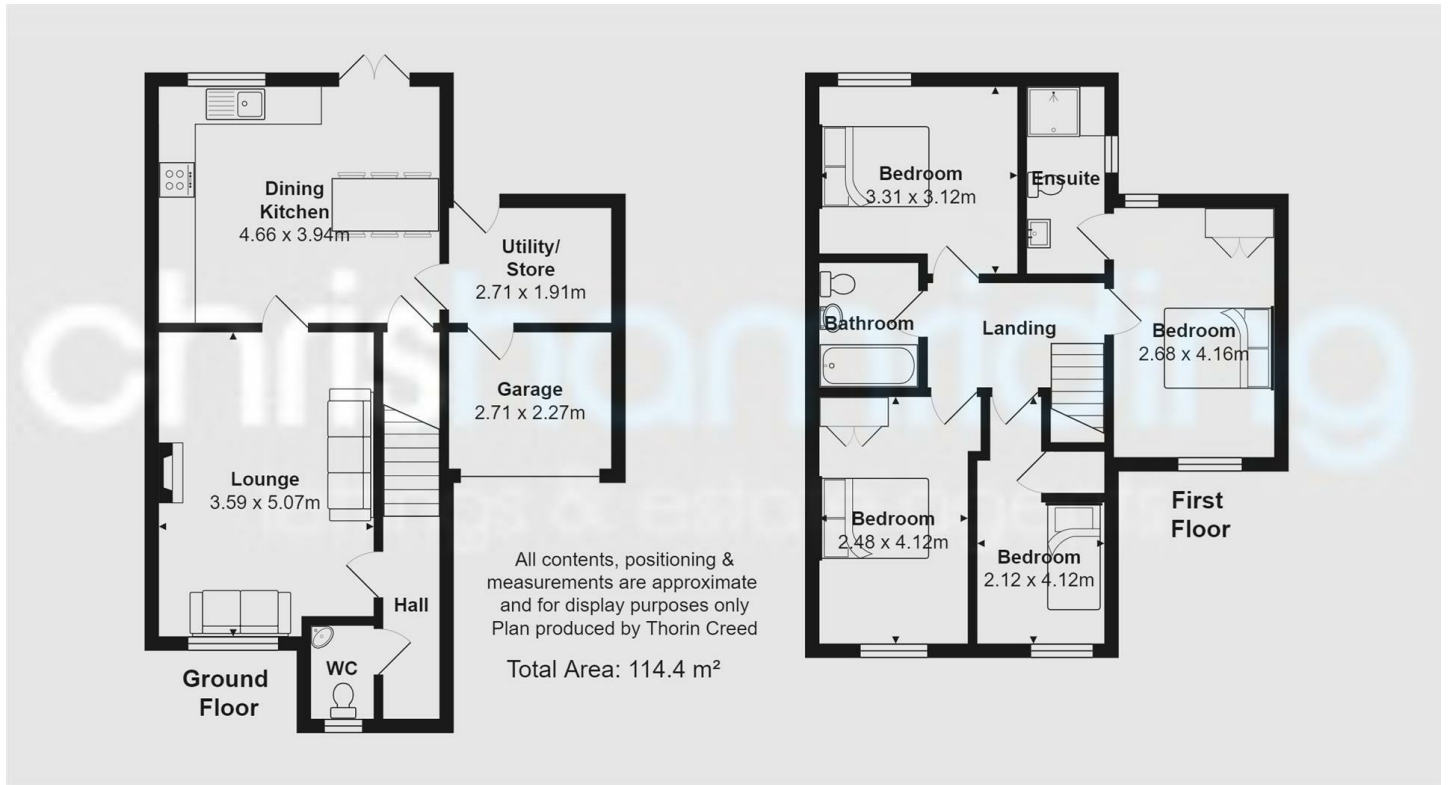

Area Map

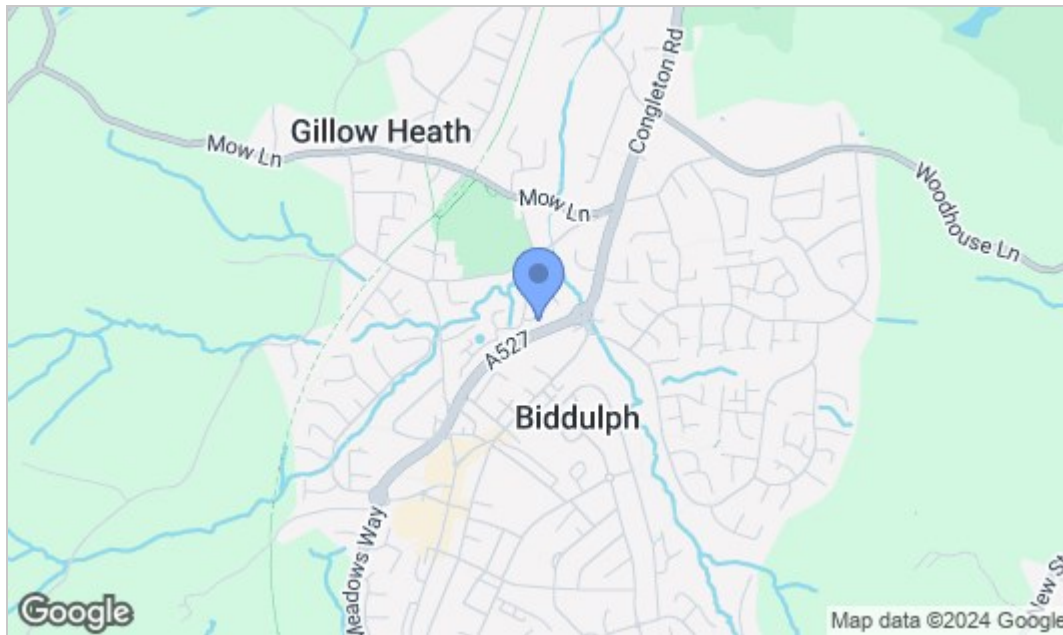

Energy Efficiency Graph

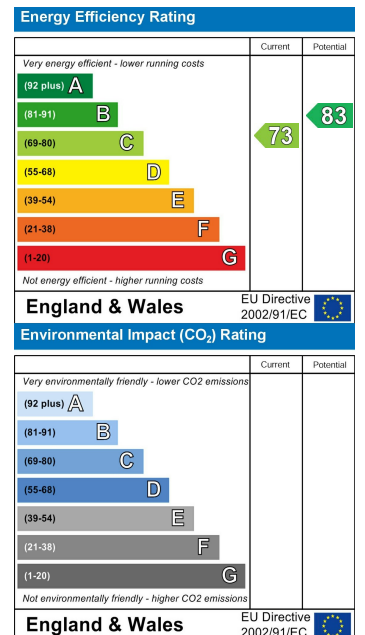

NOTICE Chris Hamriding Lettings & Estate Agents for themselves and for the vendor or lessors of this property whose agents they are given notice that: (i) the particulars are set out as a general outline only for the guidance of intending purchasers or lessees, and do not constitute, nor constitute part of, an offer of contract, (ii), all descriptions, dimensions, references to condition and necessary permissions for use and occupation, and other details are given in good faith and are believed to be correct but any intending purchasers or tenants should not rely on them as statement or representation of fact but must satisfy themselves by inspection or otherwise as to the correctness of each of them, (iii) no person in the employment of Chris Hamriding Lettings & Estate Agents has any authority to make or give any representation or warranty whatever in relation to this property.