



## Plot 153 Westlow Heath Manchester Road, Congleton, CW12 2HT

### Offers In The Region Of £504,950

Nestled in the exclusive Westlow Heath development along Manchester Road in Congleton, lies this stunning detached luxury home! This property boasts two reception rooms, four bedrooms, and two bathrooms, making it an ideal space for a growing family.

As you arrive, you'll be greeted by the attractive ample driveway ensuring convenience for you and your guests. This brand new build, formerly a show home, is a testament to luxury living, with high kitchen specifications, plush carpets, and beautifully landscaped gardens that are sure to impress.

Situated on the edge of the already well established Jones Homes development, this residence offers a perfect blend of modern amenities and natural beauty. Enjoy the best of both worlds with proximity to Congleton town centre for all your daily needs, while also being surrounded by miles of picturesque Cheshire countryside.

Whether you're looking to upsize or simply seeking a new beginning, this property presents a wonderful opportunity to create lasting memories in a home that exudes elegance and comfort. Don't miss out on the chance to make this house your own and experience the epitome of contemporary living in a desirable location.

**Hall**

**WC**

**Study 8'9 x 7'5 (2.67m x 2.26m)**

**Lounge 14'0 x 13'11 (4.27m x 4.24m)**

**Kitchen family dining 28'7 x 8'8 (8.71m x 2.64m)**

**Utility**

**Stairs and landing**

**Bedroom one 14'0 x 12'5 (4.27m x 3.78m)**

**Ensuite**

**Bedroom two 11'0 x 12'5 (3.35m x 3.78m)**

**Bedroom three 10'4 x 10'2 (3.15m x 3.10m)**

**Bedroom four 10'4 x 7'7 (3.15m x 2.31m)**

**Family bathroom**

**Double garage**

**Front and rear gardens**



## Floor Plan



### Ground Floor

Living Room	4.26m x 4.24m	14'0" x 13'11"
Kitchen/Family/Dining	8.71m x 2.64m	28'7" x 8'8"
Study	2.68m x 2.27m	8'9" x 7'5"

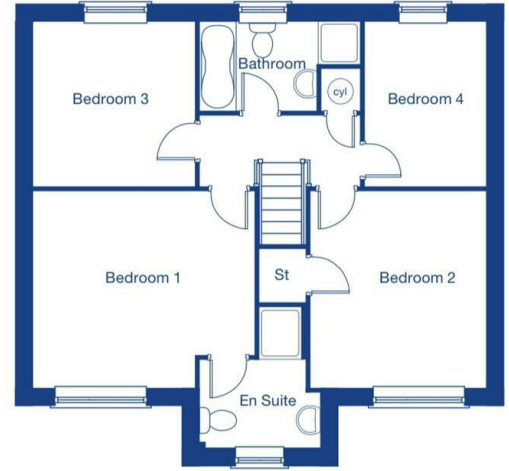

### First Floor

Bedroom 1	4.26m x 3.79m	14'0" x 12'5"
Bedroom 2	3.35m x 3.79m	11'0" x 12'5"
Bedroom 3	3.16m x 3.10m	10'4" x 10'2"
Bedroom 4	3.16m x 2.30m	10'4" x 7'7"

## Area Map

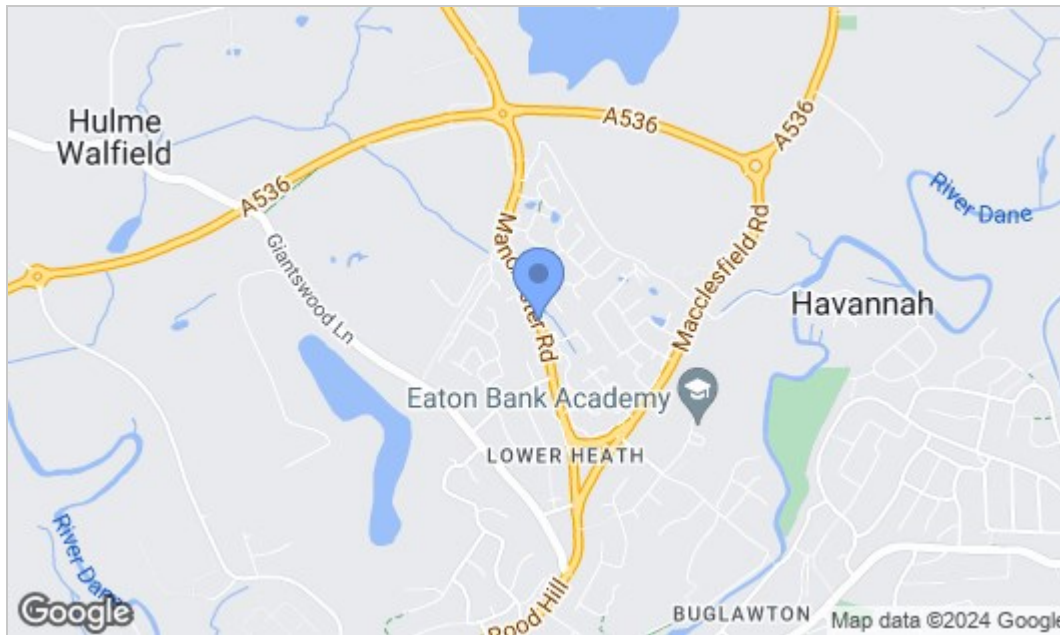

## Energy Efficiency Graph

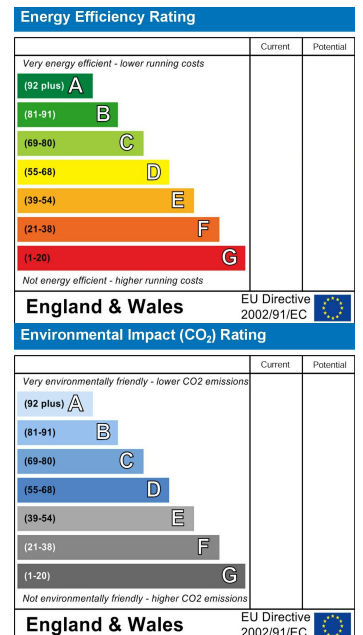

NOTICE Chris Hamriding Lettings & Estate Agents for themselves and for the vendor or lessors of this property whose agents they are given notice that: (i) the particulars are set out as a general outline only for the guidance of intending purchasers or lessees, and do not constitute, nor constitute part of, an offer of contract, (ii) all descriptions, dimensions, references to condition and necessary permissions for use and occupation, and other details are given in good faith and are believed to be correct but any intending purchasers or tenants should not rely on them as statement or representation of fact but must satisfy themselves by inspection or otherwise as to the correctness of each of them, (iii) no person in the employment of Chris Hamriding Lettings & Estate Agents has any authority to make or give any representation or warranty whatever in relation to this property.

