



## 19 High Lowe Avenue, Congleton, CW12 2EP

### Offers In The Region Of £299,950

Absolutely stunning! Take a few moments to admire this immaculate and charming home via our guided video tour...you will not be disappointed!

From the moment you set eyes on this homes pleasant exterior, you'll know that something special awaits you! Having been recently refurbished to amazing standards, once you move past the attractive front garden, you arrive into a welcoming entrance hall that leads to a beautiful lounge with a gorgeous fireplace, just perfect for relaxing! There's also a snug lounge area with a wood burning stove! The stylish kitchen is the perfect place to cook up a storm whilst entertaining around the huge social island and this room gives access out into the rear gardens. Up on the first floor you'll find three immaculate bedrooms, a stylish bathroom and a separate WC. Outside to the rear is where things start to get even more impressive with the rear lawned gardens complementing the lifestyle very well indeed boasting a detached timber summer house/home office that could suit a wide range of uses.

Locally, the bustling town centre of Congleton is within walking distance, great commuter links are nearby and endless countryside is within easy reach this making this a perfect home for a wide range of buyers!

Call us here at Chris Hamriding Estate Agents to find out more and book yourself that all important viewing!

## Hall

Lounge 11'1" x 16'4" (3.40 x 4.99m)

Family room 9'10" x 11'10" (3.02 x 3.62m)

Dining kitchen 13'4" x 16'7" (4.07 x 5.07m)

Stairs and landing

Bedroom one 9'11" x 14'9" (3.04 x 4.50m)

Bedroom two 11'3" x 8'4" (3.45 x 2.55m)

Bedroom three 8'3" x 7'8" (2.53 x 2.36m)

Shower room

## WC

Timber outbuilding 6'3" x 10'3" (1.93 x 3.13m)

Front and rear gardens

## Floor Plan

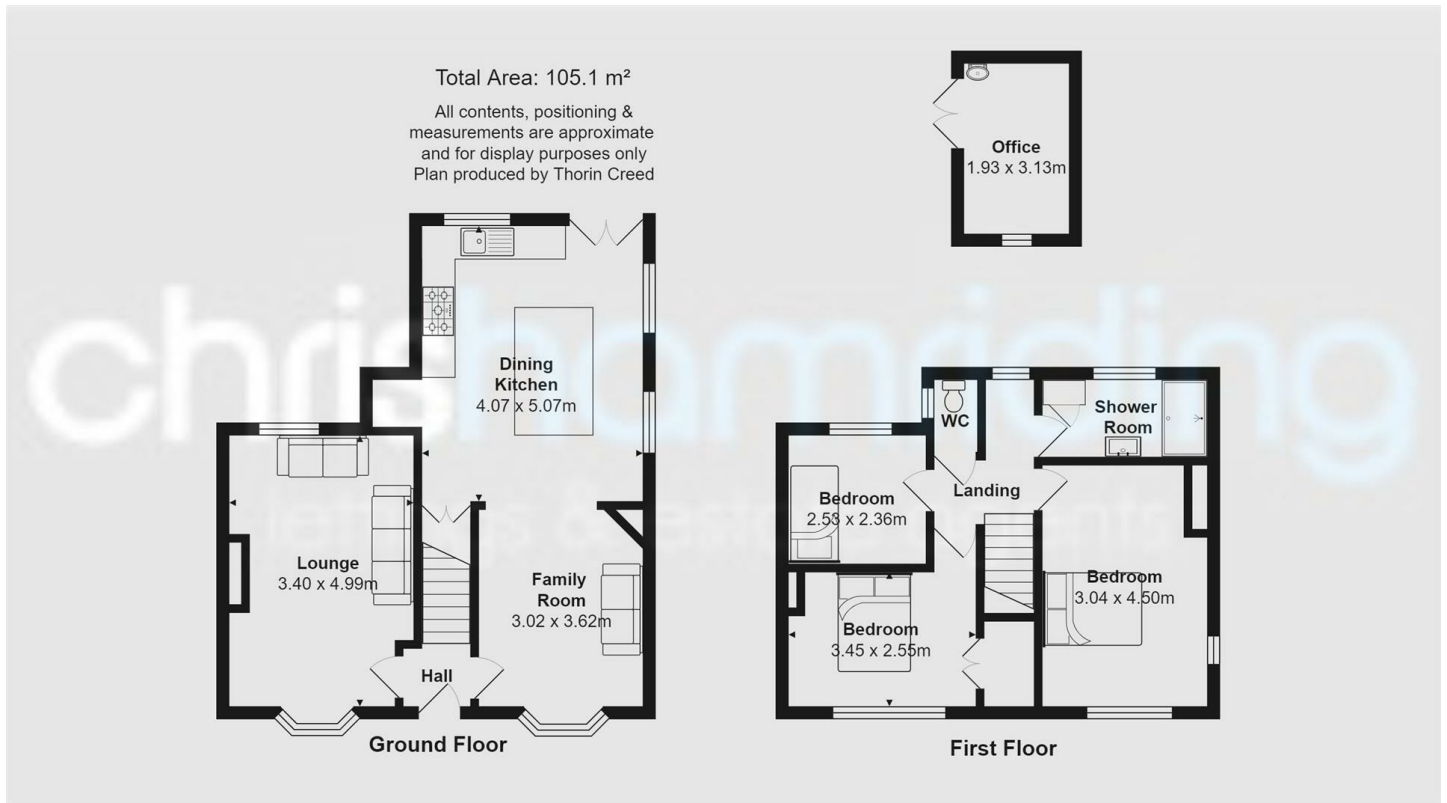

## Area Map

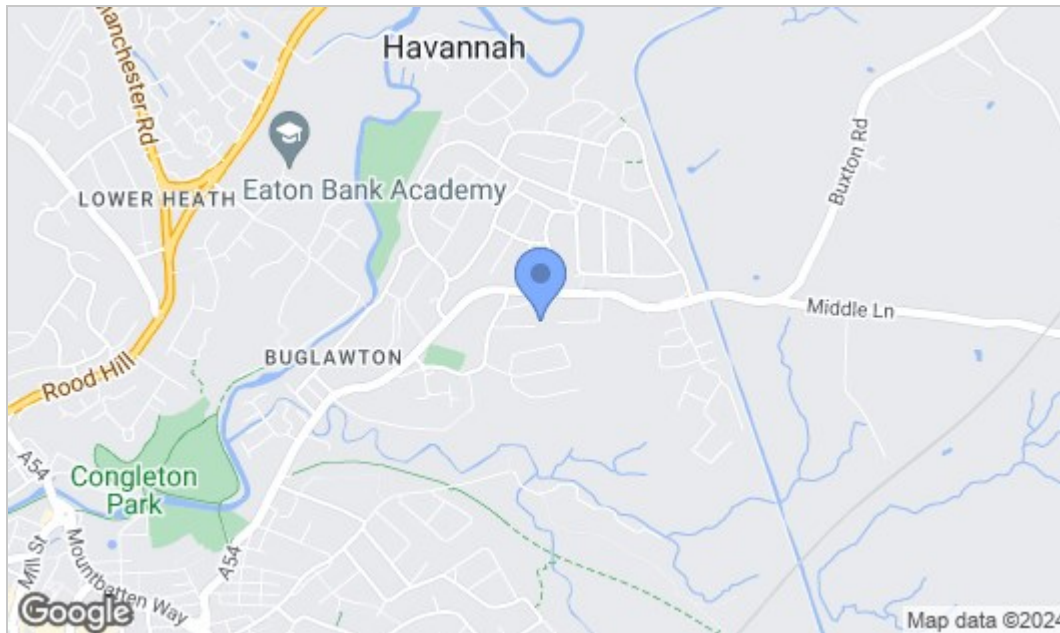

## Energy Efficiency Graph

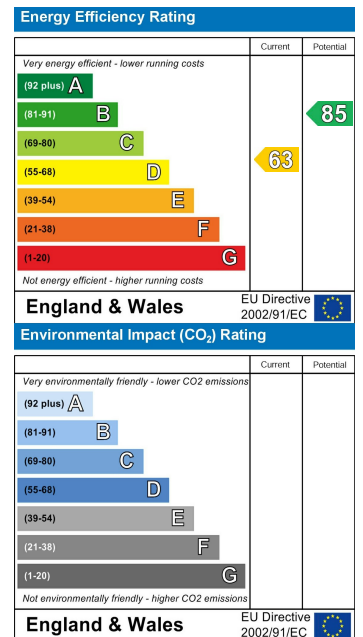

NOTICE Chris Hamriding Lettings & Estate Agents for themselves and for the vendor or lessors of this property whose agents they are given notice that: (i) the particulars are set out as a general outline only for the guidance of intending purchasers or lessees, and do not constitute, nor constitute part of, an offer of contract, (ii) all descriptions, dimensions, references to condition and necessary permissions for use and occupation, and other details are given in good faith and are believed to be correct but any intending purchasers or tenants should not rely on them as statement or representation of fact but must satisfy themselves by inspection or otherwise as to the correctness of each of them, (iii) no person in the employment of Chris Hamriding Lettings & Estate Agents has any authority to make or give any representation or warranty whatever in relation to this property.

