



26 Ashley Street, Sible Hedingham, Halstead, CO9 3EH

£1,550 Per Calendar Month

- End of Terrace Townhouse
- Double Carport & Visitor Parking
- Close to Local Shops & Amenities
- Unfurnished and Available June 2025
- Three Spacious Double Bedrooms
- Modern Kitchen with Island
- Good Access Links to M11 & Stansted
- En-Suite, Juliette Balcony & Fitted Wardrobes to Master Bedroom
- South Facing Garden with Patio & Timber Bar
- Good School Systems Nearby

Approximate Gross Internal Area
110.14 sq m / 1185.53 sq ft

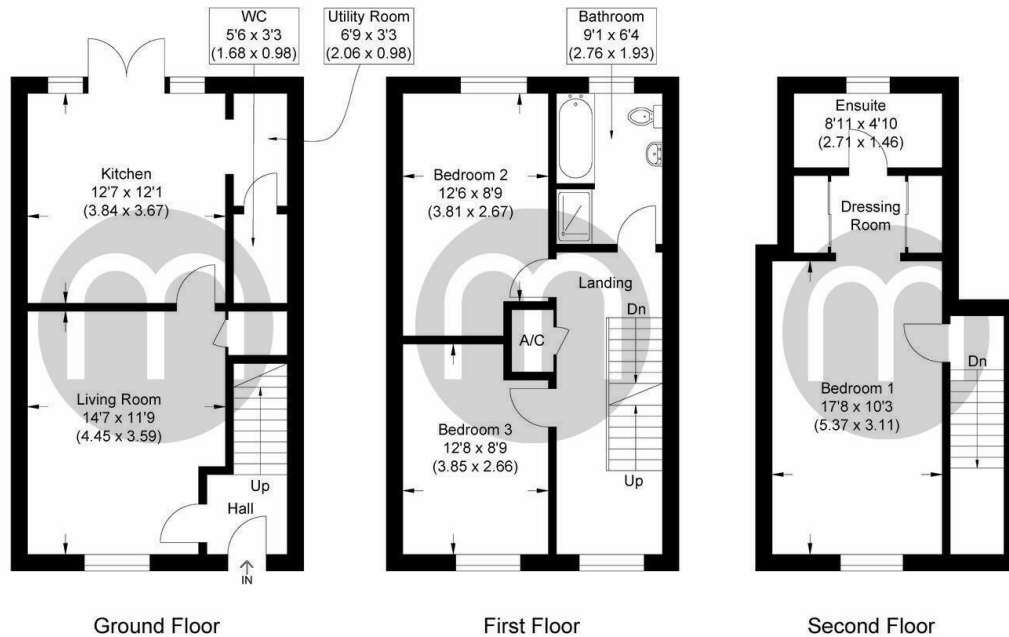

Illustration for identification purposes only, measurements are approximate, not to scale.

Directions

Viewings

Viewings by arrangement only. Call 01376 337400 to make an appointment.

Council Tax Band

D

EPC Rating:



Energy Efficiency Rating		
	Current	Potential
Very energy efficient - lower running costs		
(92 plus) A		
(81-91) B		
(69-80) C		
(55-68) D		
(39-54) E		
(21-38) F		
(1-20) G		
Not energy efficient - higher running costs		
England & Wales	EU Directive 2002/91/EC	