

OLD TOWER BUILDINGS, WAPPING, LONDON, E1W 2NT



£1,350.00 PCM

SITUATED IN A CHARMING PERIOD BUILDING IS THIS COMPACT ONE BEDROOM UNFURNISHED SECOND FLOOR FLAT. SITUATED IN A SOUGHT AFTER LOCATION CLOSE TO THE THAMES AND NOT FAR FROM WAPPING STATION. SUITABLE FOR A SINGLE TENANT.

EPC RATING C. COUNCIL TAX BAND A. DAMAGES DEPOSIT £1,350.00

- ONE BEDROOM
- LOUNGE
- FITTED KITCHEN
- SHOWER ROOM/WC
- ELECTRIC HEATING
- CONVENIENT LOCATION
- PERIOD BUILDING
- UNFURNISHED





Approx Gross Internal Area
26 sq m / 280 sq ft

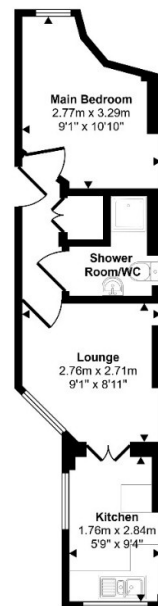

Floorplan

This floorplan is only for illustrative purposes and is not to scale. Measurements of rooms, doors, windows, and any items are approximate and no responsibility is taken for any error, omission or mis-statement. Icons of items such as bathroom suites are representations only and may not look like the real items. Made with Made Snappy 360.