

Fishguard Way, London, E16 2RZ



£1,600 Per Month

Enviably located along the banks of the River Thames, this sleek 2 bedroom flat offers bright interiors throughout, a chic reception room/kitchen and two elegant washrooms.

Fishguard Way is quiet residential address wonderfully located for the many amenities on offer in Gallions Reach.



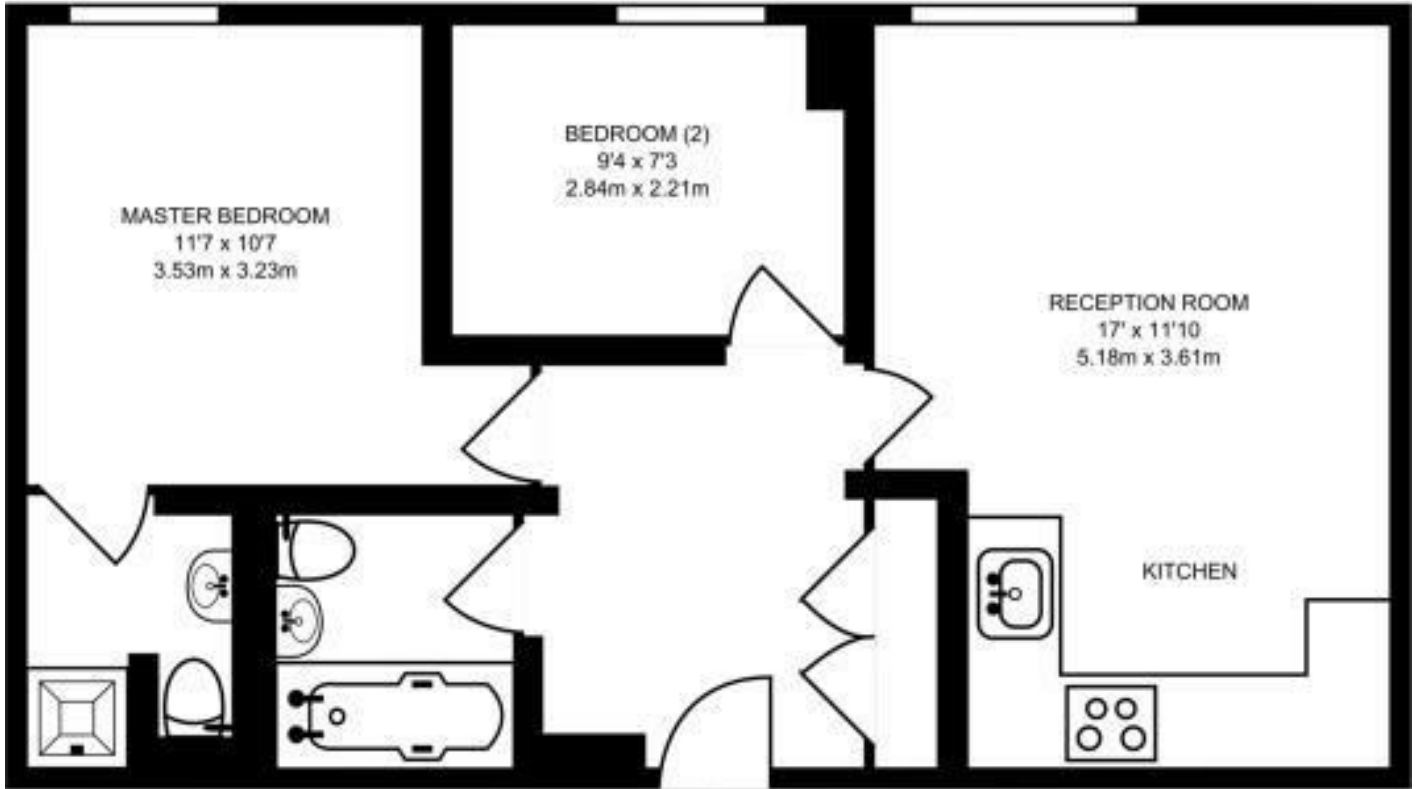

SECOND FLOOR
524 SQ FT/48.74 SQ M

This plan has been drawn for illustrative and identification purposes only.

Energy Efficiency Rating		Current	Potential
Very energy efficient - lower running costs			
(92 plus) A			
(81-91) B			
(69-80) C			
(55-68) D			
(39-54) E			
(21-38) F			
(1-20) G			
Not energy efficient - higher running costs			
England & Wales	EU Directive 2002/91/EC		

Environmental Impact (CO ₂) Rating		Current	Potential
Very environmentally friendly - lower CO ₂ emissions			
(92 plus) A			
(81-91) B			
(69-80) C			
(55-68) D			
(39-54) E			
(21-38) F			
(1-20) G			
Not environmentally friendly - higher CO ₂ emissions			
England & Wales	EU Directive 2002/91/EC		



Associated Offices in London, Essex and Hertfordshire

Kings Head Office Tudor Lodge, Burton Lane, Goffs Oak, Hertfordshire EN7 6SY Tel: 01707-872000

