

# FOLKLANDS



BRIGHTON ROAD, PURLEY  
GUIDE PRICE £257,500



















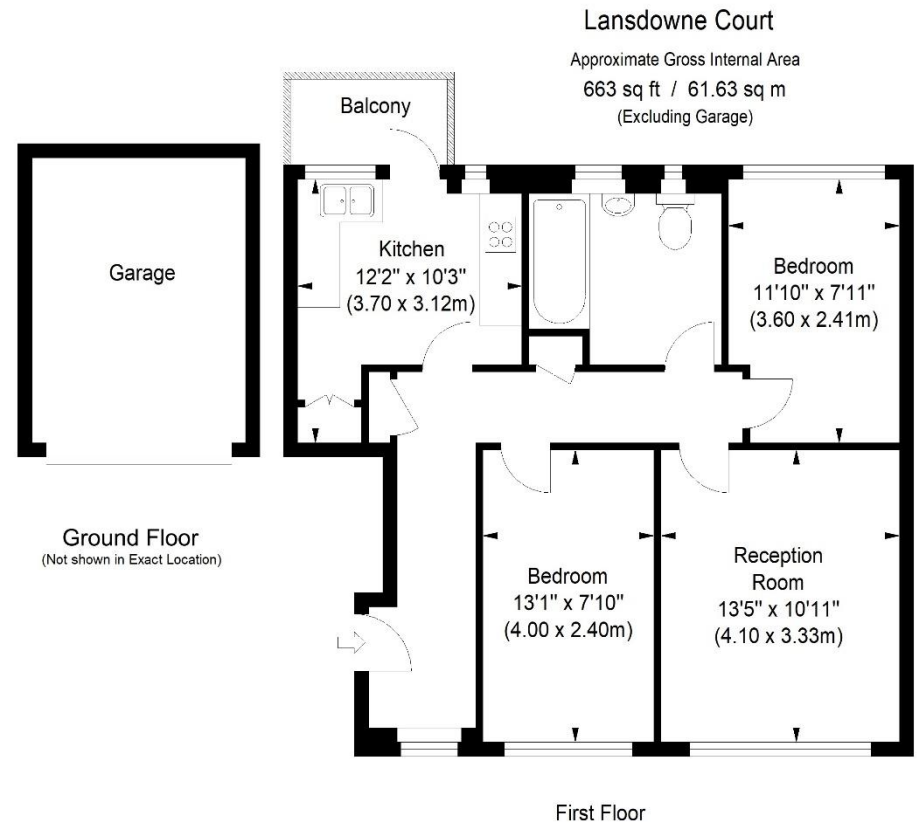

ILLUSTRATION FOR IDENTIFICATION PURPOSES ONLY

ALL MEASUREMENTS ARE MAXIMUM, AND INCLUDE WINDOW BAYS AND WARDROBES WHERE APPLICABLE  
THIS PLAN MUST NOT BE REPRODUCED BY ANY OTHER PERSON WITHOUT PERMISSION

INFO@FOLKLANDS.COM - 020 8686 0002

362 BRIGHTON ROAD - SOUTH CROYDON - CR2 6AL

- ❖ TWO DOUBLE BEDROOMS - FIRST FLOOR APARTMENT
- ❖ 1930'S ART DECO BUILDING
- ❖ LARGE GARAGE EN-BLOC
- ❖ BALCONY
- ❖ ULTRA LONG LEASE + SHARE OF FREEHOLD
- ❖ 0.4 MILES FROM PURLEY TRAIN STATION
- ❖ 0.5 MILES FROM PURLEY OAKS TRAIN STATION
- ❖ CHAIN FREE
- ❖ NEW CARPET & DECOR
- ❖ EPC EER C

**\*\* Chain Free \*\* Ultra Long Lease \*\* Private Garage En-Bloc \*\*** A smartly presented two double bedroom first floor flat forming part of this charming 1930's Art Deco apartment block, conveniently located 0.4 miles from Purley train station & 0.5 miles from Purley Oaks train station.

This bright & airy property is fully double glazed, it has gas central heating, it has been newly decorated and new carpet has been laid throughout. Additionally, there is ample storage, a large garage en-bloc, and there are well-maintained communal gardens across the whole development.

The accommodation comprises two double bedrooms, ample hallway storage, a spacious lounge/ dining room, a modern fitted kitchen with access onto the balcony, and a sizeable three-piece bathroom suite with a shower over-bath.

Furthermore, this property sits moments away from the open green spaces of the Rotary fields, it is nearby the local gym and is moments away from the plethora of shops, bars & restaurants in Purley town centre.



| Score | Energy rating | Current | Potential |
|-------|---------------|---------|-----------|
| 92+   | A             |         |           |
| 81-91 | B             |         |           |
| 69-80 | C             | 73 C    | 73 C      |
| 55-68 | D             |         |           |
| 39-54 | E             |         |           |
| 21-38 | F             |         |           |
| 1-20  | G             |         |           |