

Jonathan Hunt

ESTATE AGENCY

20 High Street Ware SG12 9BX

Tel: 01920 411090

8 High Street Buntingford SG9 9AG

Tel: 01763 272727

info@jonathan-hunt.co.uk

www.jonathanhunt.co.uk



Brambles Anstey, Buntingford, SG9 ODL

Price Guide £1,125,000

Brambles Anstey, Buntingford, SG9 ODL

Exceptional Six-Bedroom Detached Bungalow with Stunning Frontage in a Picturesque Village Setting

Set within a mature 1.25 acre (circa) plot with breathtaking countryside views, this substantial six-bedroom detached bungalow offers a rare opportunity to acquire a spacious and versatile home in a highly sought-after village location.

Approached via a sweeping driveway, the property boasts an impressive frontage and a well-balanced layout, ideal for modern family living. Inside, the expansive accommodation includes three reception rooms, two en-suite bedrooms (one featuring a wet room), and an open, flowing design that maximizes space and natural light.

The secluded, established gardens offer excellent privacy, perfect for relaxation and outdoor entertaining. A detached double garage and ample parking further enhance the appeal.

With scope for modernisation, extension, or remodelling, this home presents an exciting opportunity to create a bespoke residence, whether for multi-generational living, an annex, or a reimagined open-plan layout. Alternatively, it's ready to enjoy as a single-level retreat in an idyllic rural setting.

A truly exceptional opportunity to shape a dream home in an unbeatable location.



KITCHEN 22'1" x 14'11" (6.74 x 4.55)

KITCHEN pic 2

DINING ROOM 17'1" x 12'0" (5.21 x 3.66)

SHOWER ROOM 8'2" x 5'3" (2.51 x 1.62)

INNER HALLWAY 25'4" x 6'8" (7.73 x 2.04)

BEDROOM TWO 13'3" x 7'6" (4.05 x 2.3)

EN-SUITE (bed 2) 7'10" x 4'8" (2.39 x 1.43)

BOILER/LAUNDRY ROOM 7'10" x 6'0" (2.39 x 1.83)

PRINCIPAL BEDROOM 16'3" x 11'7" (4.96 x 3.55)

WET ROOM (bed 1) 7'10" x 7'10" (2.39 x 2.41)

STUDY AREA 9'9" x 8'2" (2.98 x 2.51)

LOUNGE 22'1" x 14'11" (6.74 x 4.55)

LOUNGE pic 2

BEDROOM SIX 9'10" x 8'3" (3.01 x 2.52)

BEDROOM FOUR 13'0" x 11'6" (3.98 x 3.52)

INNER LOBBY 16'9" x 8'2" (5.13 x 2.49)

BEDROOM FIVE 11'10" x 11'6" (3.63 x 3.51)

BEDROOM THREE 14'10" x 11'11" (4.54 x 3.65)

BATHROOM 8'0" x 7'11" (2.46 x 2.42)

DETACHED DOUBLE GARAGE 19'1" x 18'8" (5.84 x 5.7)

DRIVEWAY AND FRONT ASPECT

REAR GARDEN

REAR GARDEN part 2



Jonathan
Hunt
Estate Agency



Jonathan
Hunt
Estate Agency



Jonathan
Hunt
Estate Agency



Jonathan
Hunt
Estate Agency



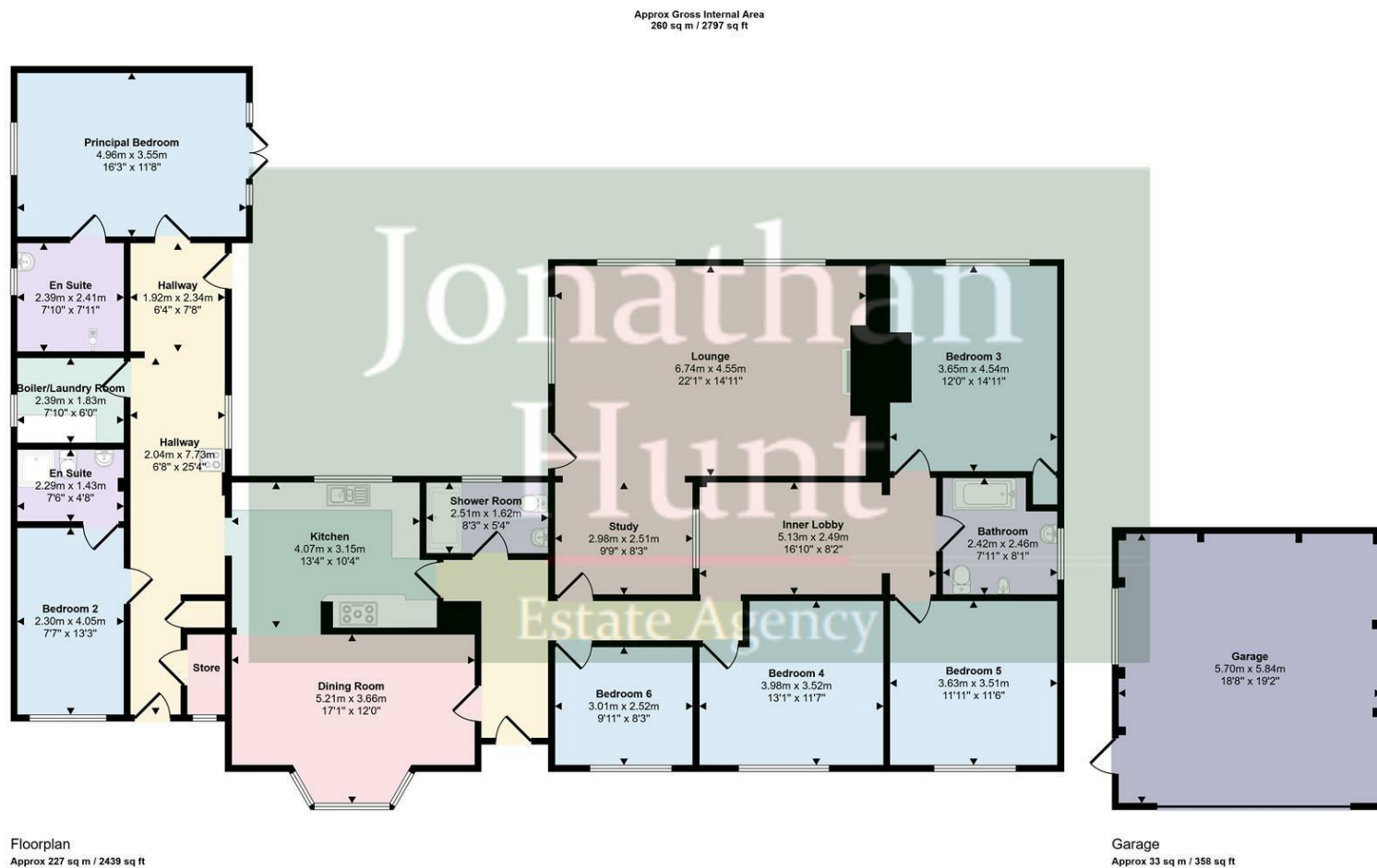

This floorplan is only for illustrative purposes and is not to scale. Measurements of rooms, doors, windows, and any items are approximate and no responsibility is taken for any error, omission or mis-statement. Icons of items such as bathroom suites are representations only and may not look like the real items. Made with Made Snappy 360.

