

Jonathan Hunt

ESTATE AGENCY

20 High Street Ware SG12 9BX

Tel: 01920 411090

8 High Street Buntingford SG9 9AG

Tel: 01763 272727

info@jonathan-hunt.co.uk

www.jonathanhunt.co.uk



73 Dray Gardens, Buntingford, SG9 9GG

Price Guide £665,000

73 Dray Gardens, Buntingford, SG9 9GG

Discover this stunning 5-bedroom detached modern home, perfectly situated in a peaceful cul-de-sac in a sought-after Buntingford development. Boasting contemporary design The property is immaculately presented throughout, The dual-aspect living room is a highlight, bathed in natural light and featuring expansive glazed doors that open directly onto the beautifully landscaped rear garden. At the heart of the home lies a stylish kitchen/breakfast room. Designed with both aesthetics and functionality in mind, it boasts extensive storage and generous workspace with space for dining.

The property features five well-proportioned bedrooms spread over three stories, ensuring ample space for all family sizes. Four of the bedrooms are doubles, including the principal suite, which benefits from a luxurious en-suite shower room. The additional bedrooms are served by a well-appointed family bathroom, ensuring convenience and comfort for all residents. A ground-floor cloakroom/WC further enhances the property's practicality.

Externally, the home is equally impressive. The rear garden, measuring approximately 44' x 40', is a true sanctuary. Lovingly maintained, it features manicured planting, mature shrubs, and a sunny aspect that makes it perfect for al fresco dining and outdoor enjoyment.

The property also offers excellent parking facilities, with a spacious driveway accommodating multiple vehicles. and a large single garage with electric door and "attic" storage in rafters.



ENTRANCE HALL

LOUNGE/DINER 24'0" x 10'11" (7.33 x 3.34)

LOUNGE/DINER pic 2

KITCHEN/BREAKFAST ROOM 19'3" x 10'3" (5.87 x 3.13)

KITCHEN/BREAKFAST pic 2

KITCHEN/BREAKFAST pic 3

CLOAKROOM

FIRST FLOOR

PRINCIPAL BEDROOM 14'11" x 11'0" (4.56 x 3.37)

EN-SUITE 10'11" x 3'10" (3.34 x 1.17)

BEDROOM FOUR 9'4" x 8'1" (2.86 x 2.48)

BEDROOM FIVE 7'10" x 6'6" (2.4 x 2)

FAMILY BATHROOM 6'7" x 5'8" (2.02 x 1.75)

SECOND FLOOR

BEDROOM TWO 13'8" x 11'1" (4.17 x 3.39)

BEDROOM THREE 13'7" x 8'0" (4.16 x 2.46)

REAR GARDEN



Jonathan
Hunt
Estate Agency



Jonathan
Hunt
Estate Agency



Jonathan
Hunt
Estate Agency



Jonathan
Hunt
Estate Agency



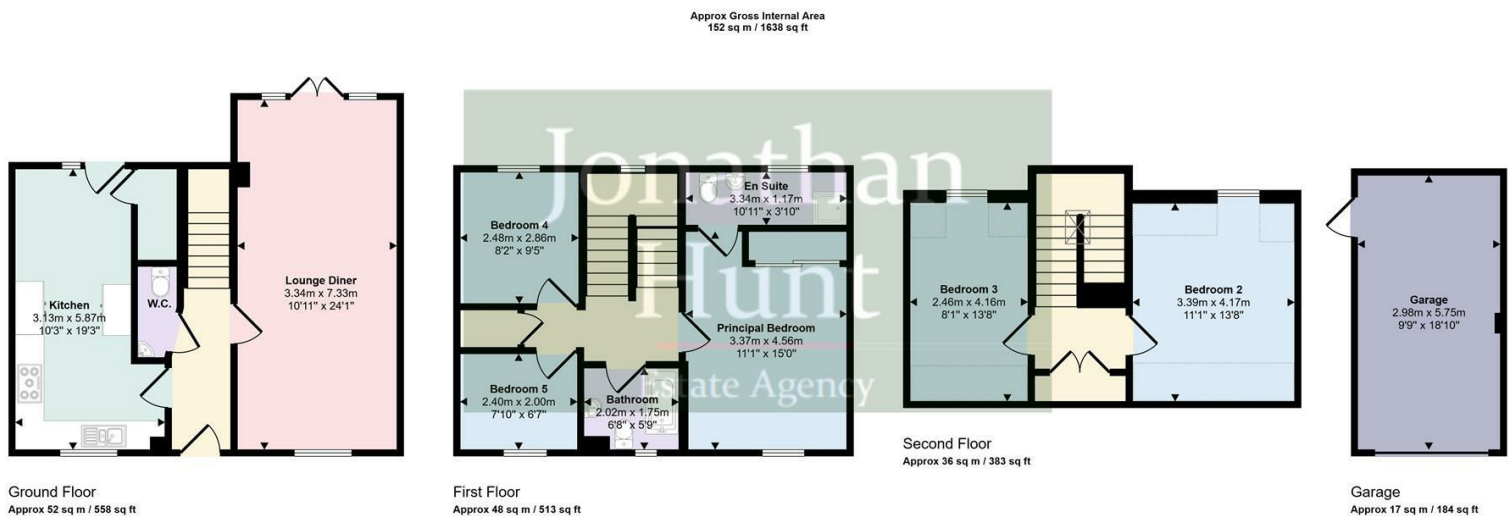

Denotes head height below 1.5m

This floorplan is only for illustrative purposes and is not to scale. Measurements of rooms, doors, windows, and any items are approximate and no responsibility is taken for any error, omission or mis-statement. Icons of items such as bathroom suites are representations only and may not look like the real items. Made with Made Snappy 360.

