

Jonathan Hunt

ESTATE AGENCY

20 High Street Ware SG12 9BX

Tel: 01920 411090

8 High Street Buntingford SG9 9AG

Tel: 01763 272727

info@jonathan-hunt.co.uk

www.jonathanhunt.co.uk



Jonathan

27 Porters Close, Buntingford, SG9 9BW

Price Guide £460,000

27 Porters Close, Buntingford, SG9 9BW

Locvated in the quiet cul-de-sac of Porters Close, this detached three-bedroom home offers a spacious and bright interior, perfect for modern living. Inside, you'll find an open-plan lounge diner, ideal for both relaxation and socializing. With three generously sized double bedrooms, there's plenty of space for family or guests. Off-street parking and a detached single garage provide convenience and security for your vehicles. Enjoy the tranquility of the neighborhood while still being close to town center amenities. And with excellent schooling nearby, this home offers comfort, convenience, and community. Don't miss the chance to make this your ideal home!



ENTRANCE HALL

LOUNGE 11'3" x 16'4" (3.43 x 4.98)

LOUNGE pic 2

DINING AREA 8'8" x 12'0" (2.65 x 3.68)

KITCHEN 7'6" x 10'2" (2.30 x 3.11)

KITCHEN pic 2

LANDING

BEDROOM ONE pic 1 9'7" x 15'3" (2.94 x 4.65)

BEDROOM ONE pic 2 9'7" x 13'2"

BEDROOM TWO pic 1

BEDROOM TWO pic 2 2.93 x 4.02

BEDROOM THREE 6'9" x 10'1" (2.08 x 3.08)

BATHROOM

REAR GARDEN

GARAGE GAMES ROOM/BAR



Jonathan
Hunt
Estate Agency



Jonathan
Hunt
Estate Agency



Jonathan
Hunt
Estate Agency



Jonathan
Hunt
Estate Agency



Approx Gross Internal Area
90 sq m / 972 sq ft

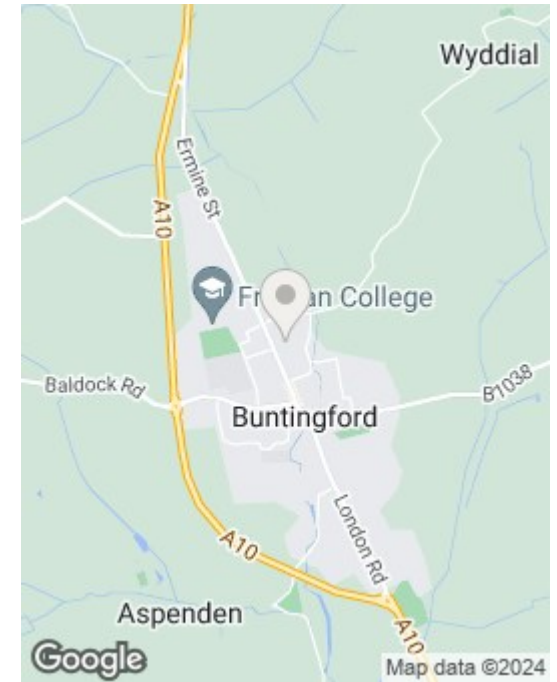
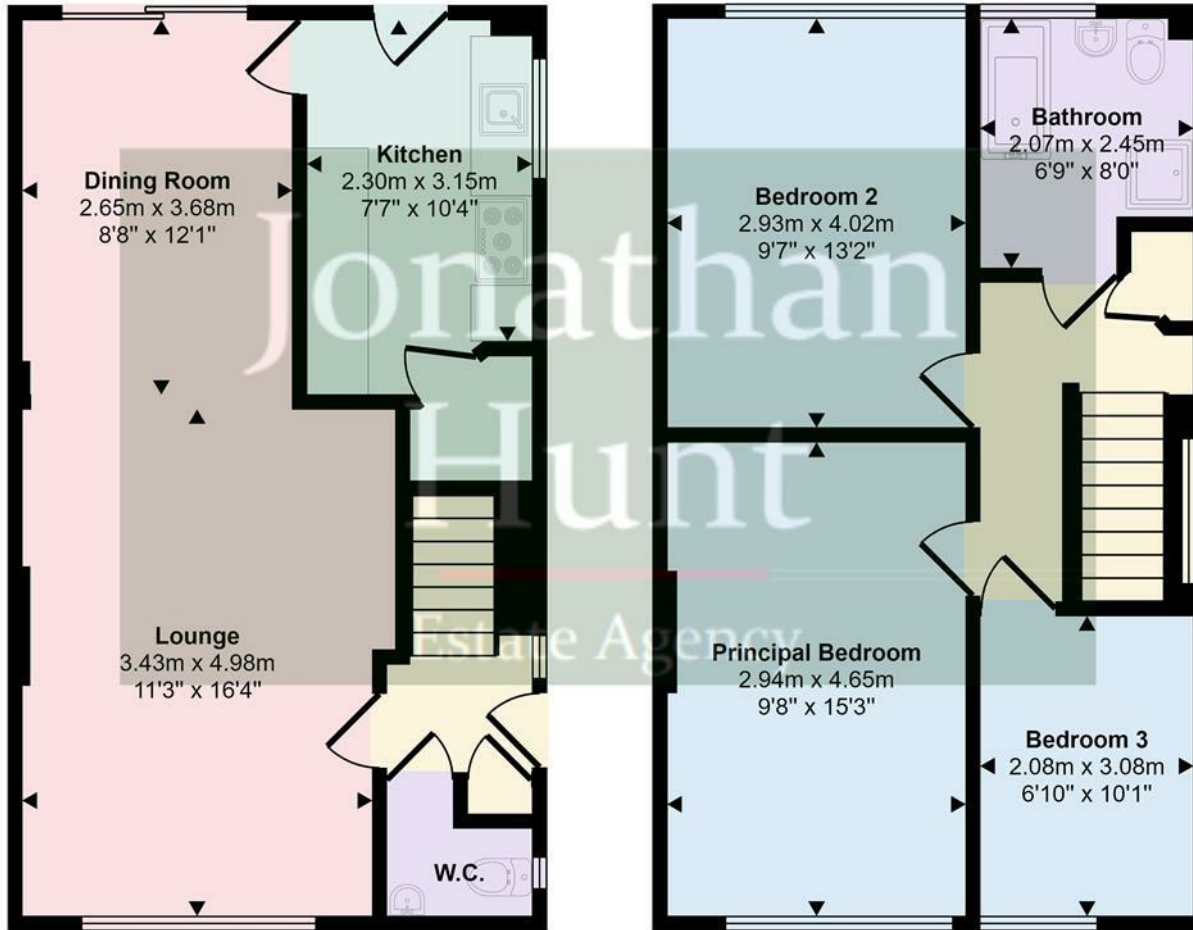

Ground Floor
Approx 44 sq m / 478 sq ft

First Floor
Approx 46 sq m / 494 sq ft

This floorplan is only for illustrative purposes and is not to scale. Measurements of rooms, doors, windows, and any items are approximate and no responsibility is taken for any error, omission or mis-statement. Icons of items such as bathroom suites are representations only and may not look like the real items. Made with Made Snappy 360.

