





Description

O'Malley Property are pleased to present to the market, this spacious two bedroom, ground floor flat located in Cragganmore, Tullibody.

Upon entering, you are welcomed with an entrance vestibule that leads directly into the lounge space. The lounge is generously proportioned and benefits from a large front-facing window that allows an abundance of natural light to pour into the space throughout the day. Adjacent to the lounge is the fitted kitchen, which has been thoughtfully designed to make the most of the available space. It features a range of wall and base units in a contemporary finish, providing excellent storage options.

Both bedrooms are well-sized doubles, each with built-in wardrobes that help maximise floor space and reduce the need for freestanding storage. The second bedroom, located to the rear, also enjoys garden views and could serve as a guest room, home office, or hobby room depending on the buyer's needs. Both rooms are decorated in neutral tones and benefit from plenty of natural light. The bathroom features a white three-piece suite comprising a bath with an overhead shower.



Externally, the property enjoys an allocated parking bay located outside the property. To the rear, the property enjoys a communal garden space which is laid to lawn throughout.

“Spacious Property”

Location

Cragganmore is a quiet and established development within Tullibody, a town that continues to grow in popularity thanks to its strong community feel and proximity to key transport links. The property is ideally situated for access to local amenities, including a range of convenience stores, supermarkets, cafes, and takeaways.

Living Room

14'11" x 11'1"

Kitchen

9'5" x 8'2"

Bedroom 1

12'2" x 8'6"

Bedroom 2

10'1" x 8'9"

Bathroom

6'7" x 5'6"

Home Report

The home report is available upon request.

Fixtures & Fittings

All floor coverings, light fittings and integrated appliances are included with the sale.



Offers Over £99,995

Viewing 9am - 9pm 7 days a week

GROUND FLOOR

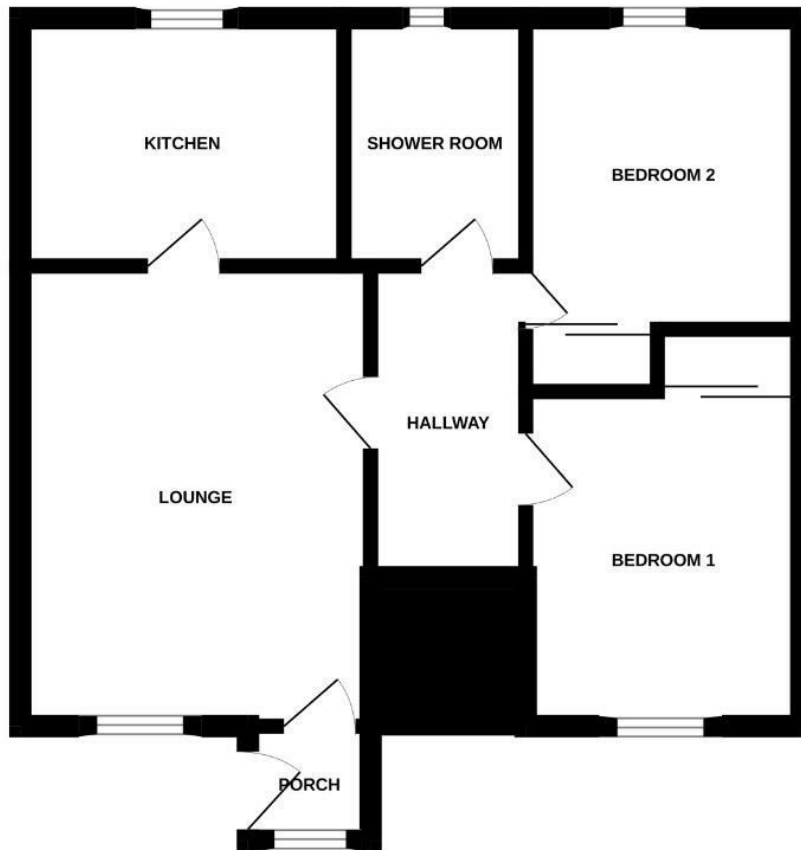

Whilst every attempt has been made to ensure the accuracy of the floorplan contained here, measurements of doors, windows, rooms and any other items are approximate and no responsibility is taken for any error, omission or mis-statement. This plan is for illustrative purposes only and should be used as such by any prospective purchaser. The services, systems and appliances shown have not been tested and no guarantee as to their operability or efficiency can be given.
Made with Metropix ©2025



Property Misdescriptions Act 1991.
While these particulars have been carefully compiled and are believed to be accurate, no warranty is given in this respect and potential purchasers should satisfy themselves as to any points arising therefrom. None of the items included in the sale of working or running nature such as central heating installation or mechanical or electrical equipment have been tested by us and no warranty is given in this respect and potential purchasers should satisfy themselves as to any points arising therefrom. Any photographs used are purely illustrative and may demonstrate only the surroundings. They are not therefore taken as indicative of the extent of the property, or that the photograph is taken from within the boundaries of the property, or of what is included in the sale.