



 **O'MALLEY**

11 Taran
Alloa, FK10 1RF

omalleyproperty.com
01259212337



Description

O'Malley Property is proud to present to the market this beautifully presented three-bedroom family home, situated in the desirable area of Taran, Alloa.

Upon entering, you are welcomed by a bright and airy lounge, perfect for relaxing with family or entertaining guests. The lounge flows seamlessly into the open-plan kitchen/diner, which boasts modern fittings and ample space for dining, making it the heart of the home. Completing the ground floor is a convenient WC.

The first floor features three well-proportioned bedrooms, including a master bedroom with an en-suite, providing privacy and comfort. A stylish family bathroom services the additional two bedrooms. The property further benefits from a storage cupboard on the landing.

Outside, there is a private driveway offering off road parking. The south facing, rear garden has been recently landscaped to a high standard, offering low maintenance throughout. The free standing shed, which features power, will be included within the sale.



“Spacious Property”

Location

Taran, Alloa, is a peaceful residential area with easy access to local amenities, schools, and transport links. The town offers a good mix of shops, cafes, and leisure facilities, with scenic parks and walking routes nearby. Well-connected to Stirling, Edinburgh, and Glasgow, it's a convenient and welcoming place to live.

Lounge

14'3" x 13'1"

Kitchen diner

9'8" x 16'9"

W/C

3'3" x 4'11"

Bedroom 1

9'11" x 9'11"

Ensuite

5'7" x 4'4"

Bedroom 2

9'10" x 8'7"

Bedroom 3

7'10" x 8'11"

Home Report

The home report is available upon request.

Fixtures & Fittings

All floor coverings, light fittings and integrated appliances are included with the sale. The free standing washing machine and shed will also be included within the sale.



Offers Over £199,995

Viewing 9am - 9pm 7 days a week

GROUND FLOOR

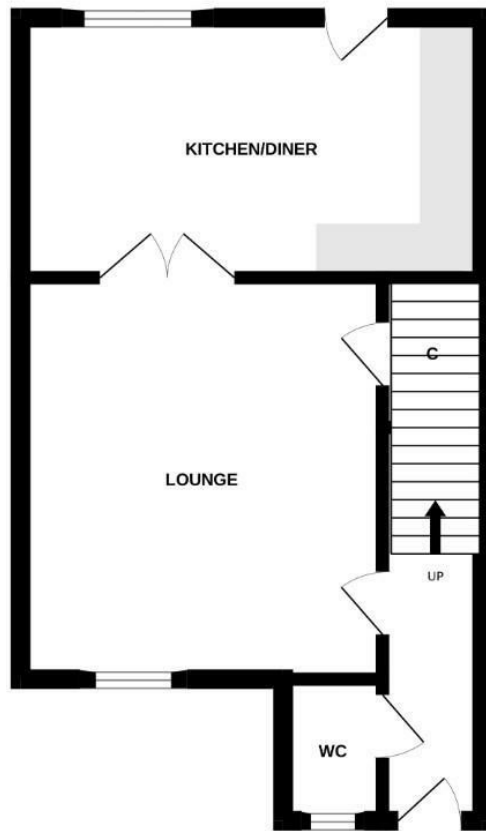

1ST FLOOR

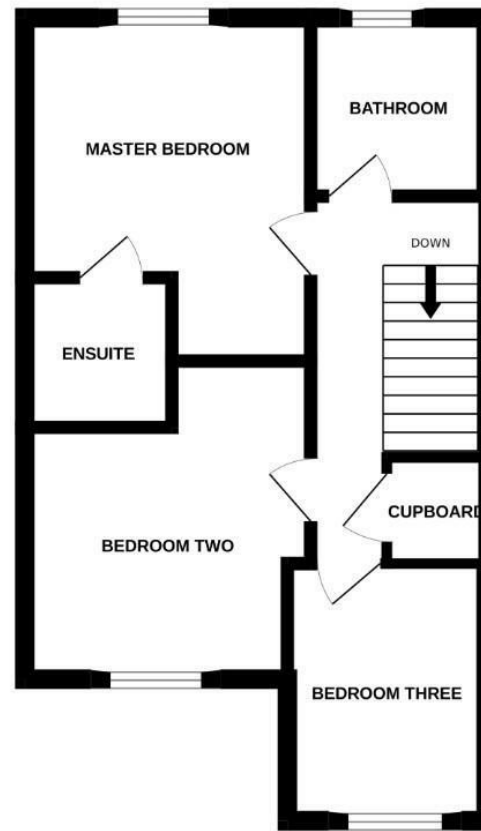

Whilst every attempt has been made to ensure the accuracy of the floorplan contained here, measurements of doors, windows, rooms and any other items are approximate and no responsibility is taken for any error, omission or mis-statement. This plan is for illustrative purposes only and should be used as such by any prospective purchaser. The services, systems and appliances shown have not been tested and no guarantee as to their operability or efficiency can be given.
Made with Metropix ©2025



Property Misdescriptions Act 1991.
While these particulars have been carefully compiled and are believed to be accurate, no warranty is given in this respect and potential purchasers should satisfy themselves as to any points arising therefrom. None of the items included in the sale of working or running nature such as central heating installation or mechanical or electrical equipment have been tested by us and no warranty is given in this respect and potential purchasers should satisfy themselves as to any points arising therefrom. Any photographs used are purely illustrative and may demonstrate only the surroundings. They are not therefore taken as indicative of the extent of the property, or that the photograph is taken from within the boundaries of the property, or of what is included in the sale.