



 **O'MALLEY**

6 Acorn Drive
Alloa, FK10 2QB

omalleyproperty.com
01259212337



Description

O'Malley Property are proud to present to the market, this two bedroom, mid terrace house located in Acorn Drive, Tullibody.

Situated in a quiet and well-established residential area, this well-presented home offers an excellent opportunity for first-time buyers, small families, or investors.

Upon entering, you are welcomed by a bright entrance hallway with a convenient ground-floor WC. The generous living room is well-lit, creating a warm and inviting atmosphere, leading seamlessly into the kitchen/diner at the rear. The kitchen/diner area offers ample space for entertaining and benefits from direct access to the garden, perfect for indoor-outdoor living. The kitchen is equipped with wall and base mounted units with complementary worktops, along with space for free standing appliances.

Upstairs, the property features two well-proportioned bedrooms. The main bedroom is spacious and benefits from a built-in storage cupboard, while the second bedroom includes a fitted wardrobe, offering excellent storage solutions. The stylish family bathroom is located off the landing and is fitted with a modern suite.

Externally, the home enjoys a private rear garden, ideal for relaxation and outdoor activities. The front of the property provides a welcoming entrance with an off street parking space.

“Spacious Property”

Location

Acorn Drive in Tullibody is a sought-after residential area known for its modern housing and proximity to local amenities. The area benefits from excellent transport links, with close proximity to Stirling and Alloa, making commuting straightforward. Local schools, parks, and shopping facilities are easily accessible, contributing to the community's family-friendly environment. The combination of modern living spaces, scenic surroundings, and convenient amenities makes Acorn Drive a highly desirable place to reside.

Living room

14'6" x 13'7"

Kitchen/Diner

14'4" x 8'2"

W.C

6'6" x 3'2"

Bedroom 1

12'3" x 11'8"

Bedroom 2

10'2" x 8'0"

Bathroom

6'6" x 6'0"

Home report

The home report is available upon request.

Fixtures & Fittings

All carpets, light fittings, floor coverings and integrated appliances are included with the sale.



Offers Over £164,995

Viewing 9am - 9pm 7 days a week

GROUND FLOOR

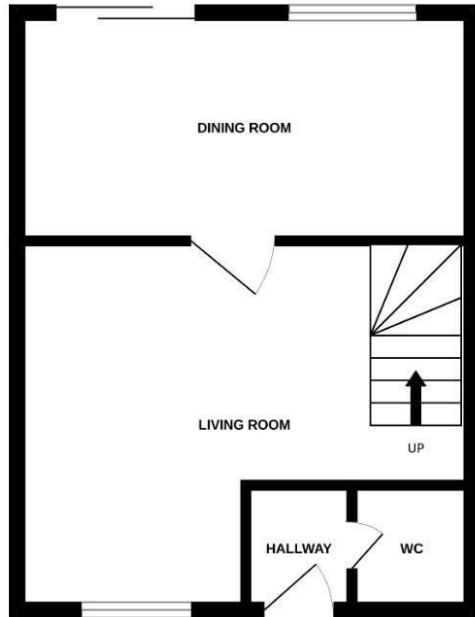

1ST FLOOR

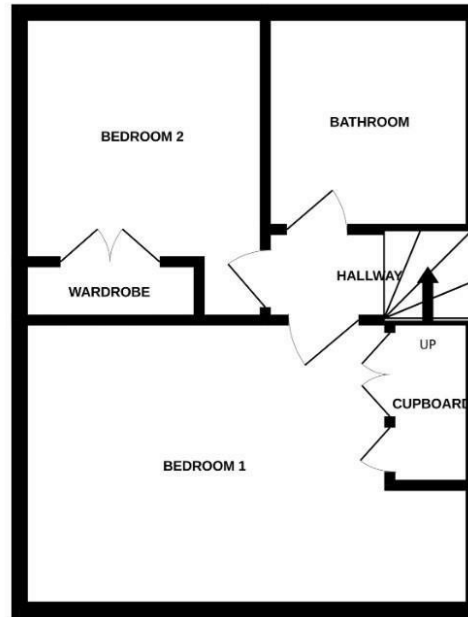

Whilst every attempt has been made to ensure the accuracy of the floorplan contained here, measurements of doors, windows, rooms and any other items are approximate and no responsibility is taken for any error, omission or mis-statement. This plan is for illustrative purposes only and should be used as such by any prospective purchaser. The services, systems and appliances shown have not been tested and no guarantee as to their operability or efficiency can be given.
Made with Metropix ©2025



Property Misdescriptions Act 1991.
While these particulars have been carefully compiled and are believed to be accurate, no warranty is given in this respect and potential purchasers should satisfy themselves as to any points arising therefrom. None of the items included in the sale of working or running nature such as central heating installation or mechanical or electrical equipment have been tested by us and no warranty is given in this respect and potential purchasers should satisfy themselves as to any points arising therefrom. Any photographs used are purely illustrative and may demonstrate only the surroundings. They are not therefore taken as indicative of the extent of the property, or that the photograph is taken from within the boundaries of the property, or of what is included in the sale.