



Caro Point, 5 Gatliff Road  
London SW1W

GARTONJONES.COM

# Caro Point, 5 Gatliff Road London, SW1W

## £575 Per Week

GARTON JONES.COM

8 Gatliff Road  
Grosvenor  
Waterside  
Chelsea  
London  
SW1W 8DP

Lettings:  
+44 (0) 20 7730 5007  
gws@gartonjones.com  
www.gartonjones.com

A Manhattan style STUDIO apartment to RENT of approx. 367 sq.ft (34.1 sq.m) in Caro Point, Grosvenor Waterside development in Chelsea. The apartment has wood flooring and an open plan reception room with an integrated kitchen, and sliding door to bedroom. There is very good storage including a utility cupboard housing a washer/dryer and built in wardrobes to the bedroom and there is a modern shower room. Residents also benefit from 24 HOUR CONCIERGE, GYM & SPA. On-site Sainsbury's Local, coffee shop and private kids club. SLOANE SQUARE & VICTORIA Station with Gatwick Express are within walking distance. Battersea Park is also just a short stroll away across Chelsea Bridge.

Available via Garton Jones on-site office at Grosvenor Waterside (underneath Bramah House).

Please note the furniture may differ or not be included to that shown in current photos.

Council Tax: Westminster Council (band D).

12 month minimum term. 5 week deposit required.

EPC Rating: C (79)

To check broadband and mobile phone coverage, please visit Ofcom: [ofcom.org.uk/phones-telecoms-and-internet/advice-for-consumers/advice/ofcom-checker](https://www.ofcom.gov.uk/phones-telecoms-and-internet/advice-for-consumers/advice/ofcom-checker)

- 367 Sq.ft (34.1 Sq.m)
- Manhattan Style Studio Apartment
- Open Plan Reception Room
- Integrated Kitchen
- Shower Room
- 24 Hour Concierge
- Good Storage
- Smart Leisure Suite With Gym & Spa Facilities
- On-Site Sainsbury's & Close to Sloane Square Transport Links & Amenities



**Caro Point**

Approximate Gross Internal Area = 367 sq ft / 34.1 sq m

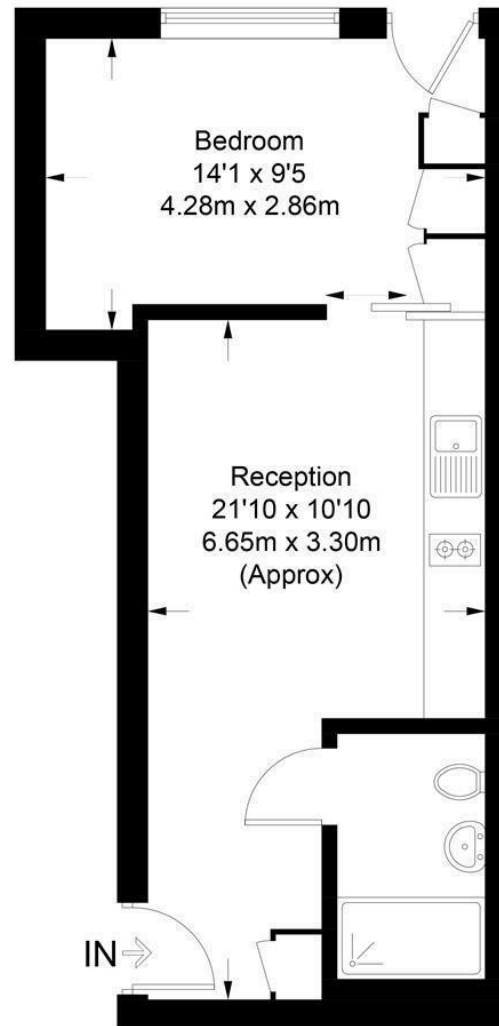

01 2004 10 01 1000



