



Woods House, 7 Gatliff Road
London SW1W

GARTONJONES.COM



Woods House, 7 Gatliff Road
London, SW1W

£131,250 Leasehold

GARTON JONES.COM

8 Gatliff Road
Grosvenor
Waterside
Chelsea
London
SW1W 8DP

Sales +44 (0) 20 7730 5007
gws@gartonjones.com
www.gartonjones.com

A ONE DOUBLE BEDROOM apartment for sale (25% share - rent rent £943.61 per month) of approx. 485 sq.ft (45.05 sq.m) in Woods House, one of the buildings forming the popular Grosvenor Waterside development in Chelsea. The apartment has an open plan reception room with a Juliette style balcony, with partial river views, a modern kitchen and bathroom and storage including built in wardrobes to the bedroom.

Our office is on-site at Grosvenor Waterside (underneath Bramah House) and there is also an on-site Sainsbury's Local, a coffee shop, crèche and Purple Dragon private kids club. The additional amenities including shops, restaurants and the excellent transport links of both Sloane Square and Victoria are within walking distance.

EWS1 Completed

Service Charges: approx. £376.89 per month (subject to annual review) inclusive of hot & cold water, CH & boiler breakdown cover.

Leasehold — 125 years from 2009 (approx. 112 years remaining)

EPC Rating: B

Westminster City Council (band D)

EPC certificate available on request.

- 485 Sq.ft (45.05 Sq.m)
- 1 Double Bedroom
- Open Plan Reception Room
- Modern Kitchen
- Bathroom
- 24 Hour Concierge
- Juliette Style Balcony
- On-Site Sainsbury's, Coffee Shop & Bakery, Purple Dragon Private Kids Club & Crèche
- Close to Local Shops and Amenities
- Walking Distance To Sloane Square and Victoria Station



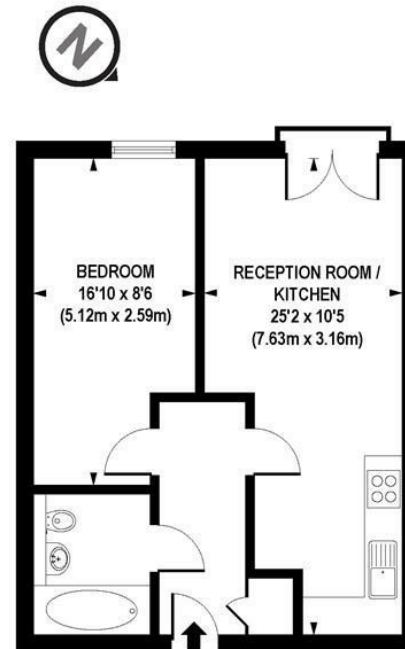

APPROX. GROSS INTERNAL FLOOR AREA 485 sq. ft / 45.05 sq. m

Floorplan is for illustrative purposes only and is not to scale.
Every attempt has been made to ensure the accuracy of the floorplan shown, however all measurements,
fixtures, fittings and data shown are an approximate interpretation for illustrative purposes only.
Liability for errors, omissions or mis-statement through negligence or otherwise is hereby excluded.

CP CREATIVE
PROPERTY MARKETING

