



Hirst Court, 20 Gatliff Road
London SW1W

GARTONJONES.COM

Hirst Court, 20 Gatliff Road London, SW1W

£670 Per Week

IMMEDIATELY AVAILABLE. A bright and spacious ONE DOUBLE BEDROOM apartment to rent of approx. 625 sq.ft (58 sq.m). Hirst Court, Grosvenor Waterside, located close to the banks of the River Thames by Chelsea Bridge. This FURNISHED apartment has 2 Juliette style balconies overlooking the docks. There is an open plan reception room with floor to ceiling windows and a modern kitchen with integrated appliances, a guest cloakroom and an en-suite bathroom with a separate shower plus a separate guest cloak room. There is wood flooring and good storage including built in wardrobes to the bedroom and a utility cupboard housing a washer dryer. There is comfort cooling and UNDERGROUND PARKING can also be included. Residents have the use of 24-HOUR CONCIERGE, GYM & SPA. On-site Sainsbury's Local, coffee shop and private kids club. SLOANE SQUARE & VICTORIA station with Gatwick Express are within walking distance.

Available via Garton Jones' on-site office at Grosvenor Waterside (underneath Bramah House).

Please note the furniture may differ or not be included to that shown in current photos.

Council Tax: Westminster City Council (band E)

12 month minimum term. 5 week deposit required.

EPC Rating: B (86)

- 625 Sq.ft (58 Sq.m)
- 1 Double Bedroom
- Modern Bathroom
- Open Plan Reception Room
- Kitchen With Miele Integrated Appliances
- 2 Juliette Balconies With Dock Views
- 24 Hour Concierge & Secure Underground Parking
- On-Site Sainsbury's, Coffee Shop & Bakery, Purple Dragon Private Kids Club & Crèche
- On-Site Residents' Leisure Suite With Gym & Spa Facilities
- Walking Distance To Sloane Square & Victoria Station

GARTON JONES.COM

8 Gatliff Road
Grosvenor
Waterside
Chelsea
London
SW1W 8DP

Lettings:
+44 (0) 20 7730 5007
gws@gartonjones.com
www.gartonjones.com



Hirst Court



Approximate Gross Internal Area = 625 sq ft / 58 sq m

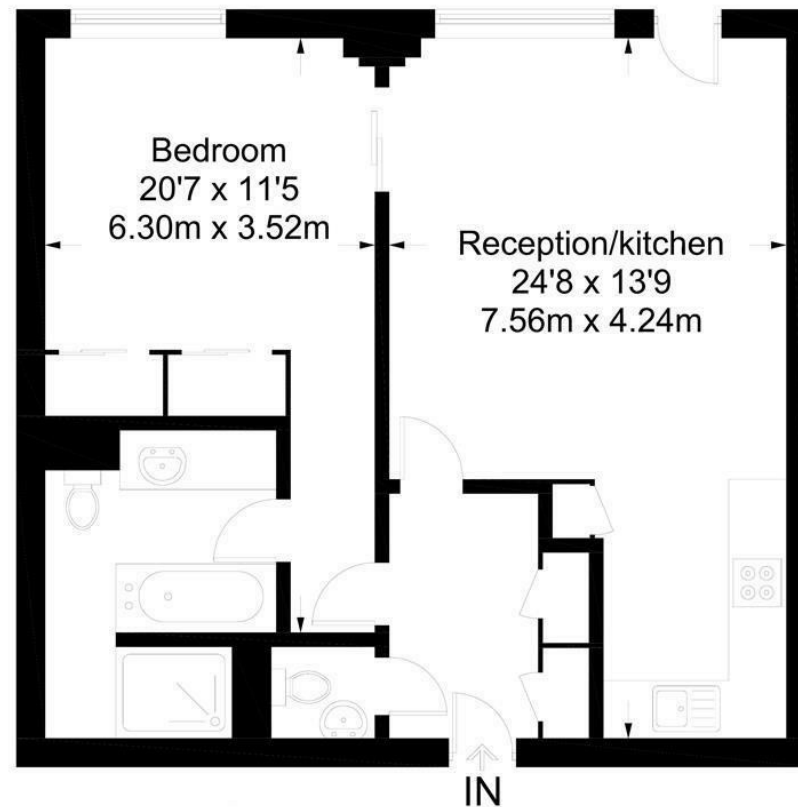

Not to scale, for guidance only and must not be relied upon as a statement of fact.
All measurements and areas are approximate only and have been prepared in
accordance with the current edition of the RICS Code of Measuring Practice.

