



Chelsea Gate Apartments, Chelsea  
London SW1W

GARTONJONES.COM



# Chelsea Gate Apartments, Chelsea London, SW1W

## £1,190,000 Leasehold

A spacious TWO DOUBLE BEDROOM apartment for sale of approx. 928sq.ft (86sq.m). The development is located close to the River Thames and Chelsea Bridge. This spacious apartment has a large dual aspect reception room, a separate kitchen, a BALCONY, TWO BATHROOMS (one en-suite) and built in wardrobes to both bedrooms. PARKING, 24 HOUR CONCEIRGE and GYM. The development is situated opposite Sainsbury's Local, coffee shop, and private kids club. SLOANE SQUARE and VICTORIA station with link to the Gatwick Express are within walking distance. Please note furniture may differ or not be included to that shown in the current photos.

Available via our on-site office at Grosvenor Waterside (underneath Bramah House).

Council Tax: Westminster City Council (band) G)

Leasehold: approx. 970 years remaining  
Ground Rent: TBC  
Service Charges: TBC

EPC rating: B (84)

EPC certificate available on request.

- 928sq.ft (86sq.m)
- 2 Double Bedrooms
- Large Dual Aspect Reception Room
- Separate Kitchen
- 2 Bathrooms (1 En-Suite)
- 24 Hour Concierge
- Balcony
- Residents' Gym
- Sloane Square & Victoria Are Within Walking Distance

## GARTON JONES.COM

8 Gatliff Road  
Grosvenor  
Waterside  
Chelsea  
London  
SW1W 8DP

Sales +44 (0) 20 7730 5007  
gws@gartonjones.com  
www.gartonjones.com



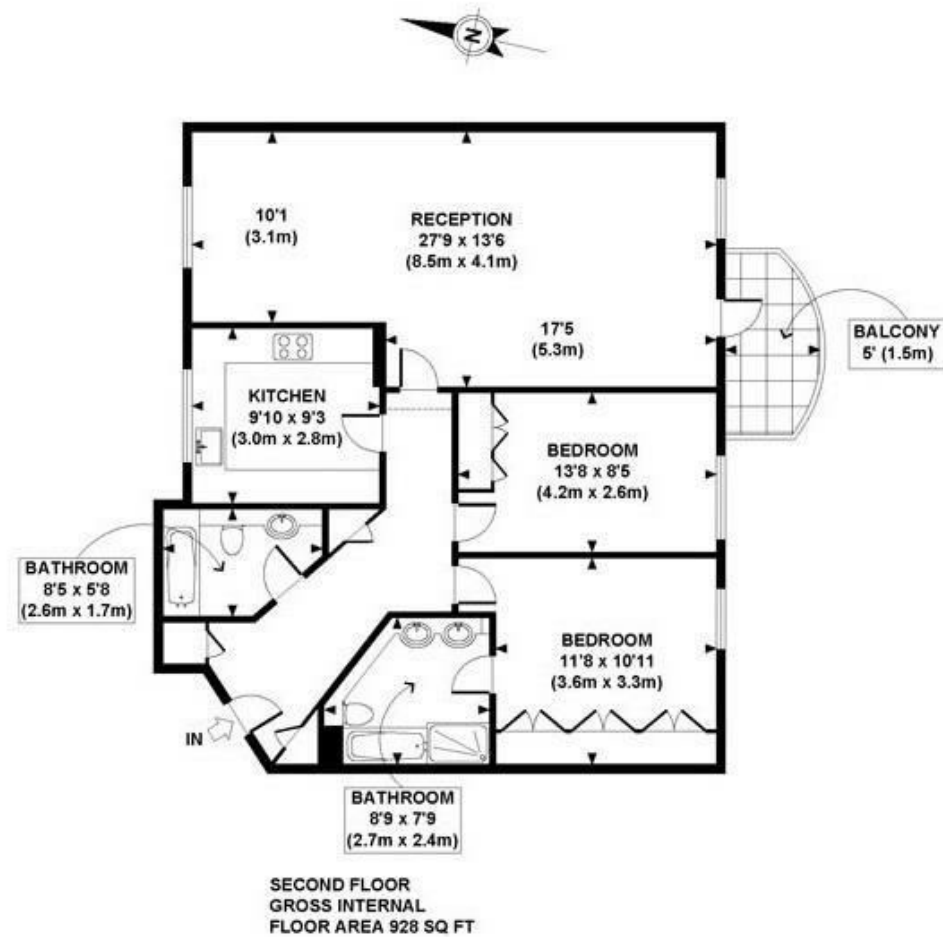

APPROX. GROSS INTERNAL FLOOR AREA 928 SQ FT / 86 SQ M

