

bear

Estate Agents



* PLEASE REQUEST A VIEWING ONLINE RIGHTMOVE BY CLICKING EMAIL AGENT AND SUBMITTING AN APPLICATION FORM * A well-located one bedroom first floor flat minutes away from Southend Town Centre. The location makes it perfect for commuters.

- One-bedroom first-floor flat to let
- Bright and airy open-plan kitchen/living room
- Three-piece suite bathroom
- Short walk to Southend Victoria Station
- Please request a viewing online via Rightmove by clicking email agent
- Ready to move straight into
- Generously sized bedroom
- Close proximity to Southend Town Centre
- Walking distance to Southend seafront and parks
- Double glazing and gas central heating

London Road

Southend-on-Sea

£1,050



London Road



Bear Lettings are pleased to offer this recently renovated one bedroom first floor flat located on London Road, Southend-on-Sea. Stylishly presented throughout, the property boasts a bright and modern interior, including a beautifully finished three piece bathroom, fresh décor and attractive wood effect flooring. The generously sized double bedroom offers plenty of natural light, while the open-plan layout provides a comfortable and practical living space.

Ideally positioned just moments from Southend Town Centre, Southend Victoria Station and the seafront, this home is perfect for commuters.

Kitchen/Living Room

15'0 x 14'1

Bedroom

12'5 x 10'6

Bathroom



Floor Plan

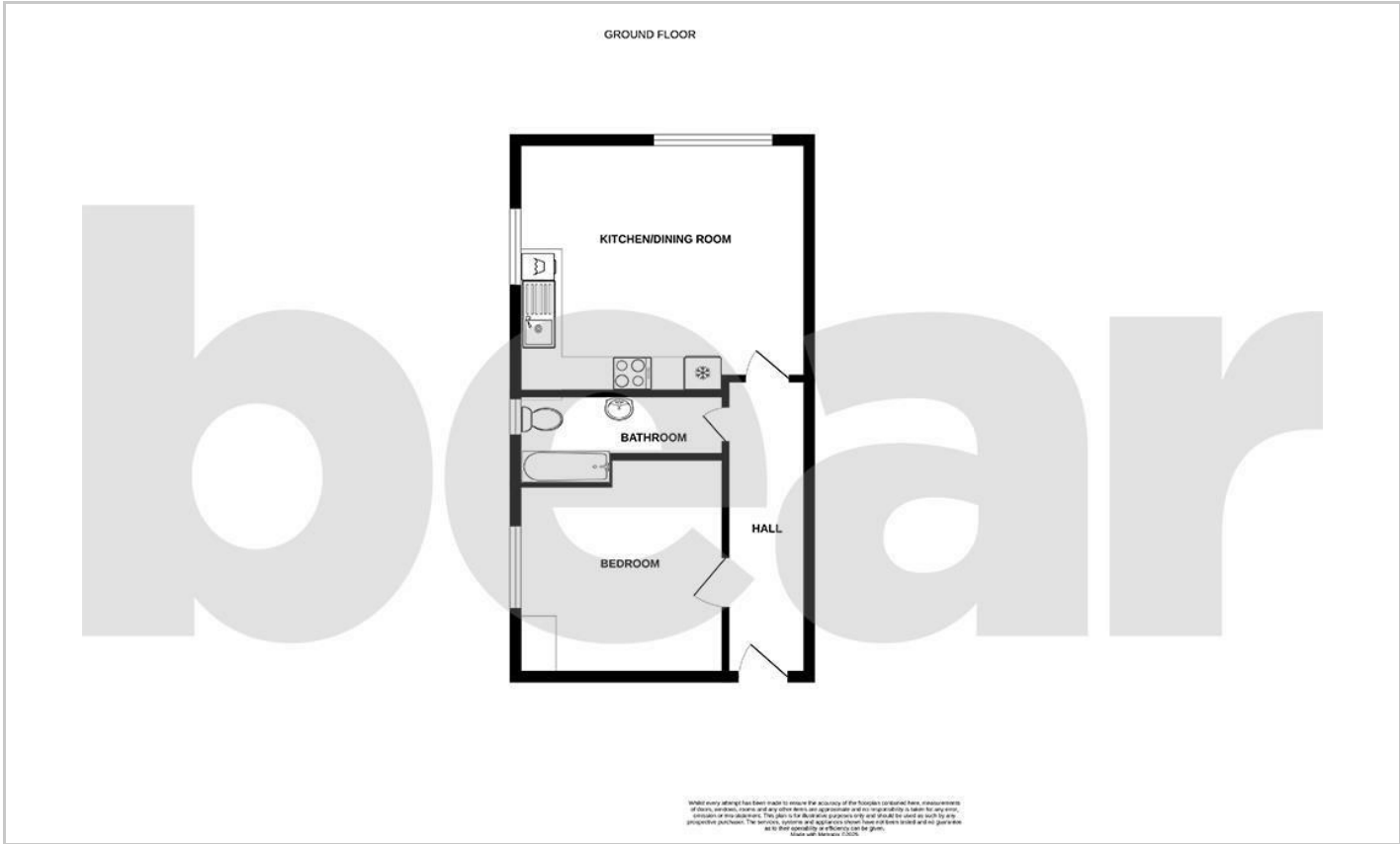

Area Map

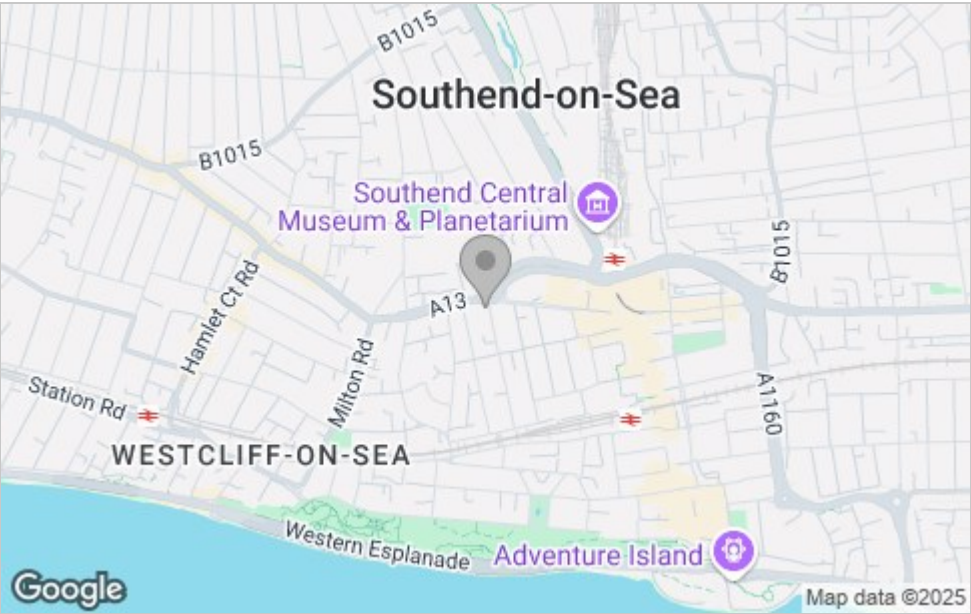

Viewing

Please contact our Southend-on-Sea Office on 01702 899 780 if you wish to arrange a viewing appointment for this property or require further information.

Energy Efficiency Graph

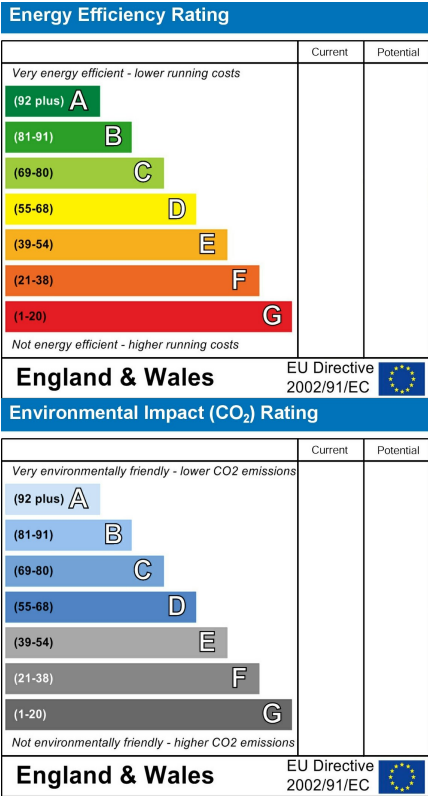

These particulars, whilst believed to be accurate are set out as a general outline only for guidance and do not constitute any part of an offer or contract. Intending purchasers should not rely on them as statements of representation of fact, but must satisfy themselves by inspection or otherwise as to their accuracy. No person in this firm's employment has the authority to make or give any representation or warranty in respect of the property.

204 Woodgrange Drive, Southend-on-Sea, Essex, SS1 2SJ

Office: 01702 899 780 info@bearlettings.co.uk