



Webbs
Helping people move since 1994

Turton Close | Walsall | WS3 3XY
Offers Over £200,000

 **Webbs**
estate agents

Summary

****TWO BEDROOM HOME**TURNBERRY ESTATE**KITCHEN DINER**PARKING TO THE FRONT**LANDSCAPED REAR GARDEN**PERFECT FIRST TIME BUY OR INVESTMENT**FITTED KITCHEN**FITTED BATHROOM**CUL-DE-SAC LOCATION**VIEWING ESSENTIAL****

Nestled in a tranquil cul-de-sac on the highly regarded Turnberry Estate, this modern two-bedroom end terrace house on Turton Close offers a delightful living experience in Walsall. The property boasts a well-proportioned reception room, perfect for both relaxation and entertaining, alongside a contemporary kitchen that caters to all your culinary needs.

The two bedrooms are generously sized, providing ample space for rest and personalisation, while the bathroom is fitted with modern fixtures, ensuring comfort and convenience. This home is ideal for small families, couples, or individuals seeking a peaceful retreat in a vibrant community.

The location is particularly advantageous, with easy access to a variety of local amenities, including shops, schools for children of all ages, and places of worship. The area is well-served by frequent

Key Features

- TWO BEDROOM HOME
- LANDSCAPED REAR GARDEN
- CUL-DE-SAC LOCATION
- PERFECT FIRST TIME BUY OR INVESTMENT
- FITTED BATHROOM
- PARKING TO THE FRONT
- KTICHEN DINER
- POPULAR TURNBERRY ESTATE
- FITTED KITCHEN
- CALL WEBBS TO SECURE YOUR VIEWING ON 01922 663399!!

Rooms and Dimensions

Entrance Hall

Lounge

13'1" x 9'10" (4m x 3m)

Kitchen Diner

13'6" x 8'5" (4.12m x 2.57m)

First Floor Landing

Bedroom One

13'6" x 11'9" (4.12m x 3.6m)

Bedroom Two

10'2" x 6'6" (3.1m x 2m)

Bathroom

Identification Checks B





GROUND FLOOR

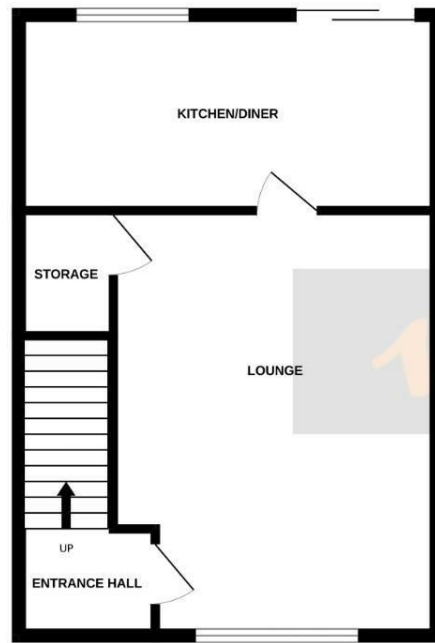

1ST FLOOR

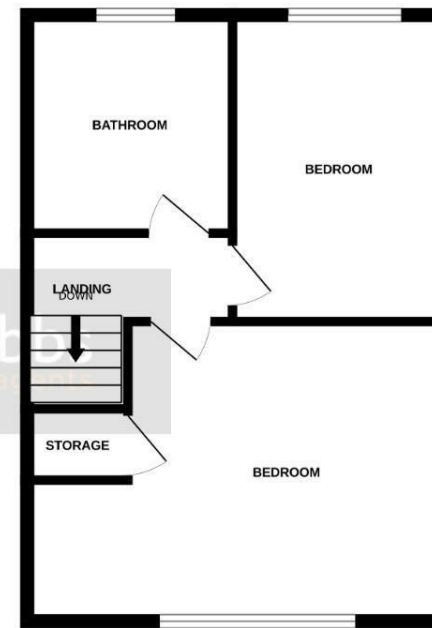

Whilst every attempt has been made to ensure the accuracy of the floorplan contained here, measurements of doors, windows, rooms and any other items are approximate and no responsibility is taken for any error, omission or mis-statement. This plan is for illustrative purposes only and should be used as such by any prospective purchaser. The services, systems and appliances shown have not been tested and no guarantee as to their operability or efficiency can be given.
Made with Metropix 6/2025

Webbs Estate Agents - endeavour to maintain accurate depictions of properties in Virtual Tours, Floor Plans and descriptions, however, these are intended only as a guide and purchasers must satisfy themselves by personal inspection.

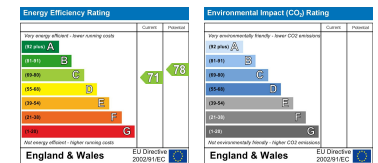

212 High Street, Bloxwich, Walsall, WS3 3LA

Tel: 01922 663399 | Email: bloxwich@webbestateagents.co.uk | www.webbestateagents.co.uk

Webbs
estate agents