



Webbs
Helping people move since 1994

Lynwood Close | Willenhall | WV12 5BW

Asking Price £265,000

 **Webbs**
estate agents

Summary

****THREE BEDROOM HOME**KITCHEN DINER**SUN ROOM TO THE REAR**LARGE GARAGE**GUEST WC**STORE ROOM**THREE GENEROUS BEDROOMS**FITTED BATHROOM**CUL-DE-SAC LOCATION**PERFECT FAMILY HOME**VIEWING ESSENTIAL****

Nestled in the tranquil cul-de-sac of Lynwood Close, Willenhall, this delightful link-detached house presents an excellent opportunity for families seeking a spacious and comfortable home. With three well-proportioned bedrooms and a thoughtfully designed layout, this property is ideal for those looking to take the next step on the property ladder.

Upon arrival, you will be greeted by a charming driveway and a landscaped area, leading to a convenient garage. The entrance hallway welcomes you into the heart of the home, where you will find a large kitchen diner, complete with a variety of wall and base units, perfect for family meals and entertaining guests. The generous lounge, complemented by a sun room, offers a bright and inviting space to relax and unwind.

Key Features

- THREE BEDROOM HOME
 - LARGE GARAGE WITH GUEST WC AND STORE ROOM
 - STUNNING POSITION
 - PERFECT FAMILY HOME
 - VIEWING ESSENTIAL
- STUNNING KITCHEN DINER
 - SUN ROOM TO THE REAR
 - CUL-DE-SAC LOCATION
 - CLOSE TO ALL LOCAL AMENITIES
 - CALL WEBBS TO SECURE YOUR VIEWING ON 01922 663399!!

Rooms and Dimensions

Entrance Hall

Kitchen Diner

17'10" x 10'6" (5.445m x 3.201m)

Lounge

15'11" x 15'4" (4.859m x 4.697m)

Conservatory

14'7" x 8'9" (4.458m x 2.671m)

Garage

31'6" x 8'9" (9.609m x 2.672m)

Guest WC

5'2" x 5'6" (1.590m x 1.701m)

Store Room

5'4" x 3'11" (1.641m x 1.219m)

First Floor Landing

Bedroom One

12'8" x 9'8" (3.876m x 2.960m)

Bedroom Two

11'5" x 9'4" (3.501m x 2.870m)

Bedroom Three

8'3" x 6'0" (2.517m x 1.839m)

Family Bathroom

5'11" x 5'5" (1.817m x 1.655m)

Identification Checks B





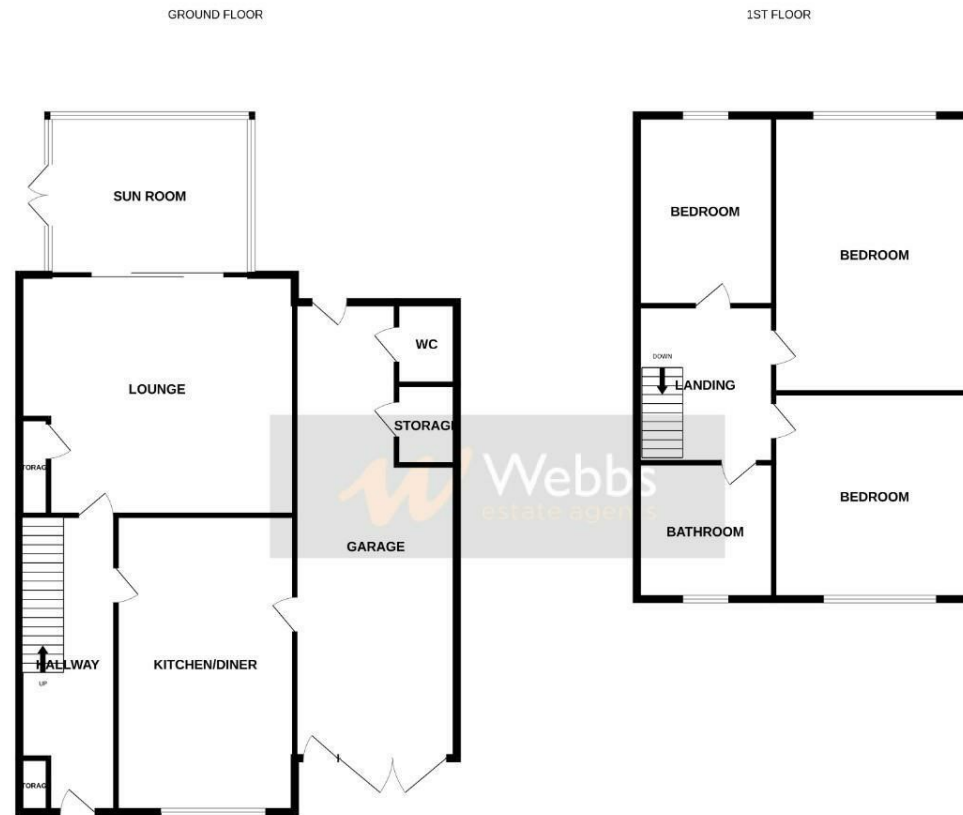

Whilst every attempt has been made to ensure the accuracy of the floorplan contained here, measurements of doors, windows, rooms and any other items are approximate and no responsibility is taken for any error, omission or mis-statement. This plan is for illustrative purposes only and should be used as such by any prospective purchaser. The services, systems and appliances shown have not been tested and no guarantee as to their operability or efficiency can be given.
Made with Metropex ©2025

Webbs Estate Agents - endeavour to maintain accurate depictions of properties in Virtual Tours, Floor Plans and descriptions, however, these are intended only as a guide and purchasers must satisfy themselves by personal inspection.

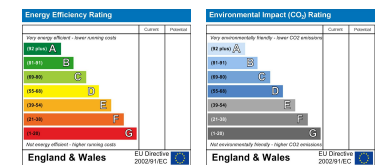

212 High Street, Bloxwich, Walsall, WS3 3LA

Tel: 01922 663399 | Email: bloxwich@webbestateagents.co.uk | www.webbestateagents.co.uk

