



Bloxwich Road | Bloxwich, Walsall | WS3 2XE

Auction Guide £150,000



## Summary

\* TRADITIONAL MID TERRACED PROPERTY \*\* NO ONWARD CHAIN \*\* DECEPTIVELY SPACIOUS \*\* POPULAR LOCATION \*\* THREE GOOD SIZED FIRST FLOOR BEDROOMS \*\* TWO RECEPTION ROOM \*\* KITCHEN \*\* DOWNSTAIRS BATHROOM WC \*\* USEABLE LOFT AREA \*\* GENEROUS GARDENS \*\* VIEWING ESSENTIAL \*\* EASY ACCESS TO SHOPS, AMENITIES AND SCHOOLS \*\* SOLD BY THE MODERN METHOD OF AUCTION \*\* BUYER TO PAY A NON REFUNDABLE RESERVATION FEE \*\*

Webbs Estate Agents have pleasure in offering this spacious traditional mid terraced home being situated in popular location close to all local amenities, shops and schools. Briefly comprising on the ground floor: lounge, dining room, kitchen and bathroom WC, the first floor having three good sized bedrooms and access to a useable loft space. Externally there is a brick built outbuilding, generous gardens and on street parking. For a viewing call Bloxwich office on 01922 663399.

### Agents Note

This property is for sale by the Modern Method of Auction. Should you view, offer or bid on the property, your information will be shared with the

## Key Features

- TRADITIONAL MID TERRACED PROPERTY
- SOLD BY THE MODERN METHOD OF AUCTION
- GENEROUS GARDENS
- KITCHEN & BATHROOM
- USEABLE LOFT SPACE
- POPULAR AND CONVENIENT LOCATION
- BUYER TO PAY A NON REFUNDABLE RESERVATION FEE
- LOUNGE, DINING ROOM
- THREE BEDROOMS
- NO ONWARD CHAIN

## Rooms and Dimensions

### LOUNGE

11'4" x 12'4" (3.47m x 3.76m)

### DINING ROOM

11'6" x 11'2" (3.51m x 3.42m)

### REFITTED KITCHEN

11'6" x 6'2" (3.51m x 1.88m)

### REFITTED BATHROOM

8'3" x 6'2" (2.54m x 1.88m)

### FIRST FLOOR LANDING

### BEDROOM ONE

11'10" x 10'10" (3.62m x 3.32m)

### BEDROOM TWO

10'2" x 11'7" (3.11m x 3.54m)

### BEDROOM THREE

11'6" x 6'2" (3.51m x 1.88m)

### GENEROUS GARDENS

### Identification Checks





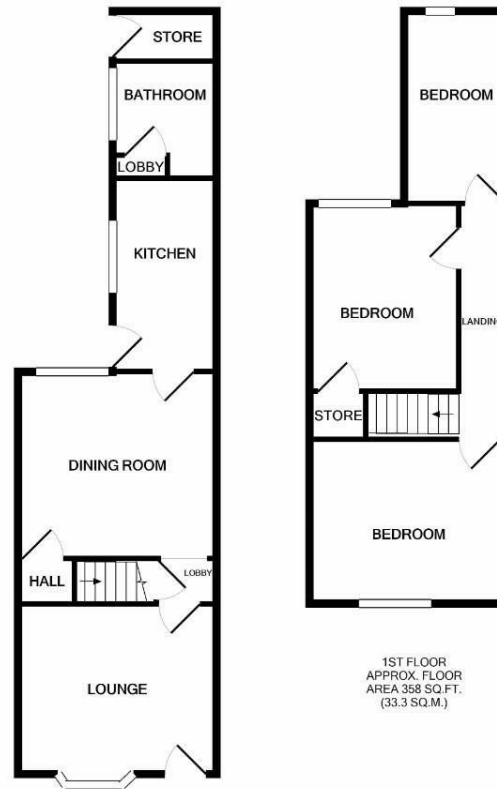

GROUND FLOOR  
APPROX. FLOOR  
AREA 425 SQ.FT.  
(39.5 SQ.M.)

1ST FLOOR  
APPROX. FLOOR  
AREA 358 SQ.FT.  
(33.3 SQ.M.)

TOTAL APPROX. FLOOR AREA 783 SQ.FT. (72.8 SQ.M.)

Whilst every attempt has been made to ensure the accuracy of the floor plan contained here, measurements of doors, windows, rooms and any other items are approximate and no responsibility is taken for any error, omission, or mis-statement. This plan is for illustrative purposes only and should be used as such by any prospective purchaser. The services, systems and appliances shown have not been tested and no guarantee as to their operability or efficiency can be given  
Made with Metropix ©2021

Webbs Estate Agents - endeavour to maintain accurate depictions of properties in Virtual Tours, Floor Plans and descriptions, however, these are intended only as a guide and purchasers must satisfy themselves by personal inspection.

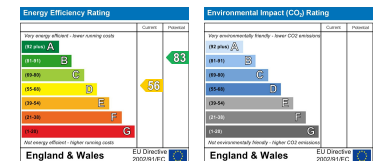

212 High Street, Bloxwich, Walsall, WS3 3LA

Tel: 01922 663399 | Email: [bloxwich@webbestateagents.co.uk](mailto:bloxwich@webbestateagents.co.uk) | [www.webbestateagents.co.uk](http://www.webbestateagents.co.uk)

**Webbs**  
estate agents