



High Street | Pelsall | WS3 4LT

Asking Price £80,000

 **Webbs**
estate agents

Summary

****ONE BEDROOM FLAT**PELSALL VILLAGE LOCATION**IN NEED OF MODERNISATION**NO ONWARD CHAIN**PARKING TO THE REAR**OWN ENTRANCE**PERFECT FIRST TIME BUY OR INVESTMENT**IDEAL LOCATION FOR ALL LOCAL AMENITIES**VIEWING ESSENTIAL****

Located in the heart of Pelsall Village on the popular High Street, this one-bedroom flat offers an excellent opportunity for first-time buyers or investors. With local amenities quite literally on your doorstep, this well-positioned property provides convenience, character, and great potential.

Accessed via an outdoor staircase, the accommodation opens into a kitchen diner, with a bathroom located adjacent. The property also features a spacious lounge with a feature fireplace, a study area, and a double bedroom overlooking the High Street.

While the property would benefit from some modernisation, it presents a fantastic chance to add personalisation to the space. Communal parking is available, adding to the practicality of this well-located home.

This is a rare opportunity to secure a property in a central village location – ideal for those looking to get onto the property ladder or for a savvy investor looking to unlock potential. Early viewing recommended.

Call Webbs today on 01922 663399!!!

Key Features

- ONE BEDROOM FLAT
- NO ONWARD CHAIN
- PARKING TO THE REAR
- LOUNGE
- POPULAR LOCATION
- IN NEED OF MODERNISATION
- KITCHEN DINER
- PELSALL VILLAGE
- STUDY/STORE ROOM
- CALL WEBBS ON 01922663399 TO SECURE YOUR VIEWING TODAY!!!

Rooms and Dimensions

Kitchen

16'7" x 9'1" (5.058m x 2.783m)

Bathroom

5'1" x 9'6" (1.553m x 2.903m)

Lounge

13'6" x 13'1" (4.134m x 3.999m)

Study

4'8" x 10'5" (1.443m x 3.176m)

Bedroom

13'5" x 10'10" (4.110m x 3.315m)

Identification Checks B

DRAFT DETAILS

Agents Notes Tenure





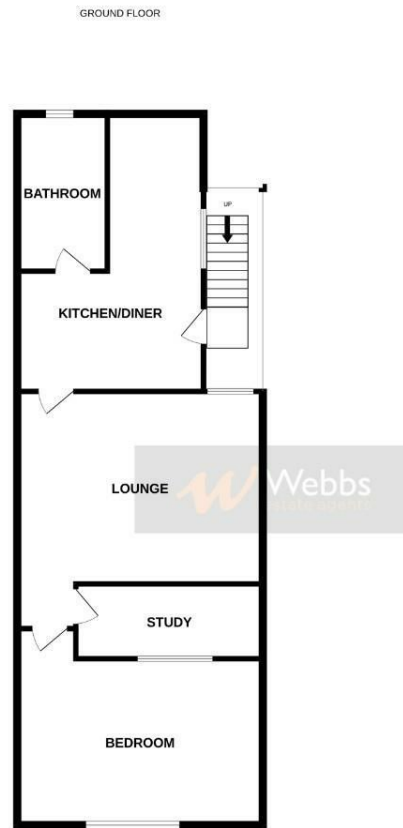

Whilst every attempt has been made to ensure the accuracy of the floorplan contained here, measurements of doors, windows, rooms and any other items are approximate and no responsibility is taken for any error, omission or mis-statement. This plan is for illustrative purposes only and should be used as such by any prospective purchaser. The services, systems and appliances shown have not been tested and no guarantee as to their operability or efficiency can be given.
Made with floorplan ©2025

Webbs Estate Agents - endeavour to maintain accurate depictions of properties in Virtual Tours, Floor Plans and descriptions, however, these are intended only as a guide and purchasers must satisfy themselves by personal inspection.

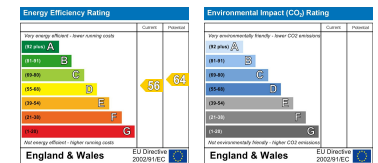

212 High Street, Bloxwich, Walsall, WS3 3LA

Tel: 01922 663399 | Email: bloxwich@webbestateagents.co.uk | www.webbestateagents.co.uk

