



Somerfield Road | Walsall | WS3 2EG

Asking Price £170,000



Summary

****THREE BEDROOM TERRACE HOME**ENTRANCE PORCH**LOUNGE**GUEST WC**FITTED KITCHEN DINER**THREE GENEROUS BEDROOMS**FITTED BATHROOM**NO ONWARD CHAIN**PRIVATE AND ENCLOSED REAR GARDEN**POPULAR LOCATION**PARKING TO THE REAR**STORAGE AREA IN GARDEN****

Situated on the popular Somerfield Road, this spacious three-bedroom terrace home offers comfortable family living with a range of practical features. To the front, you'll find a lawned garden leading to the entrance porch. Inside, the property boasts a large lounge, perfect for relaxing, and a well-appointed kitchen diner with plenty of space for family meals. A convenient guest WC completes the ground floor. Upstairs, the first floor offers three generously sized bedrooms and a fitted bathroom, providing ample space for a growing family or guests. To the rear, there is a private enclosed garden, ideal for outdoor entertaining or play, along with a storage shed for added practicality. The property also benefits from parking facilities, ensuring convenience for homeowners and visitors alike. This well-proportioned home is perfect for those seeking both indoor and outdoor space in a desirable location.

Key Features

- THREE BEDROOM TERRACE
- LOUNGE
- GUEST WC
- THREE GENEROUS BEDROOM
- POPULAR LOCATION
- ENTRANCE PORCH
- KITCHEN DINER
- PARKING TO THE REAR
- FITTED BATHROOM
- CALL WEBBS ON 01922663399 TO SECURE YOUR VIEWING TODAY!!!

Rooms and Dimensions

Identification Checks B

Entrance Porch

Lounge
14'11" x 12'4" (4.56m x 3.77m)

Inner Hall

Kitchen/Diner
15'7" x 8'7" (4.77m x 2.63m)

Guest WC

First Floor Landing

Bedroom One
15'0" x 9'4" (4.58m x 2.86m)

Bedroom Two
13'2" x 8'9" (4.02m x 2.69m)

Bedroom Three
13'3" x 8'2" (4.05m x 2.51m)

Family Bathroom





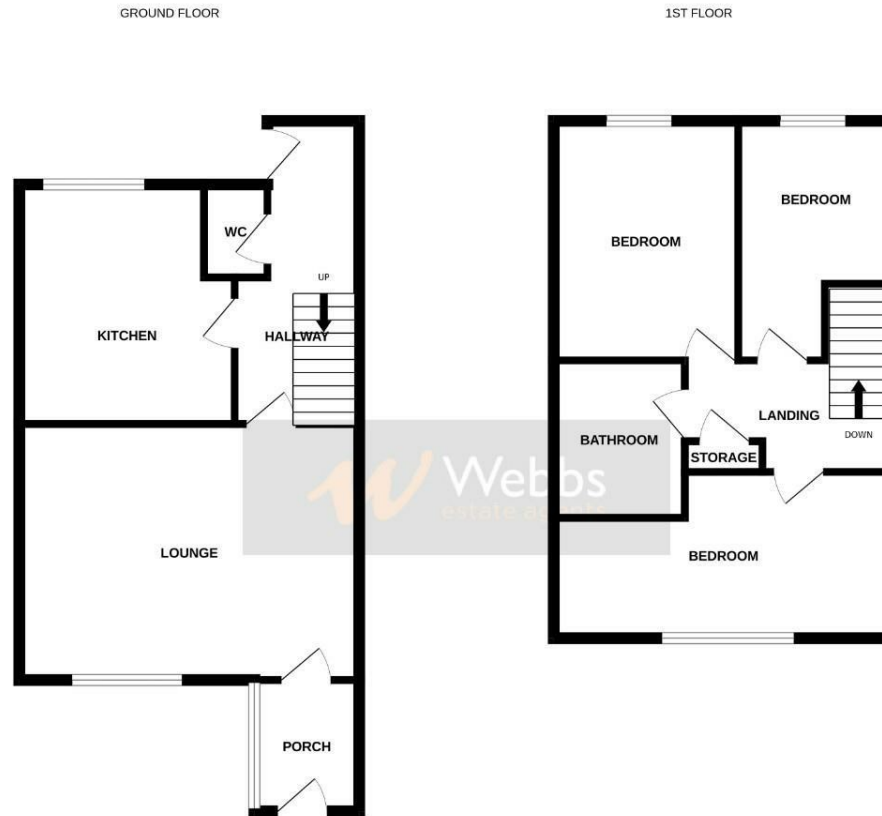

Whilst every attempt has been made to ensure the accuracy of the floorplan contained here, measurements of floors, rooms, walls and any other items are approximate and no responsibility is taken for any error, omission or mis-statement. This plan is for illustrative purposes only and should be used as such by any prospective purchaser. The services, systems and appliances shown have not been tested and no guarantee as to their operability or efficiency can be given.
Made with Metropix ©2025

Webbs Estate Agents - endeavour to maintain accurate depictions of properties in Virtual Tours, Floor Plans and descriptions, however, these are intended only as a guide and purchasers must satisfy themselves by personal inspection.

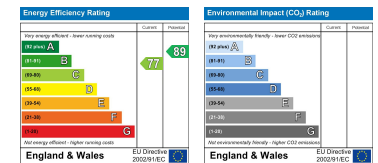

212 High Street, Bloxwich, Walsall, WS3 3LA

Tel: 01922 663399 | Email: bloxwich@webbestateagents.co.uk | www.webbestateagents.co.uk

