



Webbs
Helping people move since 1994

Whitehouse Street | Walsall | WS2 8HR

Auction Guide £125,000

 **Webbs**
estate agents

Summary

**** FOR SALE BY MODERN METHOD OF AUCTION ** BUYER FEES APPLY ** SUBJECT TO A RESERVE PRICE ** NO ONWARD CHAIN ** REQUIRING MODERNISATION ** THREE BEDROOMS ** PARKING TO REAR ** UPVC DG & GCH ** IDEAL FIRST TIME BUY OR INVESTMENT PROPERTY ** KITCHEN / DINER ** SPACIOUS LIVING ROOM **DOWNSTAIRS WC ** EARLY VIEWING ESSENTIAL TO AVOID DISAPPOINTMENT ****

Property is offered for sale through the Modern Method of Auction which is operated by iamsold Limited. For a viewing please call 01922 288800.

Webbs Estate Agents have pleasure in offering for sale this ideal first time buy or investment property located close to amenities, schools and commuter links. Briefly comprising: lobby, living room and kitchen / diner and a WC. To the first floor, the landing leads to three bedrooms, and a family bathroom. Externally there is parking to the rear and a rear garden with double gates offering additional secure parking. EARLY VIEWING IS ADVISED!

Key Features

- SOLD BY MODERN METHOD OF AUCTION WITH NO ONWARD CHAIN
- NO ONWARD CHAIN
- KITCHEN / DINER
- FAMILY BATHROOM
- UPVC DG & GCH
- BUYERS FEE APPLY, SUBJECT TO RESERVE PRICE CHAIN
- IDEAL FTB OR INVESTMENT PROPERTY
- LIVING ROOM
- REAR GARDEN & PARKING
- EARLY VIEWING ESSENTIAL

Rooms and Dimensions

LOBBY

KITCHEN / DINER

9'10" x 16'8" (3.01 x 5.09)

LIVING ROOM

10'10" x 17'11" (3.31 x 5.48)

DOWNSTAIRS WC

BEDROOM ONE

9'8" x 11'3" (2.97 x 3.44)

BEDROOM TWO

9'11" x 11'8" (3.04 x 3.58)

BEDROOM THREE

7'8" x 8'2" (2.35 x 2.49)

FAMILY BATHROOM

6'8" x 5'10" (2.05 x 1.80)

OUTSIDE

Auctioneers Comments

Identification Checks





GROUND FLOOR

1ST FLOOR

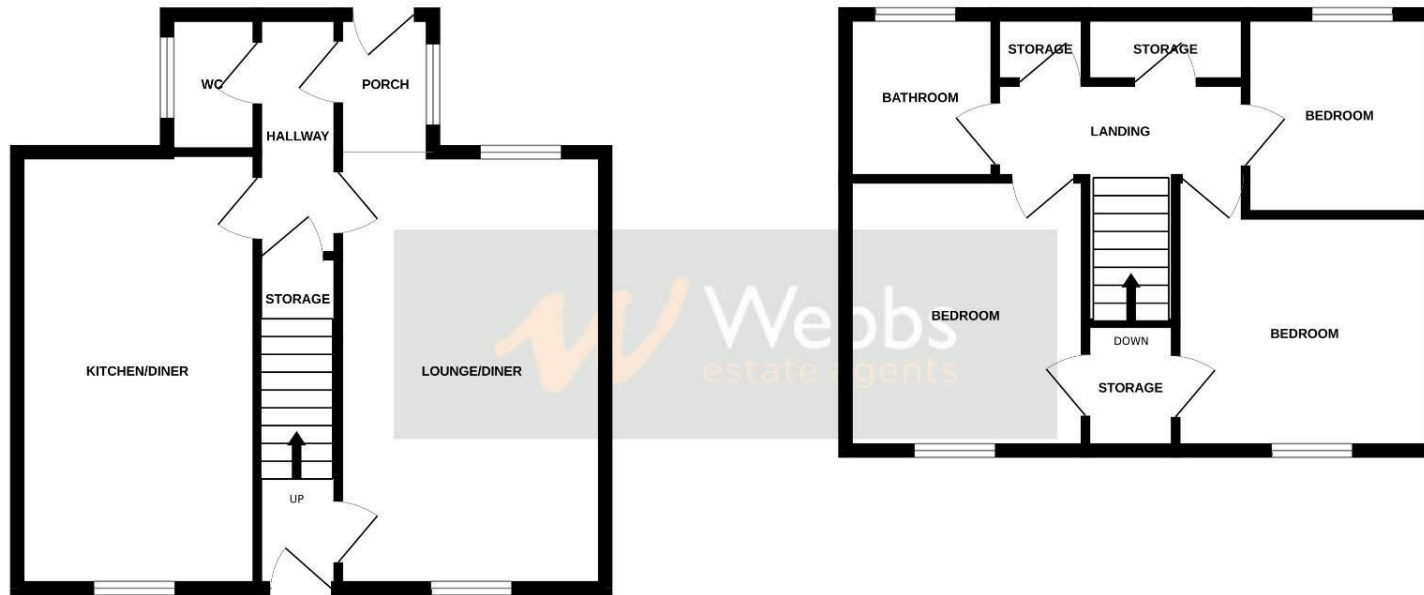

Whilst every attempt has been made to ensure the accuracy of the floorplan contained here, measurements of doors, windows, rooms and any other items are approximate and no responsibility is taken for any error, omission or mis-statement. This plan is for illustrative purposes only and should be used as such by any prospective purchaser. The services, systems and appliances shown have not been tested and no guarantee as to their operability or efficiency can be given.
Made with Metropix ©2024

Webbs Estate Agents - endeavour to maintain accurate depictions of properties in Virtual Tours, Floor Plans and descriptions, however, these are intended only as a guide and purchasers must satisfy themselves by personal inspection.

