



Webbs

Helping people move since 1994

Wolverhampton Road | Walsall | WS3 4AW

Offers In The Region Of £230,000

 **Webbs**
estate agents

Summary

****TRADITIONAL BAY FRONTED SEMI DETACHED HOME**THREE BEDROOMS**REFITTED KITCHEN**CONSEVATORY**TWO RECEPTION ROOMS**PORCH**FITTED BATHROOM**STORAGE GARAGE**DRIVEWAY AND FRONT GARDEN**MATURE REAR GARDEN** NO CHAIN****

Webbs Estate Agents are pleased to bring to market this great traditional bay fronted three bedroom semi detached home offered with no onward chain, this home is situated on the popular Wolverhampton Road close to all local amenities including shops, schools road and transport links.

In brief this home offers driveway and and front garden with storage garage, internally there is entrance porch, hall, two reception rooms, conservatory and refitted galley style kitchen.

On the first floor there are three generous bedrooms and family bathroom.

To the rear there is a private and enclosed mature rear garden.

Call Webbs on 01922 663399 to secure your viewing today!!

Key Features

- TRADITIONAL BAY FRONTED SEMI DETACHED HOME
- REFITTED KITCHEN
- STORAGE GARAGE
- MATURE REAR GARDEN
- CLOSE TO ALL LOCAL AMENITIES
- THREE BEDROOMS
- CONSEVATORY
- DRIVE AND FRONT GARDEN
- POPULAR LOCATION
- CALL WEBBS ON 01922 663399 TO SECURE YOUR VIEWING TODAY

Rooms and Dimensions

Entrance Porch

Hall

Sitting Dining Room

10'9" x 12'1" (3.284m x 3.692m)

Sitting Room Two

10'7" x 13'3" (3.250m x 4.047m)

Conservatory

9'6" x 9'3" (2.902m x 2.829m)

Kitchen

6'5" x 13'3" (1.974m x 4.062m)

First Floor Land

Bedroom One

10'6" x 10'8" (3.220m x 3.274m)

Bedroom Two

12'0" x 10'9" (3.658m x 3.280m)

Family Bathroom

Identification Checks





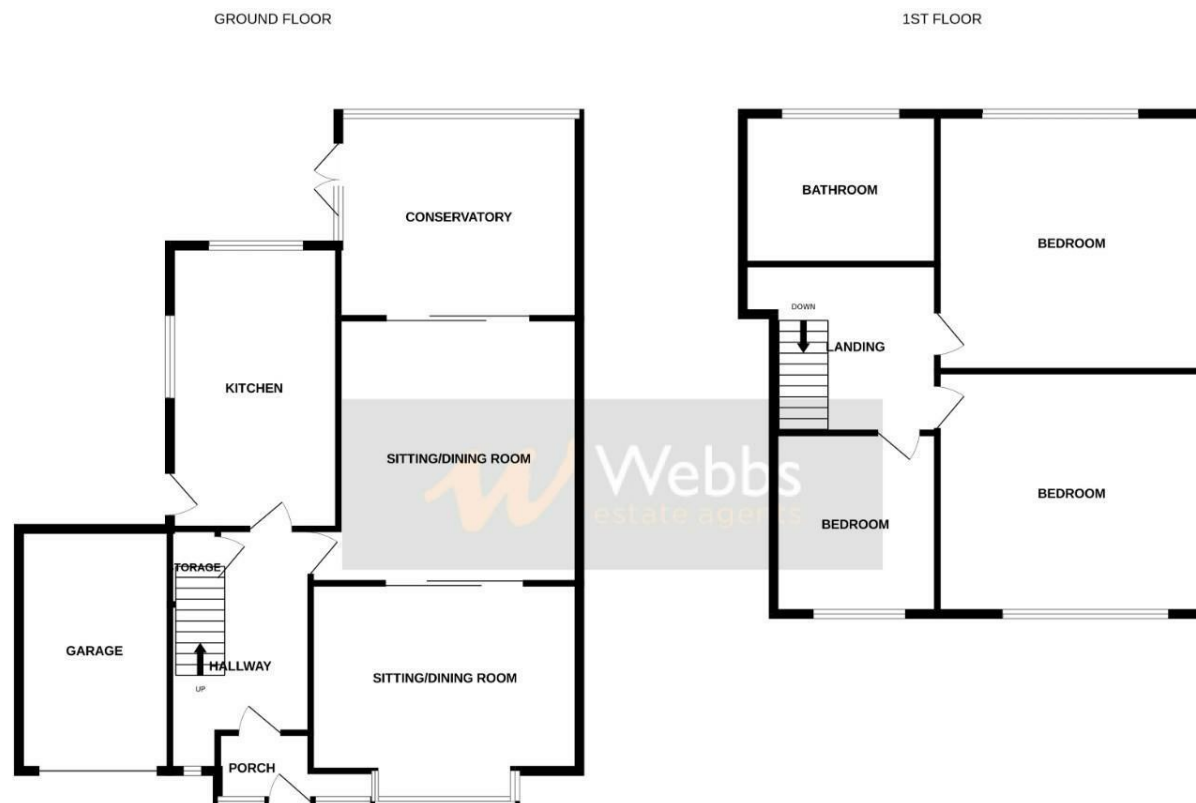

Whilst every attempt has been made to ensure the accuracy of the floorplan contained here, measurements of doors, windows, rooms and any other items are approximate and no responsibility is taken for any error, omission or mis-statement. This plan is for illustrative purposes only and should be used as such by any prospective purchaser. The services, systems and appliances shown have not been tested and no guarantee as to their operability or efficiency can be given.
Made with Metropix ©2024

Webbs Estate Agents - endeavour to maintain accurate depictions of properties in Virtual Tours, Floor Plans and descriptions, however, these are intended only as a guide and purchasers must satisfy themselves by personal inspection.

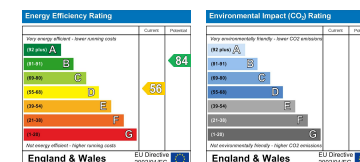

212 High Street, Bloxwich, Walsall, WS3 3LA

Tel: 01922 663399 | Email: bloxwich@webbestateagents.co.uk | www.webbestateagents.co.uk

