



Webbs

Helping people move since 1994

Hough Way | Wolverhampton | WV11 2BR

Offers In The Region Of £129,950

 Webbs  
estate agents

## Summary

**\*\* NO ONWARD CHAIN\*\*TWO BEDROOM APARTMENT\*\* FIRST FLOOR\*\* VILLAGE OF ESSINGTON\*\*ALLOCATED PARKING\*\* CUL-DE-SAC LOCATION\*\* FITTED KITCHEN\*\* FITTED BATHROOM\*\* OPEN PLAN LIVING/ KITCHEN / DINER\*\* JULIET BALCONY TO THE LOUNGE AREA\*\***

Webbs Estate Agents are pleased to offer this first floor modern apartment situated in the popular village of Essington, being close to local shops school and amenities along side the M6 and M54.

This property is approached via a communal hallway leading to the apartments. Internally you have entrance hallway, open plan lounge with feature Juliet balcony, kitchen and dining area, Bedroom one benefits from fitted wardrobes and bedroom two has an outlook to the front of this home.

This property also benefits from allocated parking.  
Viewing is essential to appreciate this home.

## Key Features

- TWO BEDROOM FIRST FLOOR APARTMENT
- JULIET BALCONY TO LOUNGE
- VILLAGE OF ESSINGTON
- FITTED BATHROOM
- CLOSE TO ALL LOCAL AMENITIES
- OPEN PLAN LIVING, KITCHEN,DINER
- CUL-DE-SAC LOCATION
- NO ONWARD CHAIN
- FITTED KITCHEN
- CALL WEBBS TODAY TO SECURE YOUR VIEWING

## Rooms and Dimensions

### Communal entrance

### Hallway

### Bathroom

6'11" x 6'2" (2.130m x 1.880m)

### Lounge/Kitchen/ Diner

20'11" x 10'8" (6.400m x 3.265m)

### Bedroom One

9'10" x 10'10" (3.007m x 3.325m)

### Bedroom Two

6'2" x 10'8" (1.890m x 3.256m)





GROUND FLOOR

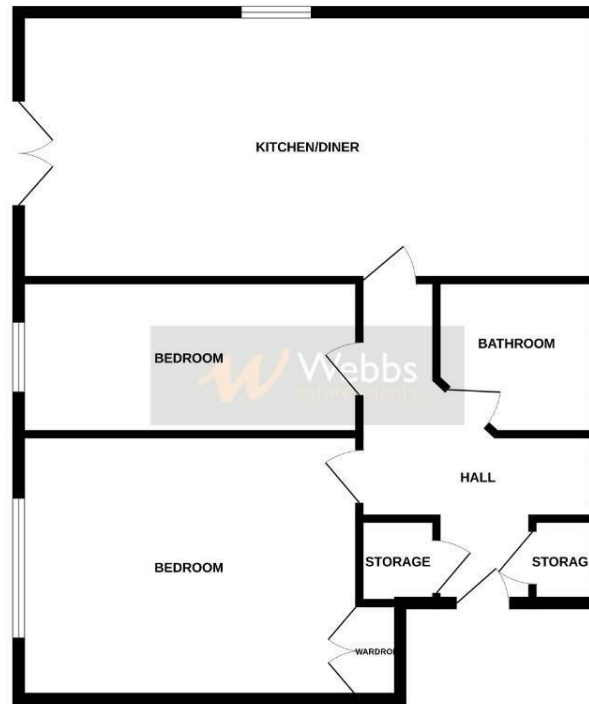

Whilst every attempt has been made to ensure the accuracy of the floorplan contained here, measurements of doors, windows, rooms and any other items are approximate and no responsibility is taken for any error, omission or mis-statement. This plan is for illustrative purposes only and should be used as such by any prospective purchaser. The services, systems and appliances shown have not been tested and no guarantee is given to their operability or efficiency can be given.  
Made with Metropix ©2024

Webbs Estate Agents - endeavour to maintain accurate depictions of properties in Virtual Tours, Floor Plans and descriptions, however, these are intended only as a guide and purchasers must satisfy themselves by personal inspection.

