



Riverway | Wednesbury | WS10 0DN

Open To Offers £320,000



Summary

**** WOW ** EXTENDED FAMILY HOME ** SOUGHT AFTER LOCATION ** OPEN VIEWS TO FRONT ELEVATION ** DECEPTIVELY SPACIOUS THROUGHOUT ** INTERNAL VIEWING IS ESSENTIAL ** SPACIOUS LOUNGE DINER ** STUNNING KITCHEN ** SITTING ROOM / BEDROOM FOUR ** GUEST WC ** THREE / FOUR BEDROOMS ** STUDY AREA ** FAMILY BATHROOM ** FRONT & REAR GARDEN ** GENEROUS GARDENS ** GAS CENTRAL HEATING ** NEW UPVC DOUBLE GLAZING ****

Webb's Estate Agents have pleasure in offering this WELL PRESENTED, spacious extended family home, situated in a sought-after location with open views to the front elevation, being close to all local amenities and good schools. Briefly comprising: through hallway, lounge diner, refitted kitchen with integrated appliances, inner hallway, guest WC and sitting room/bedroom four. On the first floor the landing leads to three good-sized bedrooms, a study area and a family bathroom. Externally there is a fore garden, private driveway, generous garage, and rear gardens.

Key Features

- EXTENDED FAMILY HOME
- DECEPTIVELY SPACIOUS
- FAMILY BATHROOM & GUEST WC
- REFITTED KITCHEN
- GENEROUS GARDENS
- VIEWING IS ESSENTIAL
- THREE / FOUR BEDROOMS
- DUAL ASPECT LOUNGE DINER
- SITTING ROOM / BEDROOM FOUR
- GARAGE & DRIVEWAY

Rooms and Dimensions

AWAITING VENDOR APPROVAL

THROUGH HALLWAY

LOUNGE DINER

11'1" max x 26'6" (3.40m max x 8.10m)

REFITTED KITCHEN

12'5" x 7'6" (3.81m x 2.31m)

INNER HALLWAY

GUEST WC

BEDROOM FOUR / SITTING ROOM

15'7" max x 9'1" (4.75m max x 2.77m)

LANDING

BEDROOM ONE

10'9" x 13'8" (3.30m x 4.19m)

STUDY

5'8" x 6'7" (1.75m x 2.03m)

BEDROOM TWO

9'1" x 13'1" (2.79m x 3.99m)

BEDROOM THREE

10'9" x 10'5" (3.30m x 3.20m)

FAMILY BATHROOM

GENEROUS GARAGE

18'9" max x 14'0" (5.74m max x 4.27m)

PRIVATE DRIVEWAY

FRONT & REAR GARDENS





GROUND FLOOR

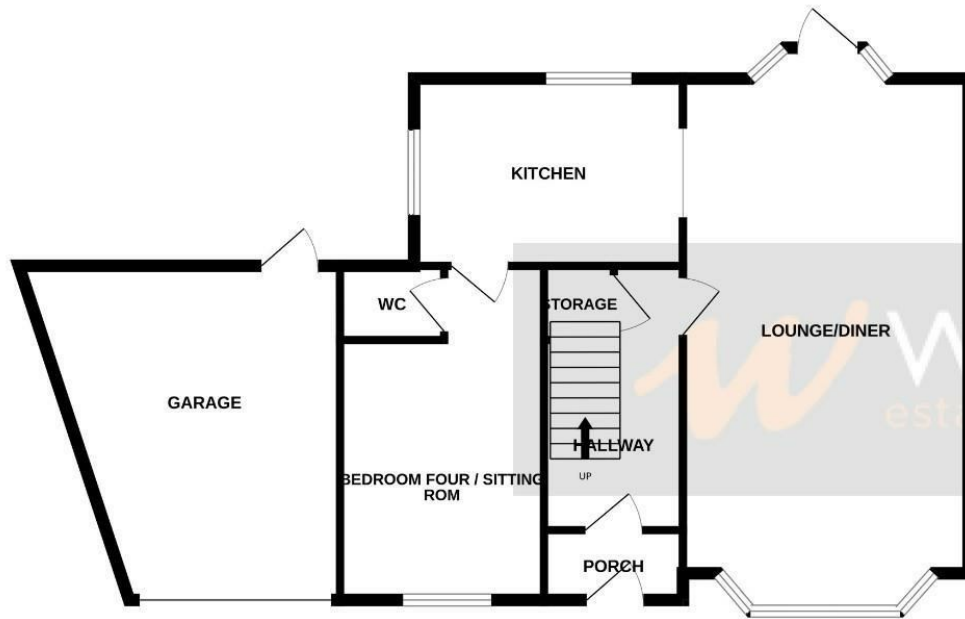

1ST FLOOR

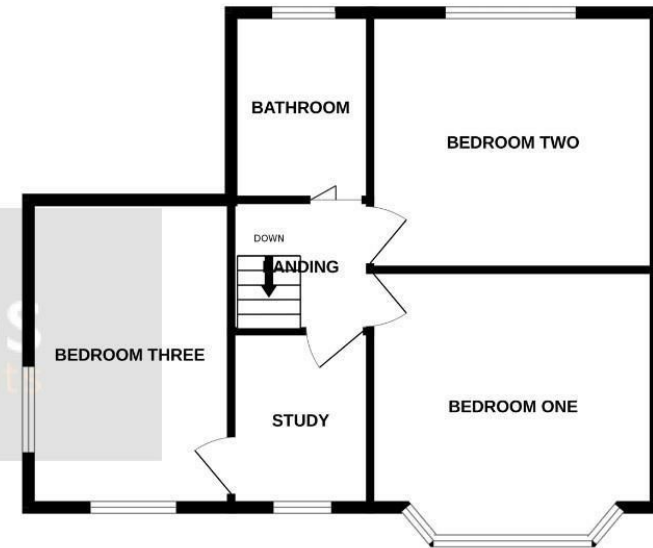

Whilst every attempt has been made to ensure the accuracy of the floorplan contained here, measurements of doors, windows, rooms and any other items are approximate and no responsibility is taken for any error, omission or mis-statement. This plan is for illustrative purposes only and should be used as such by any prospective purchaser. The services, systems and appliances shown have not been tested and no guarantee as to their operability or efficiency can be given.
Made with Metropix ©2024

Webbs Estate Agents - endeavour to maintain accurate depictions of properties in Virtual Tours, Floor Plans and descriptions, however, these are intended only as a guide and purchasers must satisfy themselves by personal inspection.

