



CHATTERTON | REES



301a Fulham Palace Road, London, SW6 6TL
Asking price £695,000





301a Fulham Palace Road

London, SW6 6TL

- Beautifully presented purpose built split level apartment
- One bathroom
- Light with high ceilings
- Two bedrooms
- Private garden
- Excellent transport links

A stunning 2 bedroom split-level flat is arranged over the upper floors of this Victorian terraced property. Internally the first floor has the open plan kitchen/reception, access to the private garden, and the bathroom with both bedrooms on the second floor.

The property has been finished to a very good standard throughout from the flooring, bathroom, kitchen fittings and appliances with nothing missed inside or out.

Asking price £695,000





Directions

The flat is located conveniently close to the charming Bishops Park & Fulham Palace, the Thames Path, as well as being a short walk from the newly renovated Craven Cottage, Riverside development. Shops and restaurants are nearby and also the Putney Bridge and Parsons Green tube stations in walking distance. The property has excellent bus links servicing Fulham, Hammersmith Broadway, Putney, and the West End, and is situated directly adjacent to a large Santander Cycles/e-bike dock.



Floor Plans

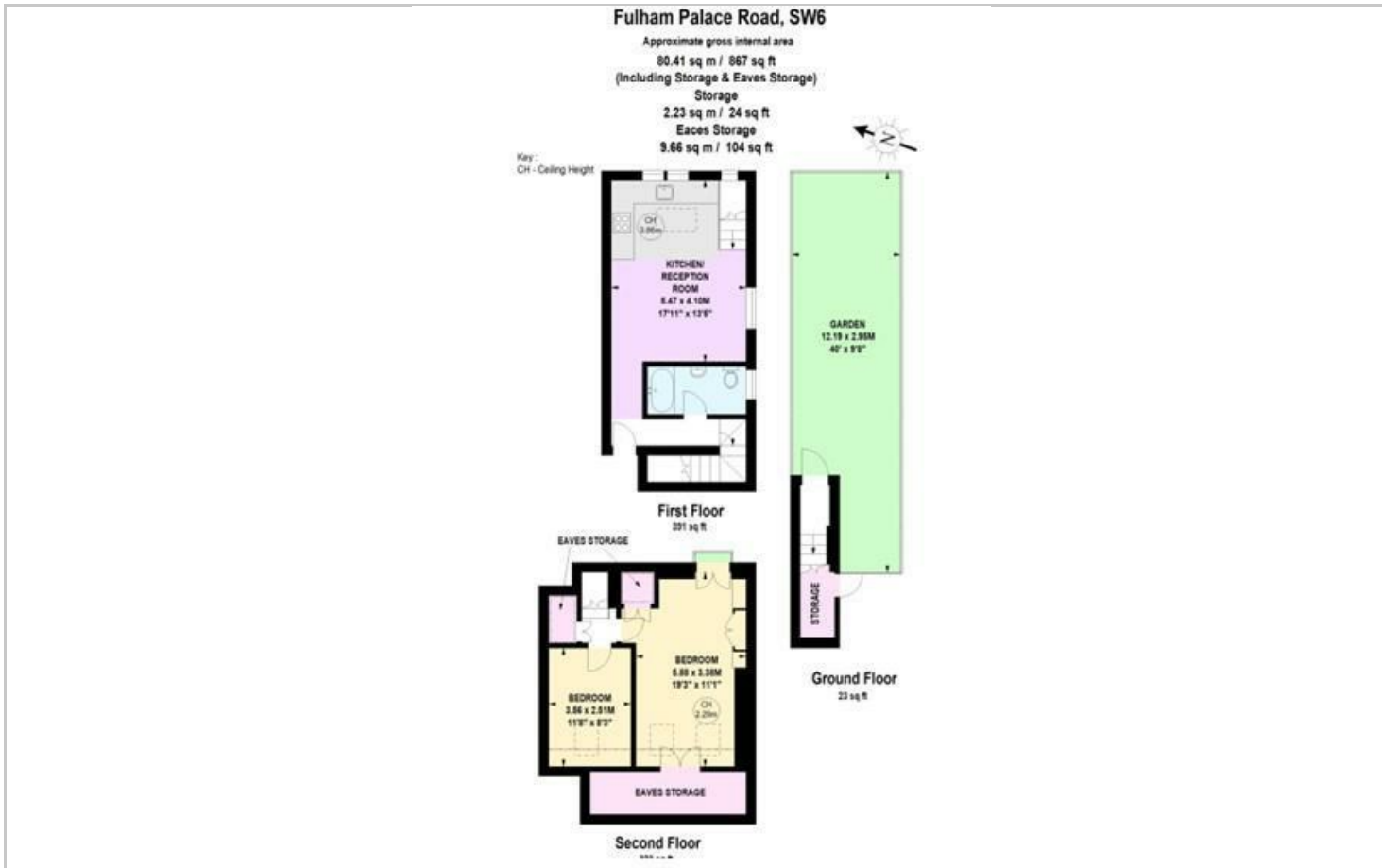

Location Map

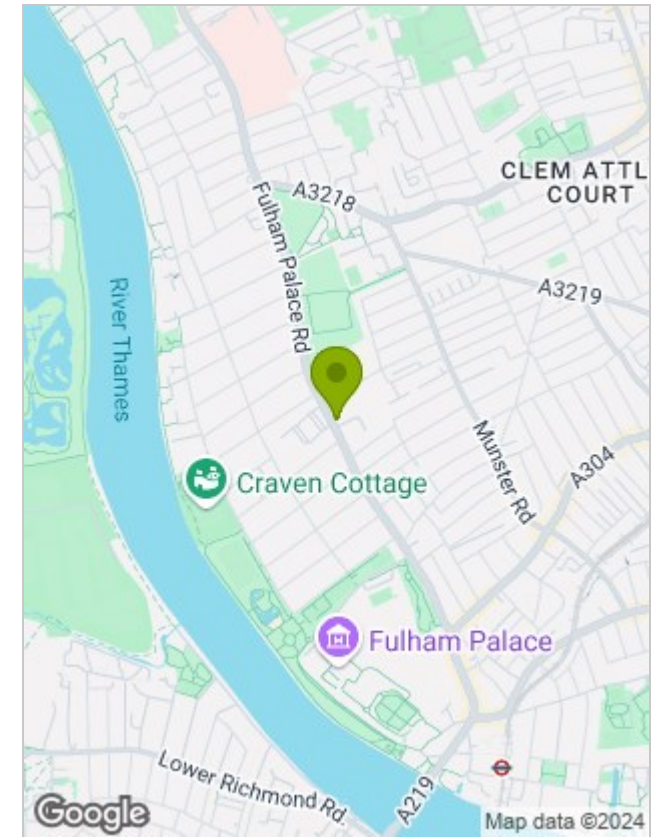

Energy Performance Graph

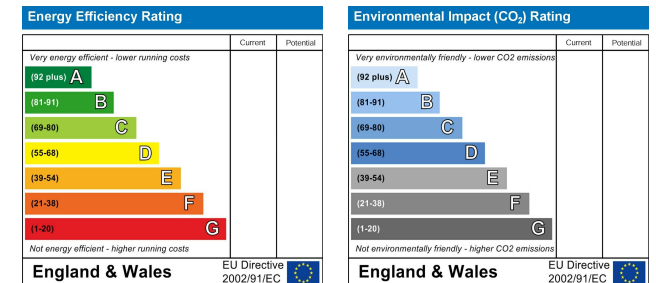

Viewing

Please contact our Chatterton Rees Office on 020 3780 0580 if you wish to arrange a viewing appointment for this property or require further information.

The particulars are set out as a general outline only for the guidance of intended purchasers or lessees, and do not constitute, any part of a contract. Nothing in these particulars shall be deemed to be a statement that the property is in good structural condition or otherwise nor that any of the services, appliances, equipment or facilities are in good working order. Purchasers should satisfy themselves of this prior to purchasing.