



CHATTERTON | REES



37 Lower Belgrave Street

, London, SW1W 0LS

Asking price £3,250,000



2



1



2



37 Lower Belgrave Street



Description

Located in a prime position in the heart of Belgravia, this substantial house is unique in the sense that every room is large and has fantastic entertaining space. The house has been recently modernised and is stunning throughout. Currently the house is laid out as a two bedroom property however has been used as a three bedroom before and can easily be converted back to that. The kitchen is full of top of the range appliances and has recently has a new marble countertop beautifully cut and installed.

Situated in the heart of Belgravia on Lower Belgrave Street which is conveniently located just off Eaton Square and Chester Square

- 2/3 bedrooms
- Freehold
- Wooden floors
- 2 bathrooms
- Modern throughout
- Bright throughout





Floor Plan

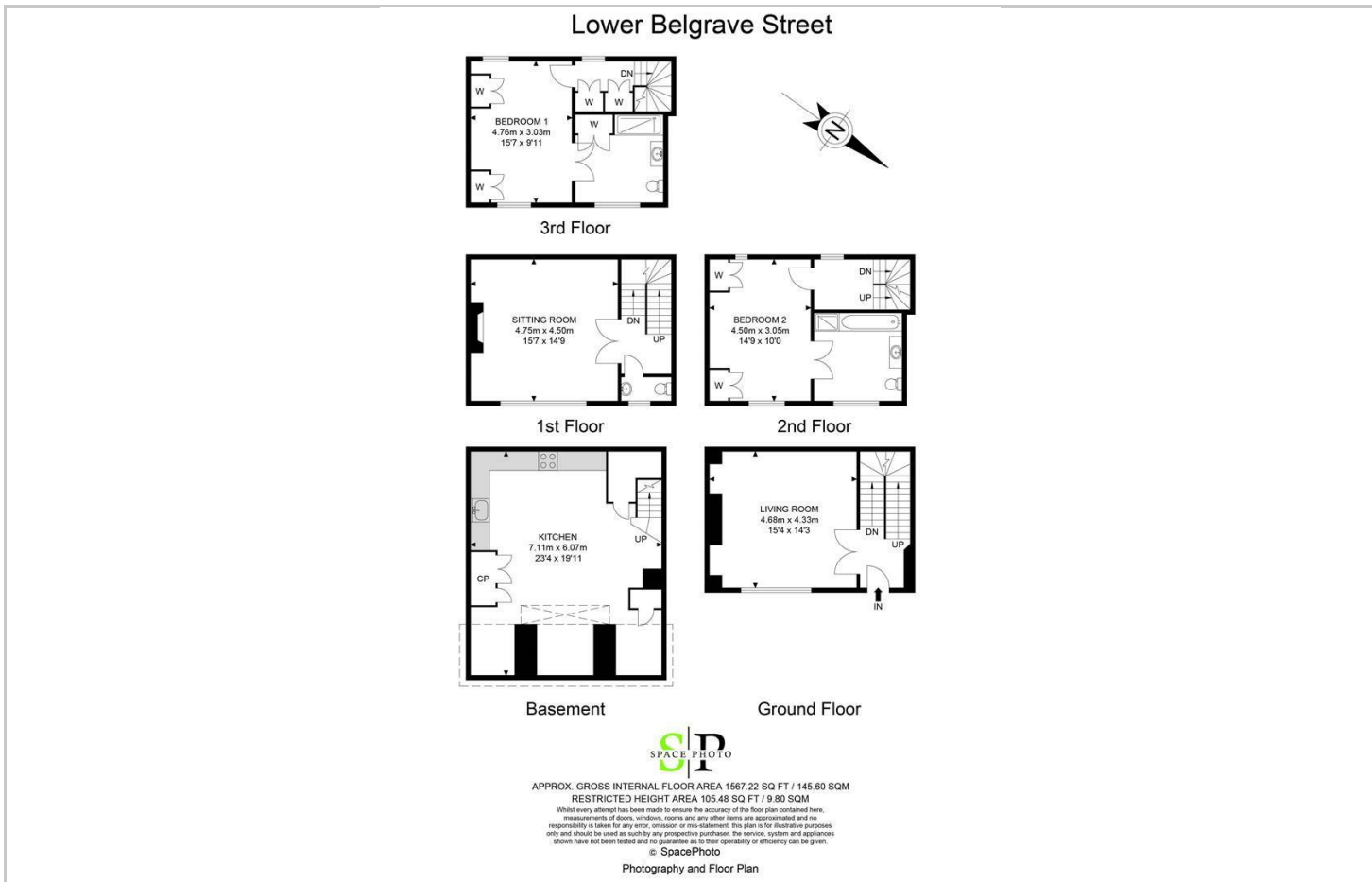

Area Map

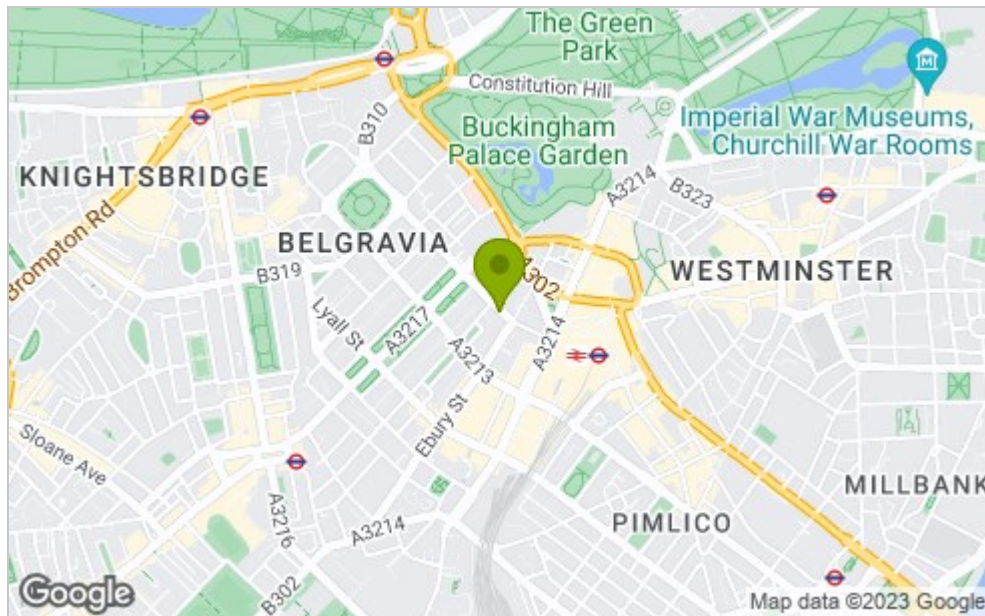

Viewing

Please contact our Chatterton Rees Office on 020 3780 0580 if you wish to arrange a viewing appointment for this property or require further information.

These particulars, whilst believed to be accurate are set out as a general outline only for guidance and do not constitute any part of an offer or contract. Intending purchasers should not rely on them as statements of representation of fact, but must satisfy themselves by inspection or otherwise as to their accuracy. No person in this firm's employment has the authority to make or give any representation or warranty in respect of the property.

Energy Efficiency Graph

Energy Efficiency Rating		Current	Potential
Very energy efficient - lower running costs			
(92 plus) A			
(81-91) B			
(69-80) C			
(55-68) D			
(39-54) E			
(21-38) F			
(1-20) G			
Not energy efficient - higher running costs			
England & Wales		EU Directive 2002/91/EC	
Environmental Impact (CO ₂) Rating		Current	Potential
Very environmentally friendly - lower CO ₂ emissions			
(92 plus) A			
(81-91) B			
(69-80) C			
(55-68) D			
(39-54) E			
(21-38) F			
(1-20) G			
Not environmentally friendly - higher CO ₂ emissions			
England & Wales		EU Directive 2002/91/EC	