



**Drake Way, Reading**

**£1,200 PCM**



1



1



1

**Council tax band: C | EPC rating: C**

- 2nd floor executive apartment
- One double bedroom
- Lift and communal garden

- Open plan kitchen / living room
- Shower attachment over bath
- Fully Furnished

**BELVOIR!**

Property is personal

Email  
**[Reading.lettings@belvoir.co.uk](mailto:Reading.lettings@belvoir.co.uk)**

Phone  
**01189 420777**

## Description

\*Available from 9th June 2025\* Belvoir are pleased to offer to the market this one bedroom first floor executive apartment offered furnished or unfurnished.

The property comprises of open plan Lounge/kitchen/diner, one double bedroom with built in wardrobes, bathroom with shower attachment over bath, allocated parking for one car and 2 visitors permits.

The property benefits from having a lift and communal gardens. Situated in the sought after Kennet Island development, this property is ideal for a professional couple.

Please note that all applicants who attend property viewings do at their own risk and must assess any hazards themselves.

## Floorplan

### First Floor

Approx. 40.9 sq. metres (440.1 sq. feet)

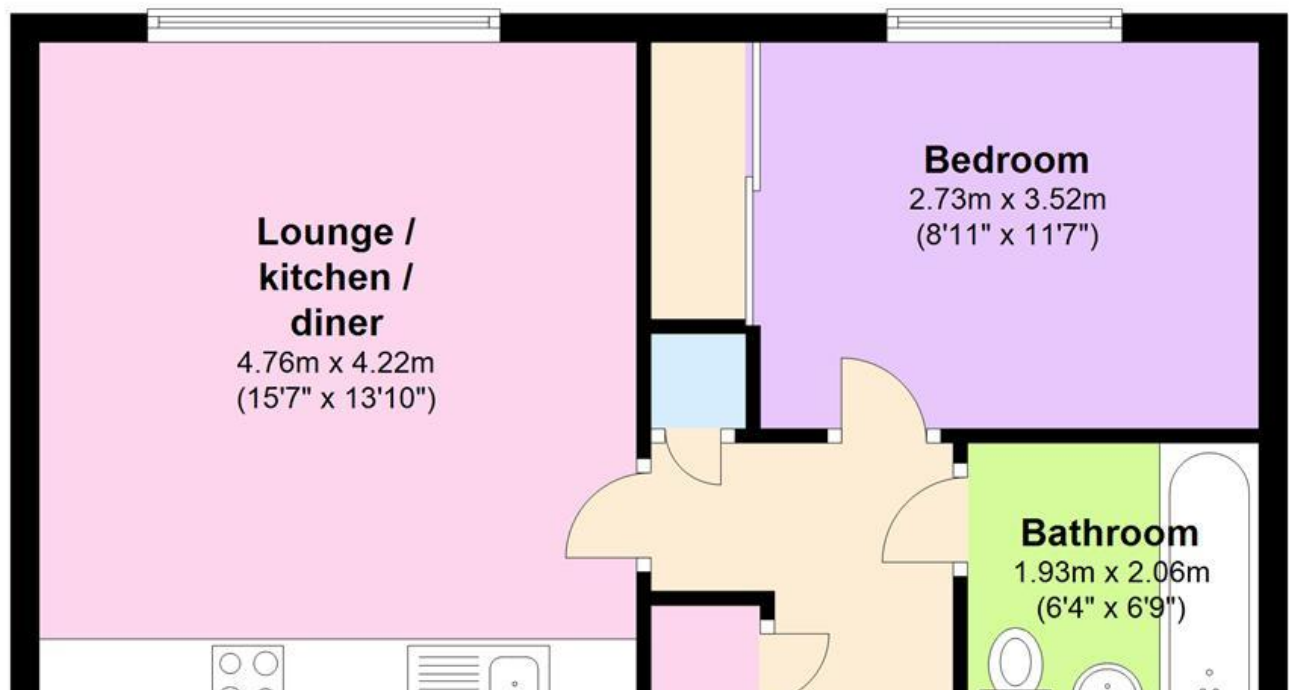





## Photographs



**Map**

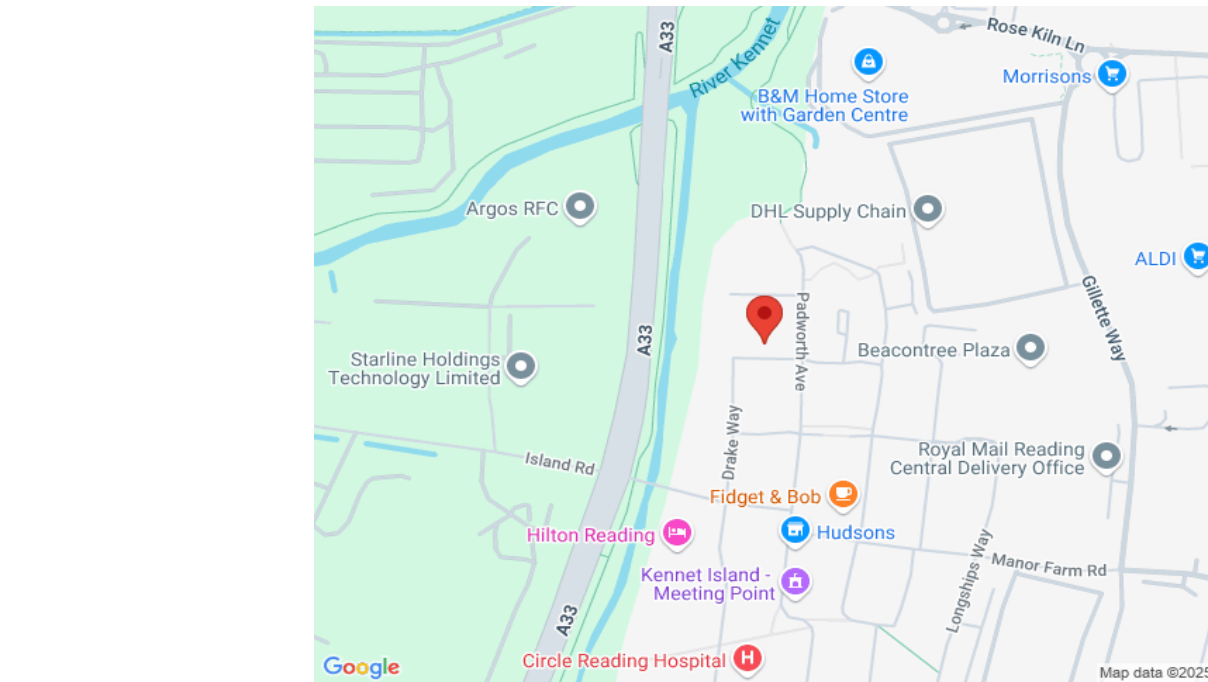

Notes

This image shows a single sheet of white paper with horizontal ruling lines. The lines are evenly spaced and run across the width of the page. There are no margins, text, or other markings on the paper.