

HUNTERS®

HERE TO GET *you* THERE

95 Priest Lane, Ripon, HG4 1LS

£1,200 Per Month

Property Images



HUNTERS®

HERE TO GET *you* THERE

Property Images



Floorplan

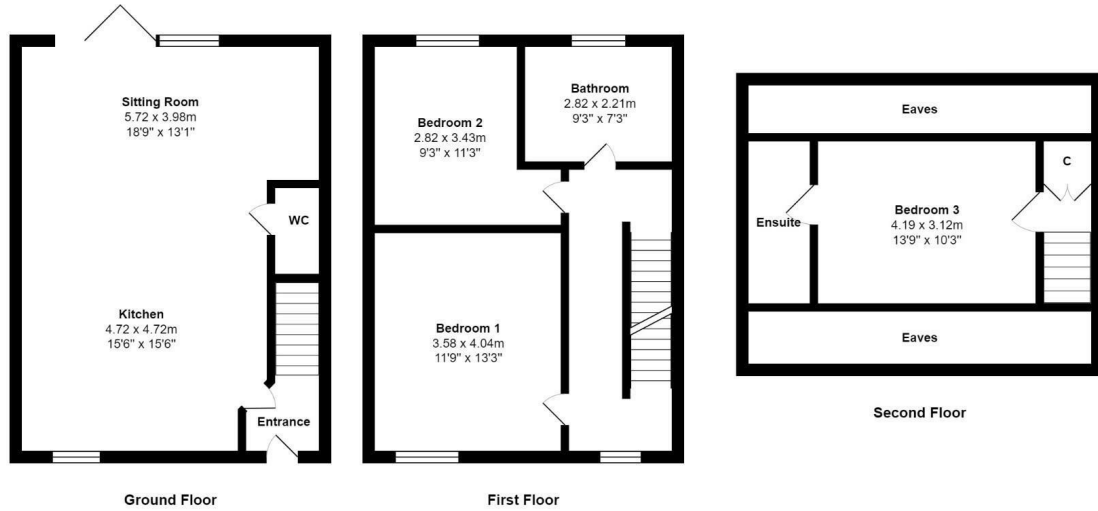

Total Area: 112.4 m² ... 1210 ft²
 All measurements are approximate and for display purposes only

EPC

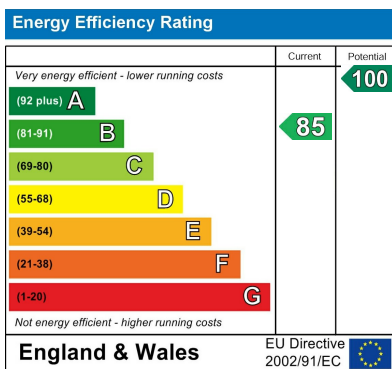

Map



Details

Type: House - Semi-Detached Beds: 3 Bathrooms: 2 Receptions: 1 Tenure:

Summary

Welcome to this exquisite semi-detached residence, a testament to contemporary elegance and modern living. Built in 2020, this stunning property offers an unparalleled blend of style, comfort, and functionality.

Upon entering, you are greeted by an entrance hall, setting the tone for the rest of the home. The ground floor boasts an open-plan layout, where the upgraded living kitchen diner takes centre stage. Designed for both entertaining and everyday living, this area is adorned with built-in appliances, seamlessly combining convenience with sophistication. A convenient downstairs WC adds to the practicality of this level.

Ascending to the first floor, you'll find two generously proportioned double bedrooms, each offering a tranquil retreat. A well-appointed house bathroom awaits, featuring a luxurious bath and a separate shower, ensuring every comfort is met.

Venturing to the second floor, the crowning jewel of this home awaits - the master bedroom. This private sanctuary offers unparalleled comfort and style, accompanied by an en suite shower room, providing a touch of indulgence to your daily routine.

Externally, the property continues to impress, with two parking spaces conveniently located to the front. The rear garden, enclosed for privacy, is predominantly laid to lawn, with a decked patio area offering ample space for outdoor gatherings, relaxation, and recreation.

This impeccable property presents a rare opportunity to experience modern living at its finest. With its enviable location and impeccable design, it promises to be the perfect canvas for creating lasting memories and cherished moments. Arrange a viewing today and prepare to be captivated by the allure of this exceptional home.

Features

• BUILT IN 2020 • THREE DOUBLE BEDROOMS • MASTER EN SUITE • HOUSE BATHROOM • LIVING KITCHEN DINER • DOWNSTAIRS WC • ENCLOSED REAR GARDEN • PARKING FOR TWO CARS • EPC RATING B