



1 Manor Rise, Chiseldon, Swindon, SN4 0FU

**Guide Price £330,000**

**richard james**





## Manor Rise

Chiseldon

Freehold | EPC Rating - C

 3
  2
  1

Richard James are delighted to welcome this three bedroom semi-detached home situated on a picturesque position just off Slipper Lane, in the heart of the village of Chiseldon. Manor Rise is a small modern development of just 11 homes and built by the highly regarded Heritage Building of Swindon.

The property has been much improved and is presented to a very high standard throughout, by the current owners. The accommodation comprises; Hall, Cloakroom, modern fitted Kitchen with integrated appliances and spacious Living Room, with bi-fold doors opening into the well tended and landscaped Rear Garden, with direct access to the off road parking spaces to rear.

With the Three Bedrooms, Ensuite Shower Room to Bedroom One and further Family Bathroom.

Further features include Double Glazing, Gas Radiator Heating and many upgrades undertaken by the owner, which need to be viewed to be appreciated.

Manor Rise sits just moments from the national cycleway (route 45) with a network of footpaths and bridleways linking to The Ridgeway National Trail.

Chiseldon is surrounded by rolling downland that is designated as an Area of Outstanding Natural Beauty and is located just 7 miles North of the market town of Marlborough.

It is only a short drive from J15 of the M4 and the commercial centre of Swindon (railway station serving London Paddington 55 minutes).





The village itself has a thriving community and benefits from two public houses, a brilliant farm shop, complete with cafe and a local post office.





















# Floorplan

Approximate Area = 914 sq ft / 84.9 sq m

For identification only - Not to scale

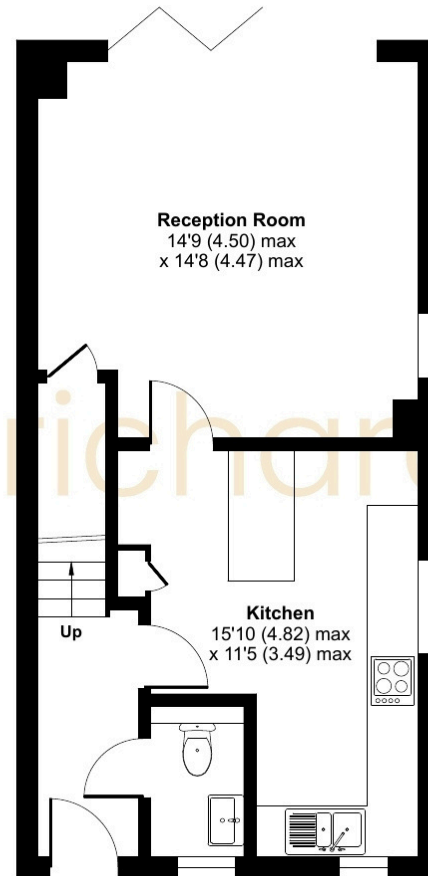

GROUND FLOOR

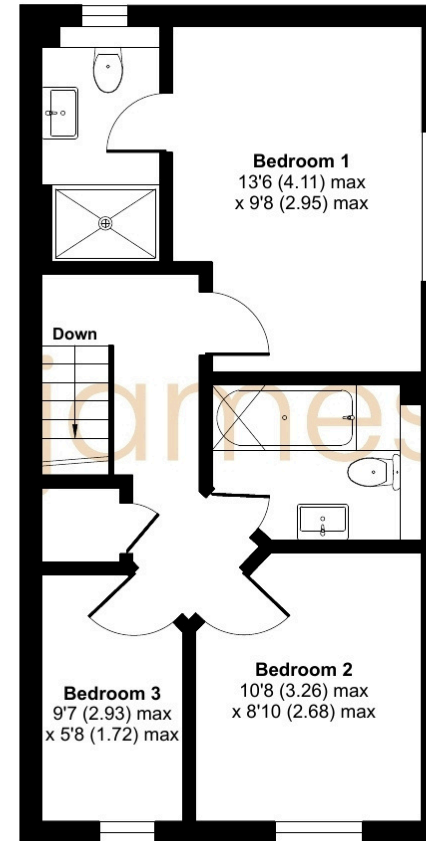

FIRST FLOOR

01793 311 049

jordancobb@richardjames.uk

101 Victoria Road | Swindon | SN1 3BD

richard james

richardjames.uk