



Closome, Turnball, Chiseldon, SN4 0LJ

**Guide Price £480,000**

**richard james**





## Closome

Chiseldon

Freehold | EPC Rating - D

 4
  2
  3

\*\*\*AVAILABLE FOR THE FIRST TIME IN OVER 50 YEARS, SUBSTANTIAL 4 BEDROOM ENSUITE DETACHED FAMILY HOME, QUIET VILLAGE LOCATION, NO ONWARD CHAIN \*\*\*

Situated in a quiet & popular Chiseldon road in the heart of the village, we are pleased to present this deceptively spacious 4 bedroom ensuite family home.

The property benefits from uPVC double glazing, gas radiator central heating, cloakroom, sitting room, dining room, uPVC double glazed conservatory, fitted kitchen, utility room, master bedroom with ensuite, 3 further bedrooms, family bathroom, garage & private gardens.

The property is well located for all local amenities, shops, schools etc & M4 J15.







The property is offered with no onward chain & viewing is highly recommended by the vendor's sole agent.













# Floorplan

Approximate Area = 1681 sq ft / 156.1 sq m (includes garage)

For identification only - Not to scale

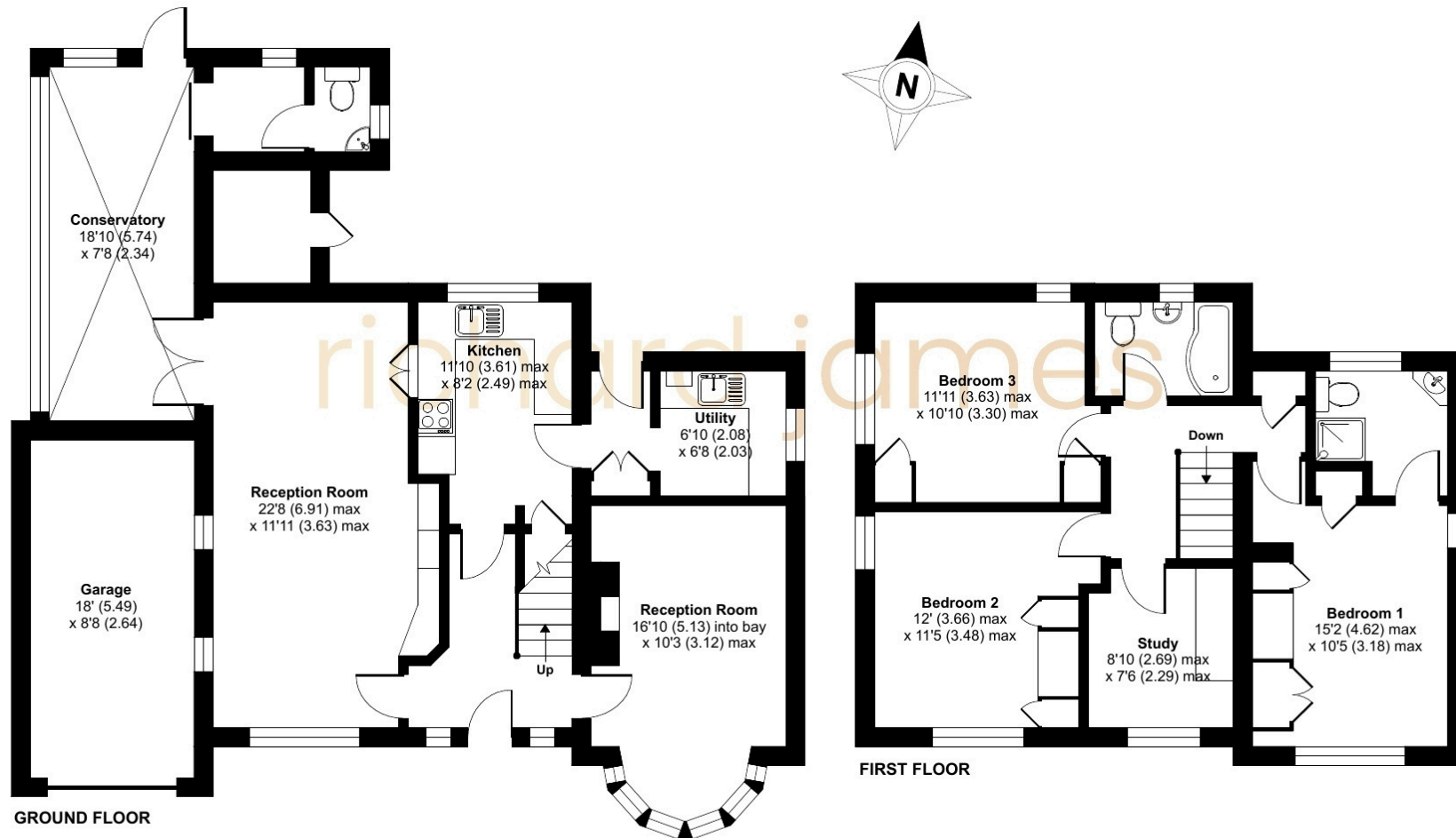

01793 520 720

oldtown@richardjames.uk

101 Victoria Road | Swindon | SN1 3BD

richard james

richardjames.uk