



Naishes Avenue, Peasdown St John

£465,000

- Energy Rating - D
- Beautifully Presented Throughout
- Double Garage & Ample Parking
- Rear & Side Conservatory
- Council Tax Band - E
- Close Commuting Distance To Bath & Close To All Local Amenities
- Enclosed South Facing Rear Garden
- En-Suite & Cloakroom
- Tenure - Freehold
- 3D INTERACTIVE TOUR

BARONS welcome to the market this beautifully presented four bedroom detached family home tucked away on a corner plot in Peasedown St John. Close to local schools, bus routes and amenities. The ground floor accommodation briefly comprises; a bright and airy lounge with feature log burner, a modern kitchen/breakfast room, separate dining room, spacious conservatory, ground floor cloakroom and side conservatory. To the first floor there are; Two good size double bedrooms, one of which has an en-suite, and two further single bedrooms along with a family bathroom. The property further benefits from a double garage, ample off street parking, a well maintained south facing rear garden, gas central heating and UPVc double glazing. Please Call Barons To arrange your viewing on 01761 411411 *****3D INTERACTIVE TOUR AVAILABLE*****

Living Room 18'6" into bay x 11'6" (5.66 into bay x 3.51)

Dining Room 10'1" x 9'7" (3.09 x 2.94)

Conservatory 9'4" x 8'9" (2.86 x 2.67)

Kitchen 13'1" x 11'4" (4 x 3.46)

Side Conservatory 11'7" x 4'9" (3.54 x 1.46)

Cloakroom

Bedroom One 11'10" x 11'5" (3.63 x 3.50)

En-Suite 5'3" x 3'9" (1.61 x 1.15)

Bedroom Two 11'10" x 9'2" (3.63 x 2.80)

Bedroom Three 9'4" x 6'8" (2.86 x 2.04)

Bedroom Four 9'4" x 6'7" (2.86 x 2.01)

Family Bathroom 6'3" x 6'2" (1.92 x 1.90)





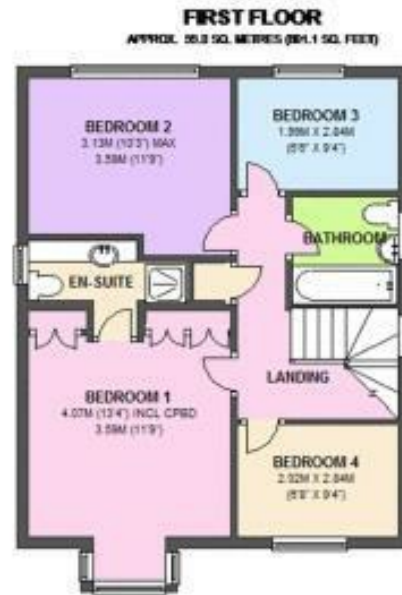

TOTAL AREA: APPROX. 122.8 SQ. METRES (1322.2 SQ. FEET)

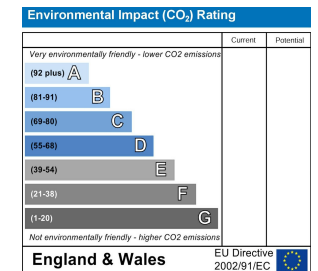
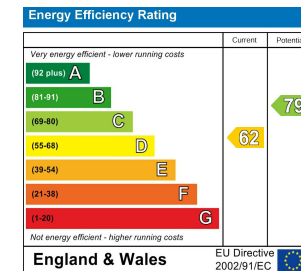
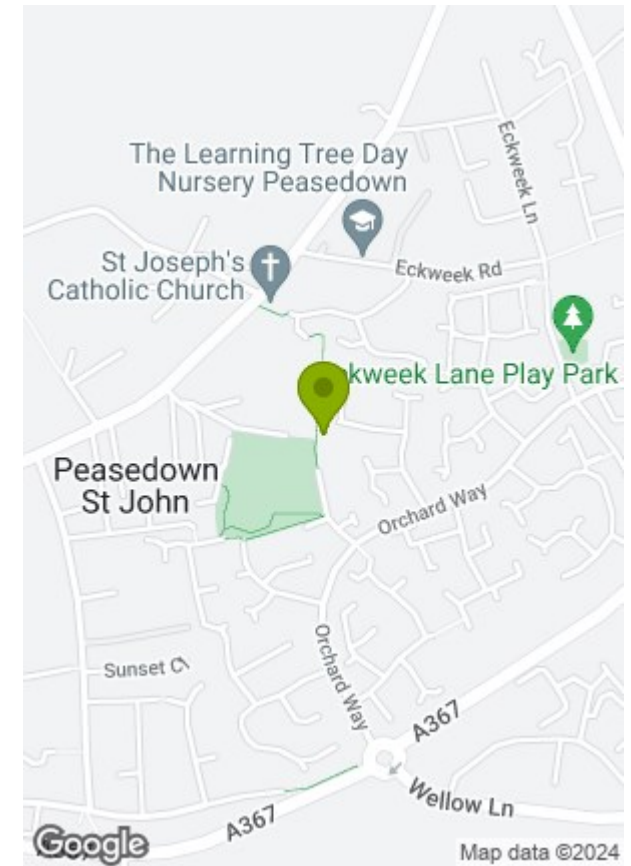

These particulars, whilst believed to be accurate are set out as a general outline only for guidance and do not constitute any part of an offer or contract. Intending purchasers should not rely on them as statements of representation of fact, but must satisfy themselves by inspection or otherwise as to their accuracy. No person in this firm's employment has the authority to make or give any representation or warranty in respect of the property.